

# Summit







## SUMMIT by FOREST RIVER

When you own a Summit Park Model, you've achieved a new level of destination camping. Special amenities pamper you in charming style for a truly enjoyable vacation retreat. Every square inch is engineered to enrich your leisure time with home like comforts and time saving conveniences. A large variety of floor plans, including loft units, offer you the versatility to meet your family's needs and desires.

In the quest for beauty and style, practical necessities have not been ignored. The fully equipped kitchen is furnished with full size appliances, laminated countertops, elegant lighting, and plenty of cabinet and drawer space for storage. In every room, you'll find everything you need for comfortable vacation living.

— S —



## THE GREAT ESCAPE

Ready to get away from it all? We have the perfect place. The Summit. Our living rooms are large and inviting with tons of natural light. Furnished with high quality amenities like a swivel rocker and a pull out sleeper sofa it's not just beautiful it's comfortable. The bedrooms of the Summit are spacious and boast a large mirrored wardrobe with drawers and a built in dresser and vanity.



# FEATURE BENEFITS AND CONSTRUCTION



**Comfort, just the way you like it, to fit your style.**

With 8 different interior fabric options to choose from, along with 4 countertop colors, 2 linoleum options, 3 wood grains and a host of other decisions to make, you will enjoy decorating your unit to fit your personality.



**We encourage you to eat, drink and be merry!**

Whether you are enjoying your favorite meal or playing an exciting game we have the perfect place. Our solid hardwood kitchen table features a drop leaf and four chairs. The chairs also offer lumbar support for additional comfort.



**Residential kitchen features that would make any chef jealous.**

The kitchen of the Summit series comes fully equipped with a 17 cu. ft. 2 door refrigerator, 30" or 24" range and a Spacemaster microwave (where available). The open kitchen concept is great for entertaining.



**Quality and convenience, that is our promise to you.**

Our custom cabinetry uses hidden hinges and will provide you with plenty of storage. All our drawers use metal ball bearing drawer guides that will provide you with years of trouble free service.



**It's the small things that count.**

At Summit attention to detail is a point of pride. Small touches like an optional hidden waste receptacle on a pull out tray is just one of the ways we strive to make life a little easier.



# FOREST RIVER PARK MODELS-BUILT FOR THE TIME OF YOUR LIFE

Quality is built into every park model at Forest River. Forest River's years of park model experience have taught us how to develop a product that is both well built and price competitive. Forest River incorporates production techniques and construction features into each and every quality built park model. You are making an investment, Forest River wants your investment to hold its value, and allow you a worry free leisurely lifestyle. Purchasing from a financially strong company is something you should feel good about. We are a part of Berkshire Hathaway and we are in this for the long haul.

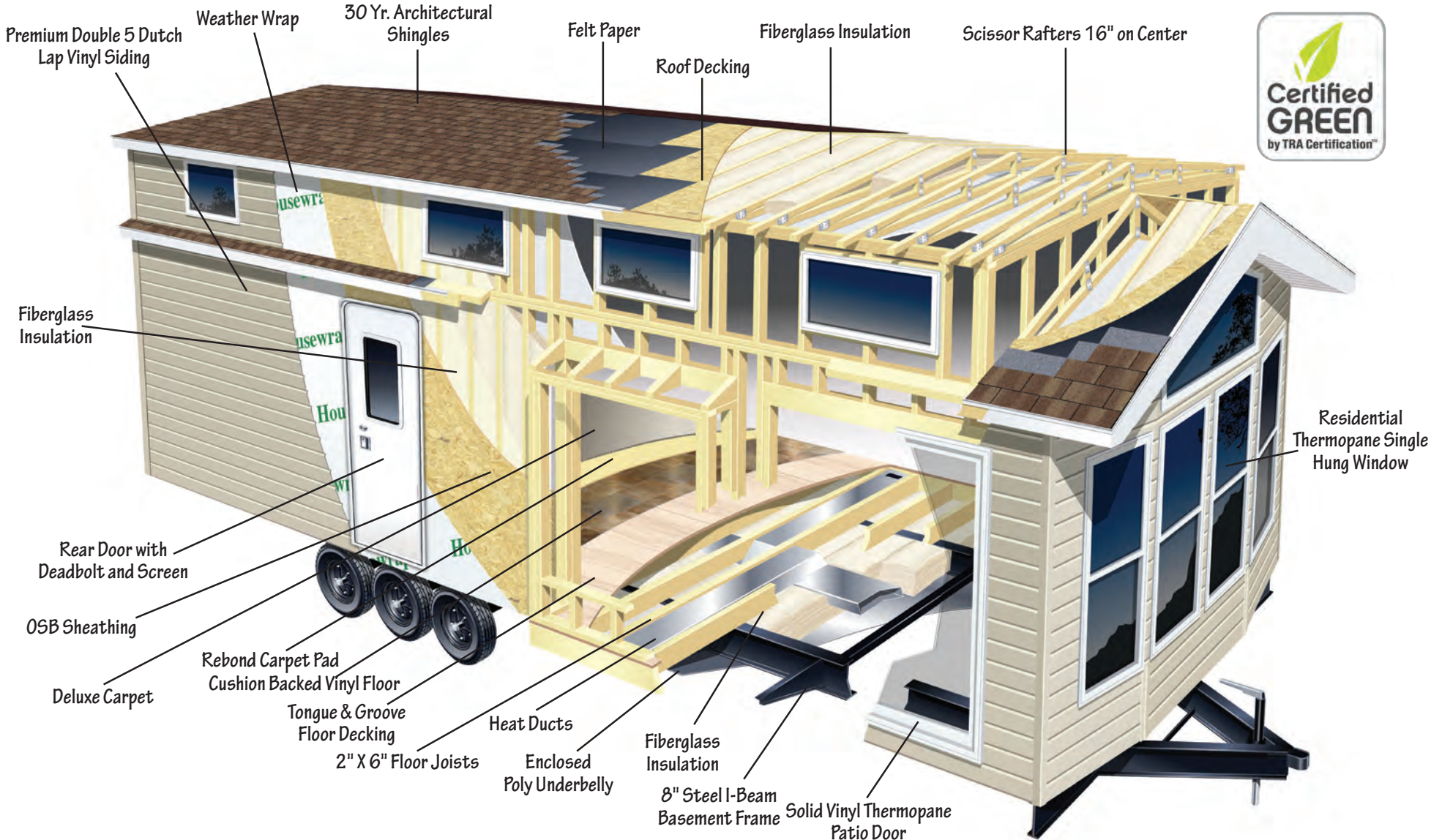

**EXTERIOR FEATURES**

- 8" I Beam Steel Mains - Basement Frame
- Detachable Hitch
- Corrosion Resistant Poly Underbelly
- 2" X 6" Transverse Floor Joist 16" on Center
- Central Floor Heat Duct
- 5/8" Tongue and Groove Plywood Floor Decking
- Roof Decking with Felt Paper
- Asphalt Shingles with 30 Year Warranty
- Permanent 5" Soffit - Sidewalls
- R-11 Fiberglass Insulation with Vapor Barrier
- Truss Rafters
- 2" X 4" Sidewall Studs 16" on Center
- 7' 6" Sidewall Height
- Rear Door with Screen and Deadbolt Lock
- Vinyl Siding with Lifetime Warranty
- OSB Sheathing with Weather Wrap
- 110V Recept at City Water Fill
- Residential Style Shutters\*

**LIVING AREA**

- Sofa Hide-a-Bed and Swivel Rocker
- Stain Resistant Carpet with Pad
- Vertical Blind at Patio Door
- Decorator Valances
- 6 Panel Interior Doors
- Ceiling Fan w/Light Kit (1)
- Large Entertainment Center with TV Jack\*
- Residential Trim (All Windows)
- Decor Coordinated Wall Panels

**KITCHEN/DINING AREA**

- 17 cu. ft. -2 Door Frost Free- White
- 30" or 24" Range - White\*
- Spacemaster® Microwave\*
- Solid Wood Cabinet Doors
- Laminated Counter Top Self-Edged with Back Splash
- Stainless Steel Kitchen Sink
- Drop Leaf Table with 4 Chairs
- Dinette Chairs with Lumbar Support
- "No Wax" Vinyl Floor
- Drawers with Rollers
- GFI Receptacle
- Track Lighting in Kitchen

**BATH AREA**

- 1-Piece Fiberglass Tub/Shower with Shower Curtain
- Residential Style Ceramic Commode
- Power Exhaust Fan with Light
- Custom Hardwood Medicine Cabinet
- GFI Receptacle
- High Pressure Laminated Vanity Top with Back Splash
- Large Sink with Faucet
- Linen Cabinet\*
- Residential Style Bath Accessories

**BEDROOM AREA**

- 60" X 75" Box Spring and Mattress with Metal Frame\*
- Spacious Wardrobes with Drawers Below
- Chest of Drawers\*
- Egress Window
- Mirrored Wardrobe Doors
- Ceiling Fan with Light\*

**ADDITIONAL FEATURES**

- 50 Amp Electrical Service with Power Cord
- 20 Gal. Electric Water Heater with Exterior Door
- 56,000 BTU Furnace Electronic Ignition\*
- Fire Extinguisher
- Exterior GFI Receptacle and Cover
- 2 Exterior Porch Lights
- LP Gas Line
- Touch Control Wall Switches
- Copper Wiring
- Hurricane Tie Downs Straps
- RVIA Seal
- Smoke Detector
- Cove Ceiling Trim
- Seaspray Ceiling Board
- LP Detector\*

**OPTIONAL FEATURES**

- A/C 15,000 BTU Floor Ducted
- Water Heater, 10 Gal. Gas DSI
- Bedspread
- Nightstand and Lamp
- End Table and Lamp
- Metal Underbelly
- Rear Loft\*
- Front Trap Windows
- Dinette Bay
- Dining Room Hutch
- Home Theater System

\* Denotes where available



# HOME CUSTOMIZATION

At Summit we want to make sure you feel completely comfortable in your new home. We know the best way to do this is to allow you to personalize your home to suit your tastes. With 6 interior fabric decors and numerous other options we leave the decorating completely up to you.

## FABRIC OPTIONS

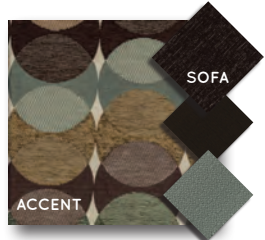

SWEET WATER



SAND DUNE

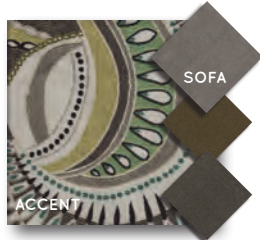

FRESH AIR

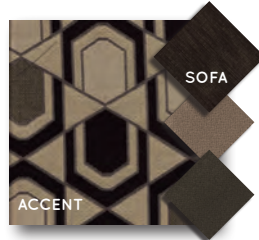

ATHENS STONE



CINNAMON TOAST



AUTUMN MIST

## CABINETS



HARMONY WHITE

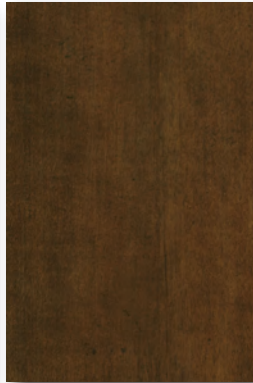

VINTAGE MAPLE

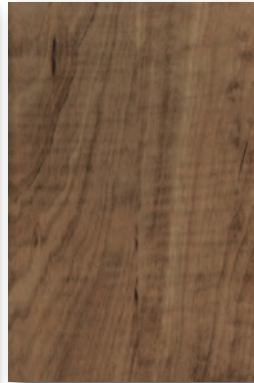

BUTTER RUM

## LINOLEUM



STANDARD

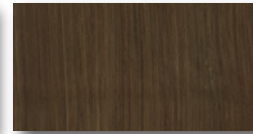

DREAM VINYL OPTION



ASPIN PLANK OPTION



INSPIRE GRAY PLANK OPTION

## COUNTERTOPS



LAPIDUS



ESPRESSO



HYBRID SLATE

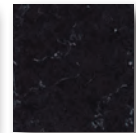

PYRENEES

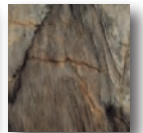

DOLCE VITA OPTION

## WAINSCOTING



HARMONY WHITE BEADBOARD



MANSULU OAK

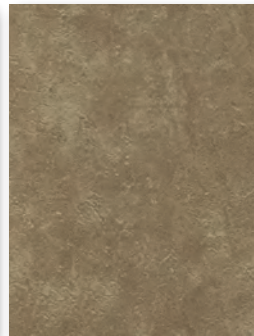

ZEN JAVA GOLD

## WALLBOARD



STANDARD-OPULENCE

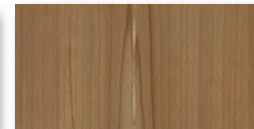

CEDAR PANEL OPTION

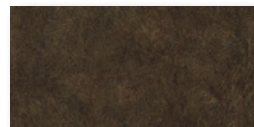

CHESTNUT OPTION

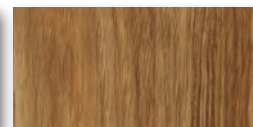

EMBARK HICKORY OPTION



ANGEL SILK OPTION

## CARPET



STANDARD CARPET



APPLE CORE CARPET OPTION

# NON LOFT FLOOR PLANS

### 355FL

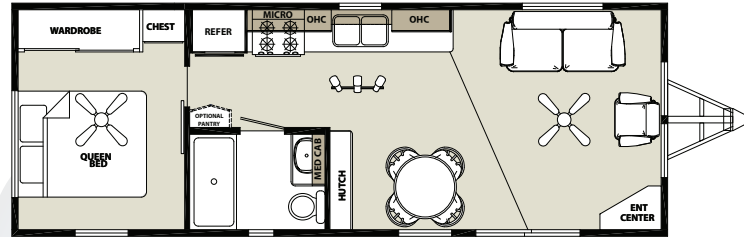

### 40BH

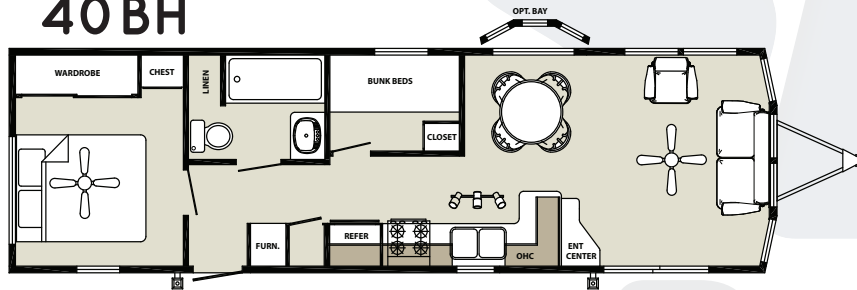

### 40FD

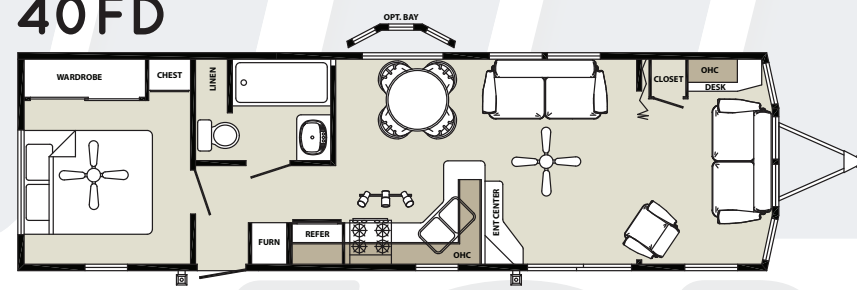

### 40JJ

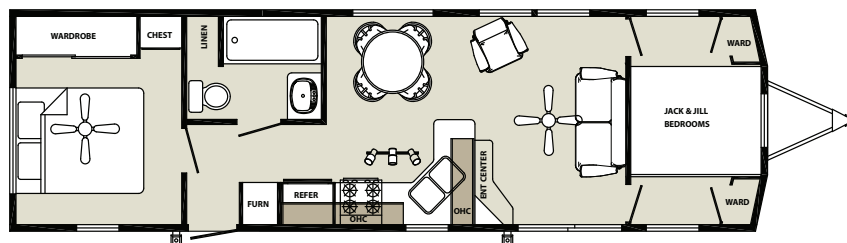

### 40SD

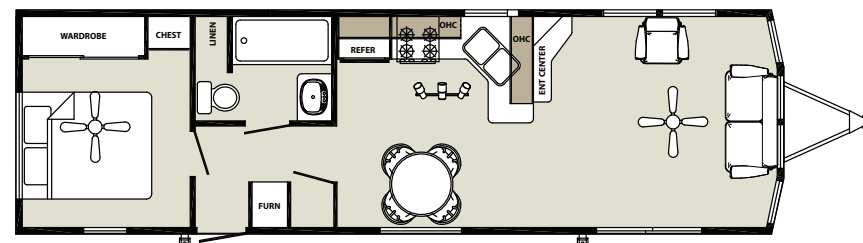

# LOFT FLOOR PLANS

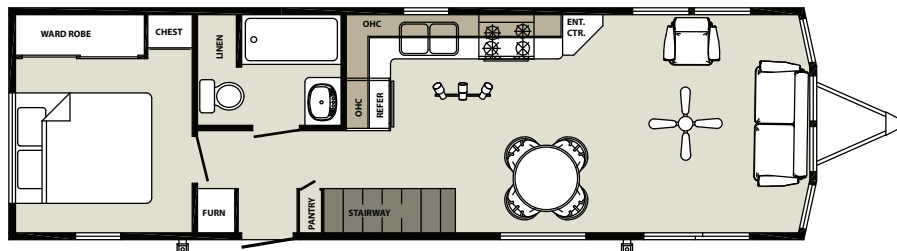
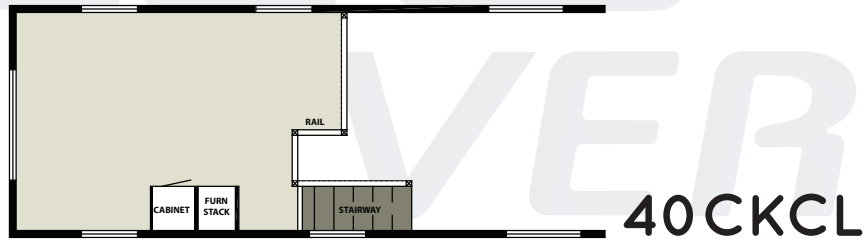
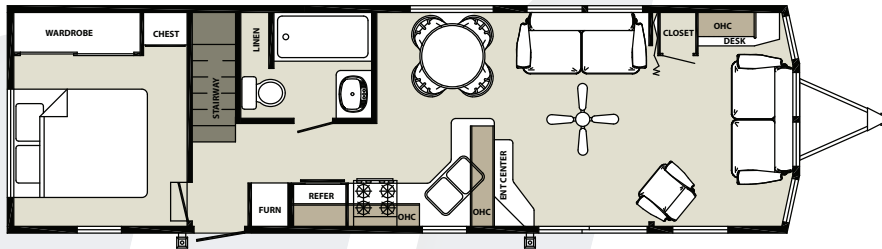
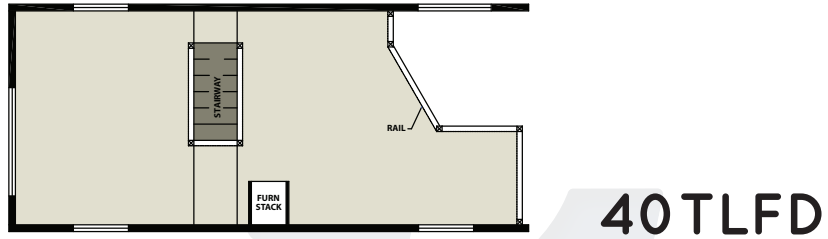



## ***Summit***



Forest River, Inc. Park Model Division  
28936 Phillips St.  
Elkhart, IN 46514  
Phone: (574) 264-7163  
Fax: (574) 264-7364  
[www.forestriverinc.com](http://www.forestriverinc.com)  
[www.forestriveraccessories.com](http://www.forestriveraccessories.com)

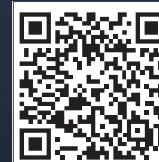

**Learn More**  
Scan this barcode using  
a QR Reader on your  
smart phone to learn  
more about Forest River.



A Berkshire Hathaway company.

© 2016- Summit - a division of Forest River Inc.  
A Berkshire Hathaway company

All information contained in this brochure is believed to be accurate at the time of publication. However, during the model year, it may be necessary to make revisions and Forest River, Inc., reserves the right to make all such changes without notice, including prices, colors, materials, equipment and specifications as well as the addition of new models and the discontinuance of models shown in this brochure. Therefore, please consult with your Forest River dealer and confirm the existence of any materials, design or specifications that are material to your purchase decision.