

Wildcat Maxx

"BUILT IN THE NORTHWEST FOR THE NORTHWEST."

1/2 TON TRAVEL TRAILERS & FIFTH WHEELS



FIND THE HIDDEN ADVENTURE THAT AWAITS YOUR FAMILY – GO WEST WITH WILDCAT MAXX



GROUND CONTROL 3.0® ELECTRIC
AUTO LEVEL SYSTEM

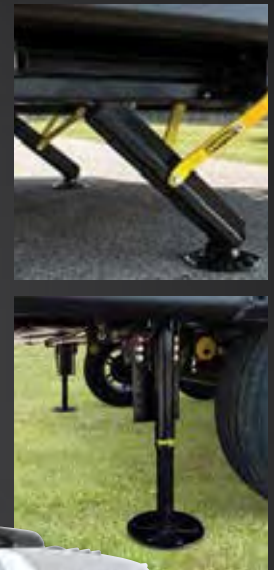

T28RKX SHOWN IN COBBLESTONE WITH OPTIONAL TREKK WOOD PLANK FLOORING & GARDEN ROOM WINDOWS

	T26FBS	T28RKX	T29RLX	T30DBH	T32BHXS	T32TSX
GVWR (LB.)	10,898	11,144	11,316	11,198	11,122	11,555
HITCH WEIGHT (LB.)	698	944	1,116	998	962	1,355
UVW (LB.)	6,837	7,751	8,473	7,761	8,571	9,150
CGC (LB.)	4,061	3,393	2,843	3,437	2,551	2,405
EXTERIOR LENGTH	29' 11"	33' 3"	34' 3"	35' 1"	36' 10"	37' 8"
EXTERIOR HEIGHT	11' 4"	11' 4"	11' 4"	11' 4"	11' 4"	11' 4"
EXTERIOR WIDTH	96"	96"	96"	96"	96"	96"
FRESH WATER (GAL.)	67	67	67	67	67	67
GRAY WATER (GAL.)	62	64	62	70	85	108
BLACK WATER (GAL.)	31	32	31	31	54	54
AWNING SIZE	18'	18'	20'	18'	16'	13'

FEATURES INCLUDE:

- Solar prep
- Large LCD HDTV
- Back-up camera prep
- Complete interior & exterior LED lighting
- Bluetooth stereo
- 60"x80" Parklane Queen Euro-Top Mattress – Choose to Sleep Better
- Battery disconnect
- Electric Awning with LED Patio Strip Lighting
- Maxx coat rack
- Stainless steel appearance appliances
- Push button remote with holster
- Aluminum framed & vacuum bonded construction
- Maxx Insulation Package
- USB charging stations
- Ground Control 3.0® Electric Auto Level System
- Electric tongue jack
- Radius crowned interior ceiling
- Large single bowl stainless steel sink w/ high-rise faucet
- Friction hinge door
- SolidStep main entry steps
- Slam latch baggage doors

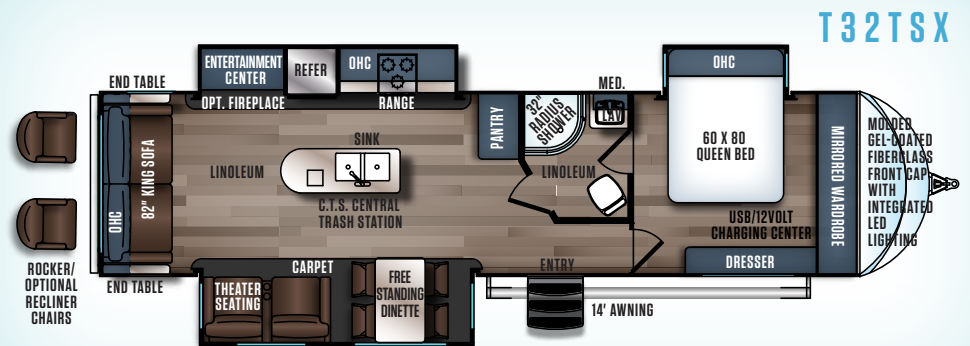
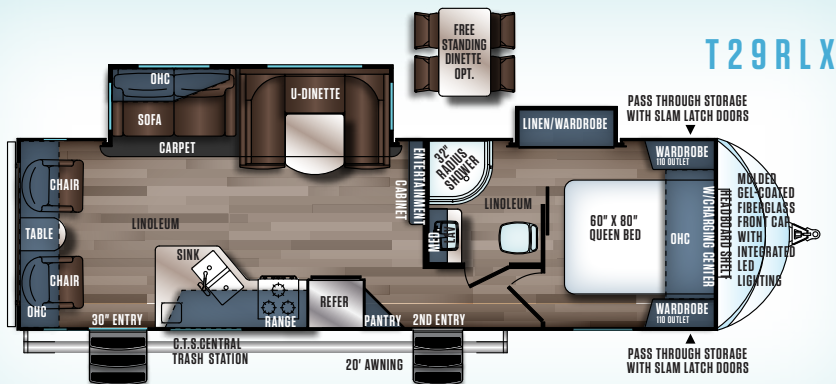
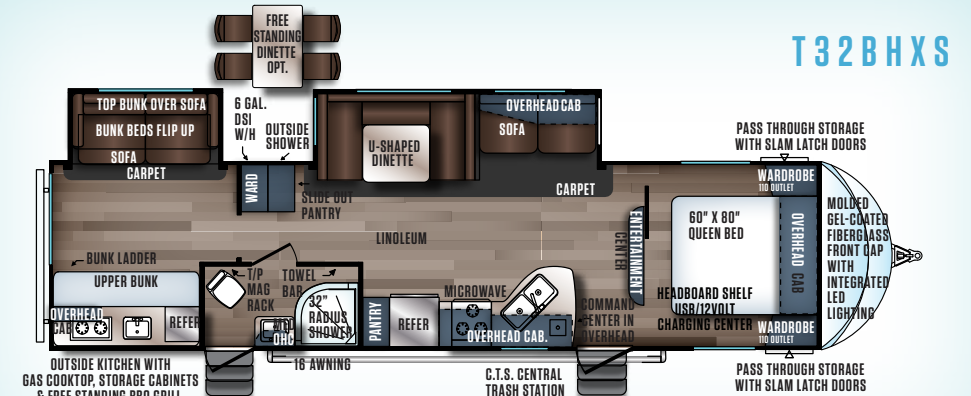
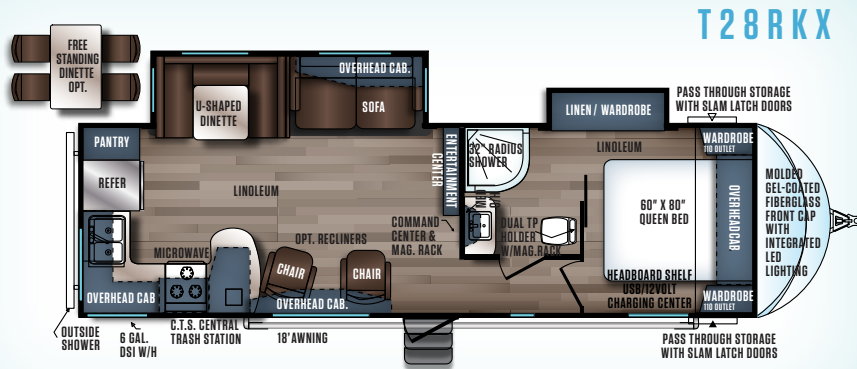
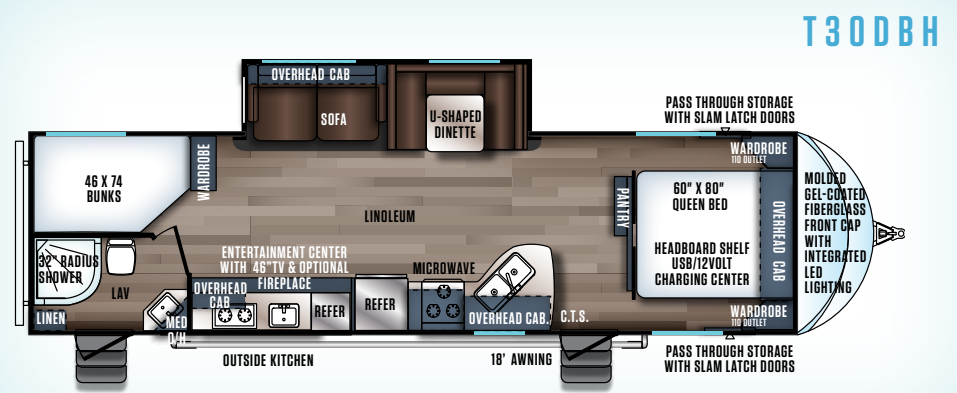
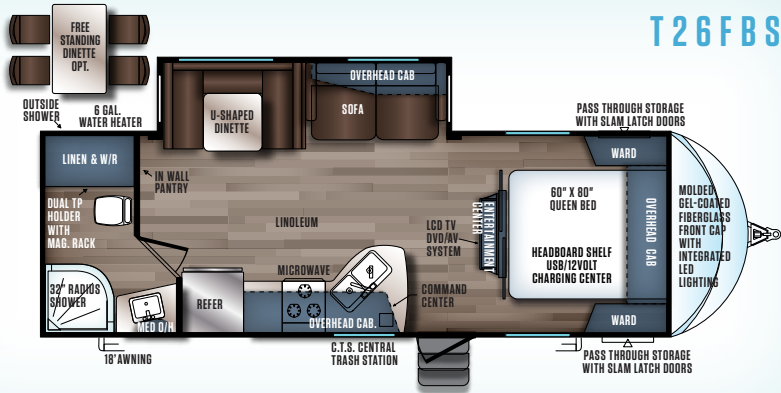



1/2 TON FIFTH WHEELS



F250RDX shown in Mocha Interior & Optional Wood Plank Flooring

Wildcat Maxx isn't just a brand name, it's a choice. You've made a choice to RV to The Maxx and we've also made a decision to build to The Maxx. The Maxx insulation you can squeeze into an RV. The Maxx counter space for food prep. The Maxx storage for your gear. The Maxx comfort for you to enjoy your RV Lifestyle to The Maxx. Every Wildcat Maxx comes with all of this and more.

ALL WILDCAT MAXX FIFTH WHEELS INCLUDE THE MAXX CONVENIENCE PACKAGE:

- Fantastic Fan
- Stainless Steel Appearance Appliances
- 8' Cubic Refer
- Seamless Countertop w/Under mount Sink & High-rise Pull-Out Faucet
- Drop-in Cooktop w/Glass Cover
- Sink Cover
- Paper Towel Holder
- Dual Toilet Paper Holder
- Central Trash System (C.T.S.)
- USB Charging Port Package
- Coat Rack
- Black Tank Flush
- Battery Disconnect

	F250RDX	F252RLX	F262R6X	F272RLX	F285RXX	F295RSX	F312BHX
GVWR (LB.)	11,706	11,704	11,860	11,590	11,902	11,833	11,960
HITCH WEIGHT (LB.)	1,506	1,504	1,660	1,430	1,702	1,633	1,760
UVW (LB.)	8,443	8,431	8,847	8,533	9,071	9,462	9,355
CGC (LB.)	3,263	3,273	3,013	3,057	2,831	2,371	2,605
EXTERIOR LENGTH	32' 1"	32' 1"	31' 7"	30' 1"	32' 1"	33' 6"	35' 7"
EXTERIOR HEIGHT	12' 10"	12' 10"	12' 7"	12' 10"	12' 10"	12' 10"	12' 10"
EXTERIOR WIDTH	96"	96"	96"	96"	96"	96"	96"
FRESH WATER (GAL.)	87	87	87	87	87	87	87
GRAY WATER (GAL.)	54	54	108	108	85	91	108
BLACK WATER (GAL.)	54	54	54	54	54	54	54
AWNING SIZE	18'	18'	17'	18'	18'	13'	17'

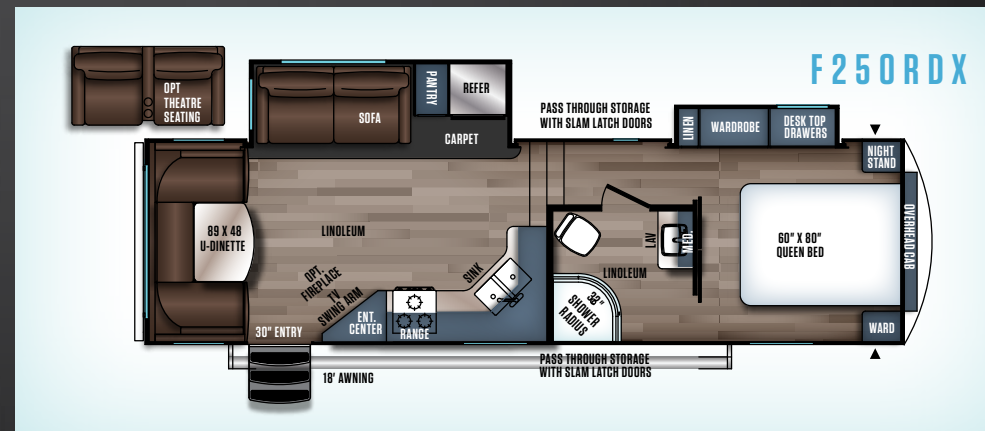

F252RLX

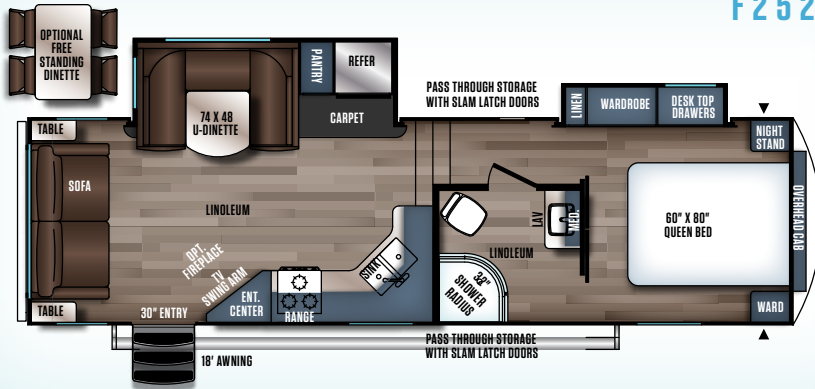

F262RGX

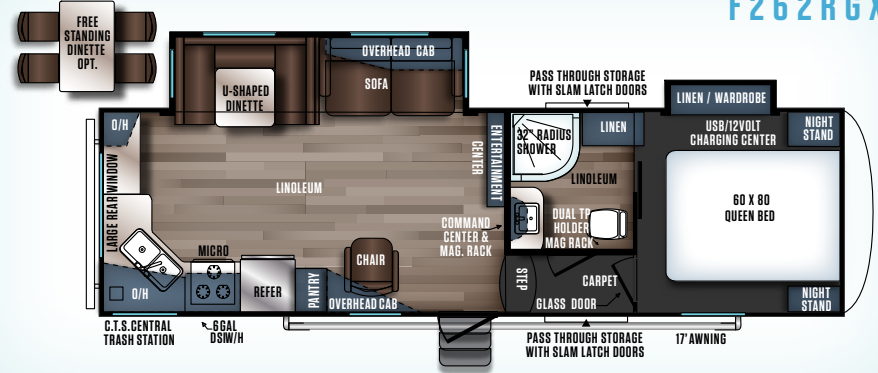

F272RLX

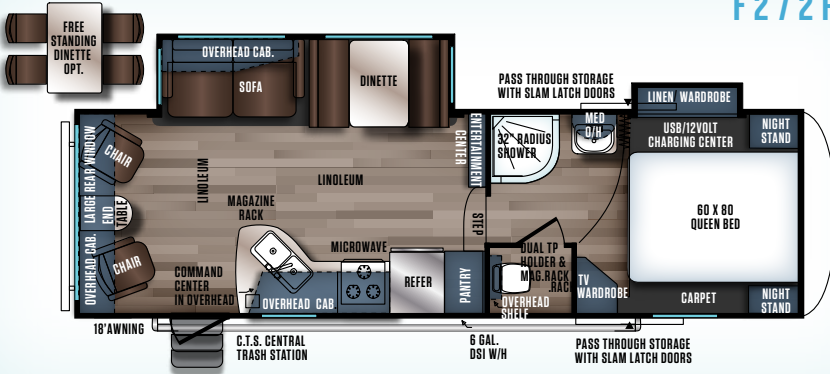

F285RKX

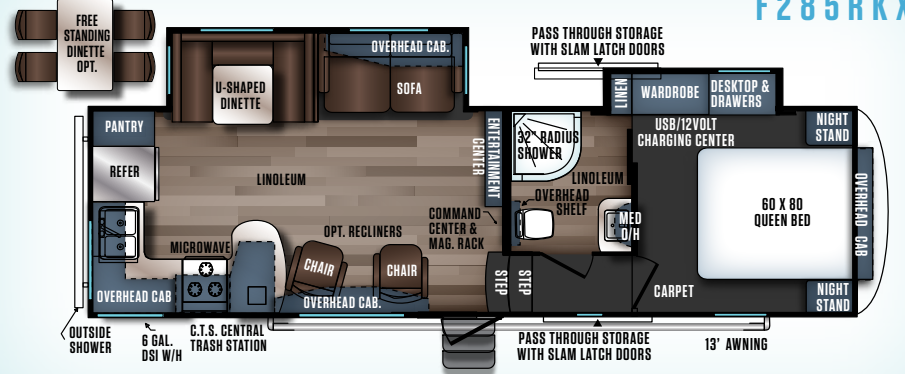

F295RSX

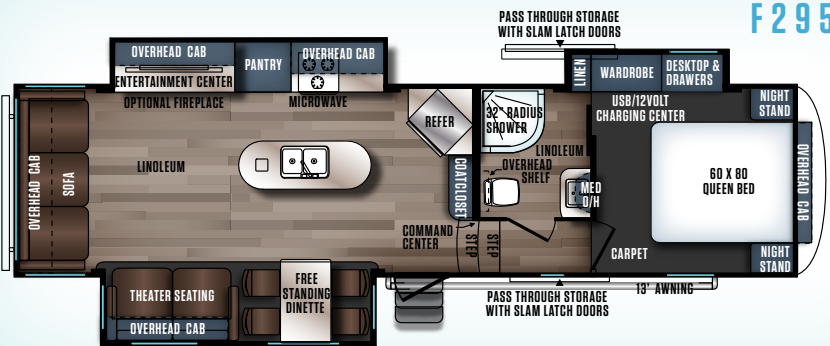

F312BHX

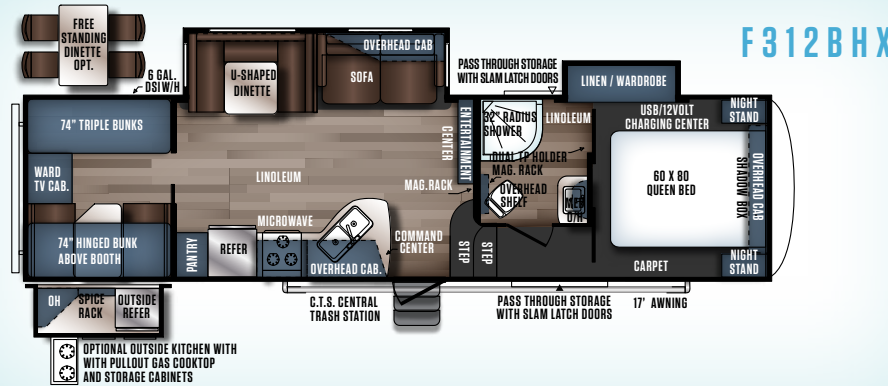

Wildcat
Maxx LITE



The Wildcat Maxx Lite is constructed with the same 2" vacuum bonded sidewalls as our standard travel trailers and 5th wheels. We didn't cheapen our build like most of our competition that uses 1" walls and less materials to achieve "light weight." You don't have to feel like you are getting a "cheaper build," to get a lighter weight travel trailer.

The Wildcat Maxx Lite consists of shorter models. We use the same real Hardwood Cabinet doors with residential Hidden Hinges. We use the same Furniture, the same MAXX-Bright LED interior and exterior lighting, the same Trekk Residential Flooring completely glued to our 1-Piece Dynaspan floor decking, the same 60" x 80" Residential Mattress, and the same Maxx Insulation Package.



	T245R6X	T255RLX	T265BHx
GVWR (LB.)	7,764	7,613	7,832
HITCH WEIGHT (LB.)	764	613	832
UVW (LB.)	6,168	5,993	6,490
CCC (LB.)	1,596	1,620	1,342
EXTERIOR LENGTH	29' 4"	29' 5"	31' 8"
EXTERIOR HEIGHT	11"	11"	11"
EXTERIOR WIDTH	96"	96"	96"
FRESH WATER (GAL.)	67	67	67
GRAY WATER (GAL.)	64	32	74
BLACK WATER (GAL.)	32	32	32
AWNING SIZE	19'	18'	16'

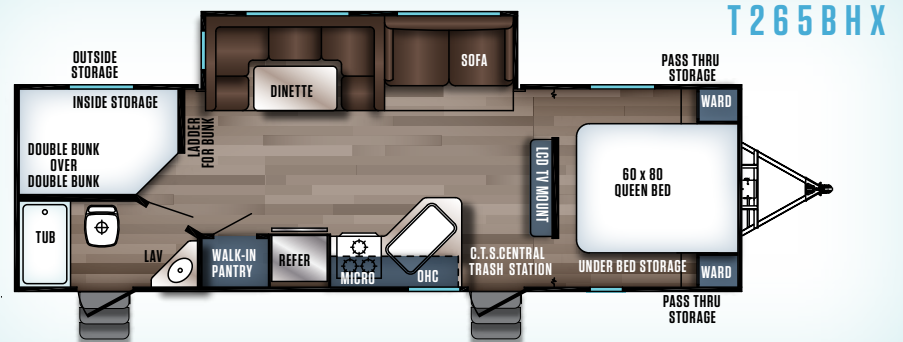
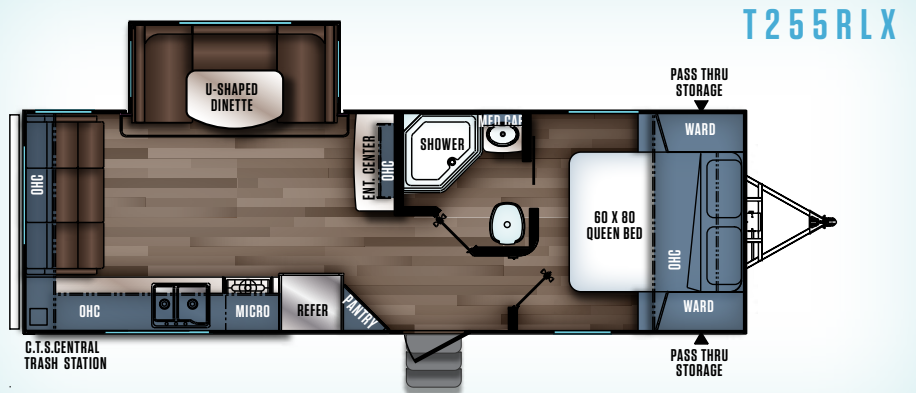
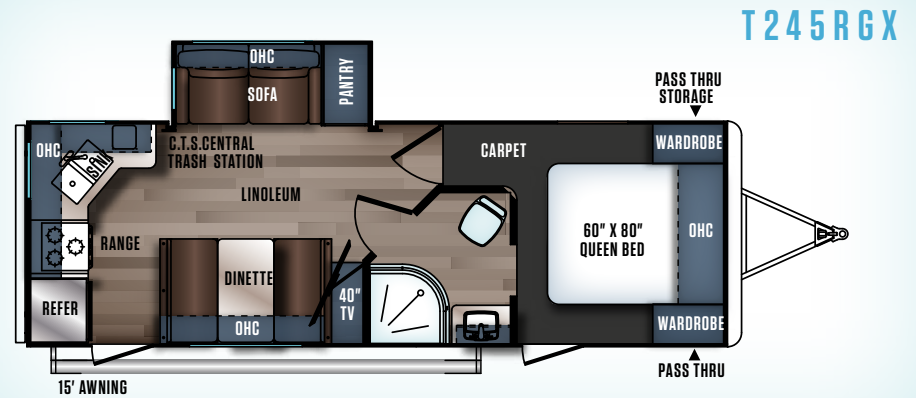

Wildcat Maxx

POPULAR FEATURES



SolidStep



Large stainless single bowl sink



60"x80" True Queen Pillow-top mattress with large wardrobe slide



Optional garden room windows

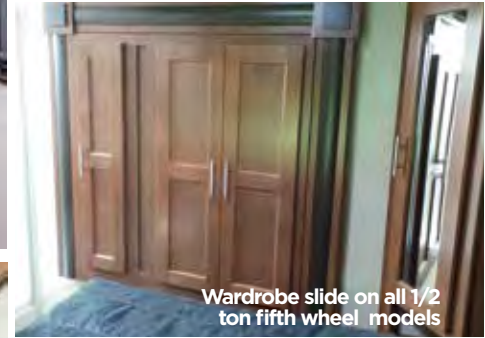

Wardrobe slide on all 1/2 ton fifth wheel models



Island kitchen with stainless steel range hood



Large radius shower



Large HDTVs in every entertainment center (Optional fireplace shown)

Wildcat Maxx

FEATURES & AVAILABLE OPTIONS

LOOK AT ALL THESE GREAT ADD-ONS FOR YOUR PURCHASE

STANDARD

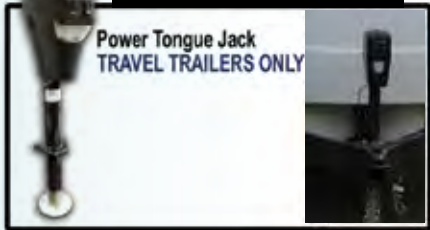

Power Tongue Jack
TRAVEL TRAILERS ONLY



AM/FM/CD/DVD/HDMI/BLUETOOTH STEREO



Stainless Appliances
HIGH END STAINLESS APPLIANCES



OUTSIDE SHOWER SYSTEM



LIPPERT ANALOG REMOTE

LCI GROUND CONTROL® 3.0
With the push of a button, Ground Control® 3.0 levels and stabilizes your RV quickly and accurately, enhancing your overall camping experience. It can take up to an hour to get an RV level with manual jacks, chocks and wedges. Ground Control saves you time by leveling and stabilizing the RV in a matter of minutes, and prevents annoying rocking and swaying at the campsite."



Awning LED Lights
EXTERIOR
MAXX-BRIGHT LED
AWING STRIP
LIGHTING



Sanitation Maintenance
BLACK TANK FLUSH



1" Thick, Insulated
Slam-Latch Baggage
Doors On
Extra-large Exterior
Storage



MAXX COAT RACK



Battery Disconnect



LED Lights
MAXX BRIGHT COMPLETE COACH
LED LIGHT PACKAGE

parklane
MATTRESSES



PARKLANE QUEEN EURO-TOP MATTRESS –
CHOOSE TO SLEEP BETTER



STANDARD SLEEPER SOFA



OPTIONAL



BACK-UP CAMERA PREP STANDARD –
Camera System Optional



OPTIONAL GARDEN ROOM

SOLAR PREP: STANDARD
(Optional 200w Solar
Panels available up
to 400w)

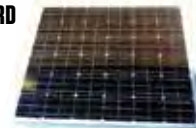

"Maxx Travel Rack"
250 lb Load Capacity

Wildcat Maxx

STANDARD & OPTIONAL FEATURES

LIVING ROOM

- Extra large booth dinette with storage under & dual pedestal table
- Tri-fold sofa / hide-a-bed sleeper sofa
- Large panoramic picture window at all dinettes
- Overhead cabinets in slide room (Dinner plate depth)
- Pleated night shades
- AM/FM/CD/DVD/USB/AV system with remote and bluetooth technology
- RCA plugs for game systems or digital cameras
- Taller 6' high slide out height (1/2 ton fifth wheels)
- Satellite & cable TV hookups
- 12v LED decorative lighting in slide-outs
- High back, extra large swivel rocking chairs (select models)
- Slider windows at ends of slide-outs
- Maxx bright complete interior LED lighting
- Residential carpeting with stain guard
- Magazine rack
- Command center with monitor panel
- Surround sound speakers
- Wall clock

EXECUTIVE KITCHEN

- Residential shaker-style hardwood cabinet doors
- Residential hidden hinges
- Brushed nickel finish door and drawer hardware
- Stainless appliances
- Residential fully-extension steel ball-bearing drawer guides
- Storage above refrigerator (most models)
- Upgraded microwave oven
- Brushed nickel pull-out residential style metal high rise faucet
- 8 cu. ft. refrigerator
- Extra large under-mount single bowl stainless steel kitchen sink with sink cover
- Deep storage overhead kitchen cabinets
- Extra large pots and pans draws (most models)
- Toe kicks in kitchen cabinet base
- Glued down residential Trekk® linoleum

- 22" oven and 3-burner range with core ad built in knife rack
- Residential style range vent with light and fan
- Paper towel rack
- Cutlery drawer
- Residential kitchen backsplash
- Cutting board
- C.T.S. (Central Trash System) (most models)

BATHROOM

- Porcelain toilet with foot pedal flush
- Built in wood medicine cabinet
- GFI receipts in bathroom
- Skylight in shower
- Power vent fan
- Built-in wood dual toilet paper holder with magazine rack
- Dual towel racks
- Radius glass shower doors

BEDROOM

- Pillow-top residential queen bed
- Full stand-up height in all bedrooms
- Flat floor bedrooms in all fifth wheels (No more steps on side of bed)
- Gas struts to lift bed for under-bed storage
- Fully finished bed bases
- Complete Led lights including reading lights
- Upgraded residential queen-sized bedspread and headboard
- Bedroom roof vent



Pebble

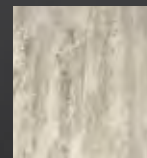

Trekk Vinyl Tile Flooring



Cappuccino



Trekk Vinyl Woodgrain Flooring



Cobblestone

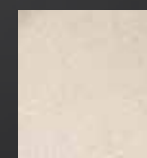

Solid Surface Countertop Option



Mocha

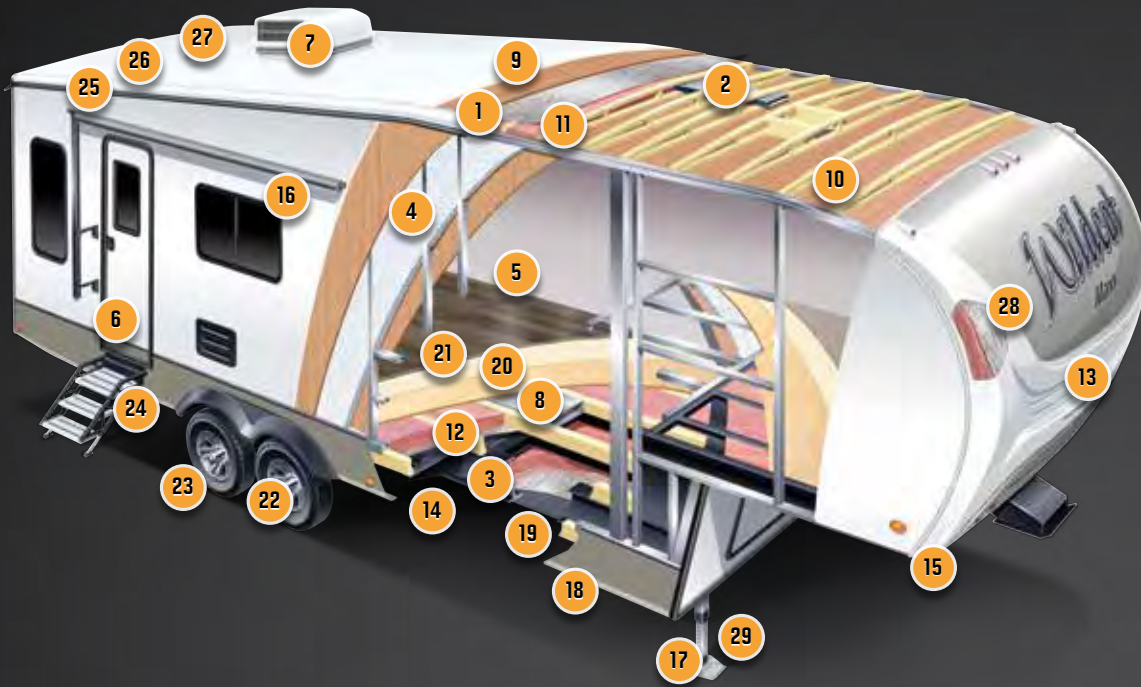

CONSTRUCTION

1. 3/8" Roof Decking
2. Insulated A/C Duct work
3. Heavy Duty Steel I-Beam Chassis
4. High Density R10 Block Foam Insulation in Walls
5. Vinyl Covered Interior Decorative Wall Board
6. 30" Radius Entry Door
7. 13.5k BTU Air Conditioner
8. 5/8" DynaSpan® Seamless Floor Decking
9. One Piece Dacor DiFlex II, Non-Fleece Backed TPO Roofing System
10. 5" Engineered and Fabricated Roof Rafters 16" on Center
11. 2 Layers of R-7 Fiberglass Insulation in Roof & End Walls plus Reflective Astrofoil insulation
12. R-7 Fiberglass in Floor Plus Reflective Astrofoil Insulation
13. Aerodynamic Gel-coated Fiberglass Front Cap
14. ALL SEASON 12v Heating Pads On All Tanks
15. Optimized Turning Radius For Today's Short Bed Trucks
16. 2" Thick ALUMACAT Vacuum-Bonded Gel-coated Fiberglass Laminated Sidewalls
17. Spring-Loaded Quick Release Jack Pins on Landing Gear Legs
18. Radius-Wrap Aluminum Skirt Metal
19. Fully enclosed underbelly with R-7 fiberglass insulation plus Astro-foil insulation under each holding tank
20. Premium Carpet Padding
21. Synthetic Residential Carpeting with Stain Guard
22. 15" Load Range 'E' Radial Tires (Standard) or Optional 16" Load Range 'E' Radial Tires
23. E-Z Lube Axles
24. Molded Fender Skirt
25. Pre-Wired for Back-up Camera
26. Vented Attic
27. Pre-wired for solar power
28. 2 Layers of R-7+ Astrofoil behind cap.
29. Ground Control 3.0 Self-Leveling System



CLIMATECH® COLD WEATHER ALL SEASONS INSULATION PACKAGE

- Underbelly has reflective astro-foil insulation + R-7 fiberglass under each holding tank. Also included is a 12-volt tank heater for each of the holding tanks
- The floor has a reflective astro-foil insulation + R-7 fiberglass insulation
- The ceiling, front wall and rear wall have a reflective astro-foil insulation + two layers of R-7 fiberglass insulation
- The side walls, three sides of the slide-out, the raised upper deck of all fifth wheels and all raised bunk beds are vacuum-bonded, aluminum construction with R-10 high-density block foam insulation
- The slide-out floor also has a layer of reflective astro-foil insulation on top of 1.25" plywood decking
- On all fifth wheels, the outside storage compartments have an actual heat duct blowing hot air from the furnace directly into the storage compartment
- Every Wildcat Maxx comes with a vented attic to allow moisture to escape in the winter and heat to escape in the summer
- Every Wildcat Maxx comes standard with a 35,000 BTU furnace (30,000 BTU on Maxx Lite)

(It is important to remember that astro-foil insulation has a calculated "R" value of 38 at an ambient temperature of 80 degrees Fahrenheit.)



HEAVY-DUTY ALUMINUM FRAMING

We use heavier tubing than most of our competition. Our vacuum-bonded, 2" side walls are fully insulated with R-10 Block Foam insulation and each opening is 100% framed on all 4 sides with welded aluminum



DOUBLE INSULATED CEILING WITH REFLECTIVE FOIL, STANDARD

Our products are designed with the latest insulation products and are engineered to withstand extreme environments. Insulation and reflective foil is added above the protective water barriers on the bottom of each unit. We also add vented areas in the ductwork to heat the underbelly of each unit.



ASTRO-FOIL INSULATION IN CEILING, FLOOR, UNDERBELLY AND SLIDE OUT FLOOR

Spaced Age Astro-Foil Insulation™ Our system has a calculated reflective R-Value of 38 at an ambient temperature of 80° Fahrenheit and can double your heating and cooling efficiencies.



PRE-DELIVERY INSPECTION FACILITY

20,000 square feet of quality assurance. The bare essentials for a premium product. This state-of-the-art facility gives immediate daily feedback to production for quality assurance in every unit built.



Wildcat Maxx



CUSTOMER SATISFACTION



www.ForestRiverBuyLocal.com

24/7 EMERGENCY ROADSIDE ASSISTANCE

For a worry-free ownership experience

Forest River includes one

year of Coach-Net RV Technical & Roadside Assistance with each RV purchase. Whether new to the RV lifestyle or an experienced RV enthusiast, Forest River owners have 24/7 access to technical, operational and emergency road service coverage throughout the US & Canada.

Coach-Net's fast, dependable service is just a phone call away.

Coach-Net[®]
RV Technical & Roadside Assistance

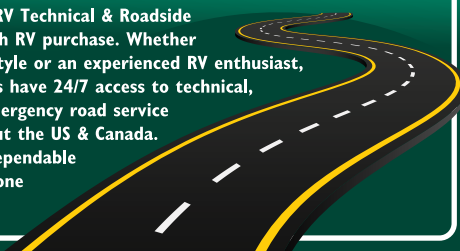

Learn More
Scan this barcode using a QR Reader on your smart phone to learn more about Forest River.



A Berkshire Hathaway company.

1429 SE UGLOW AVE, DALLAS, OREGON 97338
WWW.FORESTRIVERINC.COM/WILDCATMAXX
(503) 831-1200

Specification Definitions

GVWR (Gross Vehicle Weight Rating) - is the maximum permissible weight of the unit when fully loaded. It includes all weights, inclusive of all fluids, cargo, optional equipment and accessories. For safety and product performance do NOT exceed the GVWR.

GAWR (Gross Axle Weight Rating) - is the maximum permissible weight, including cargo, fluids, optional equipment and accessories that can be safely supported by a combination of all axles.

UVW (Unloaded Vehicle Weight)* - is the typical weight of the unit as manufactured at the factory. It includes all weight at the unit's axle(s) and tongue or pin and LP Gas. The UVW does not include cargo, fresh potable water, additional optional equipment or dealer installed accessories.

*Estimated average based on standard build optional equipment.

CCC (Cargo Carrying Capacity)** - is the amount of weight available for fresh potable water, cargo, additional optional equipment and accessories. CCC is equal to GVWR minus UVW. Available CCC should accommodate fresh potable water (8.3 perlon). Before filling the fresh water tank, empty the black and gray tanks to provide for more cargo capacity.

** Estimated average based on standard build optional equipment

Each Forest River RV is weighed at the manufacturing facility prior to shipping. A label identifying the unloaded vehicle weight of the actual unit and the cargo carrying capacity is applied to every Forest River RV prior to leaving our facilities.

The load capacity of your unit is designated by weight, not by volume, so you cannot necessarily use all available space when loading your unit.

All information contained in this brochure is believed to be accurate at the time of publication. However, during the model year, it may be necessary to make revisions and Forest River, Inc., reserves the right to make all such changes without notice, including prices, colors, materials, equipment and specifications as well as the addition of new models and the discontinuance of models shown in this brochure. Therefore, please consult with your Forest River dealer and confirm the existence of any materials, design or specifications that are material to your purchase decision. Litho. U.S.A P / W: 2018.01.22