

# SALEM

BY FOREST RIVER

SALEM & CRUISE LITE



Extra Large Cabinets  
with Base Shelf and  
Frosted Glass Inserts

Mushroom Style  
LED Interior Lights

Stainless Steel  
Appliance Package

Recessed Stove  
with Glass Cover

"High Definition"  
Countertops

# INTERIOR FEATURES

SOME FEATURES SHOWN HAVE LIMITED AVAILABILITY



SHOWN IN OYSTER

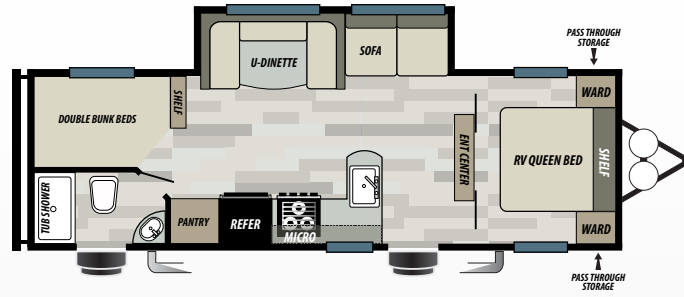

263BHXL

Modern Roller Shades  
in Living Areas

Double-Stitched  
pillow Back Jiffy Sofa

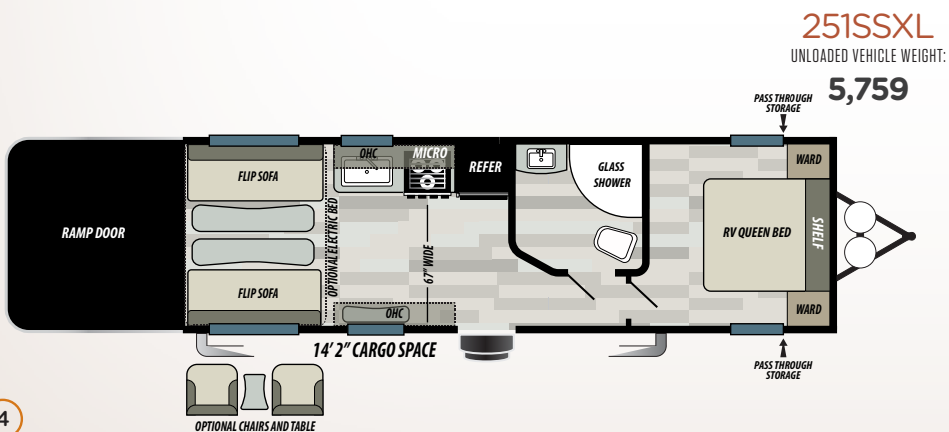
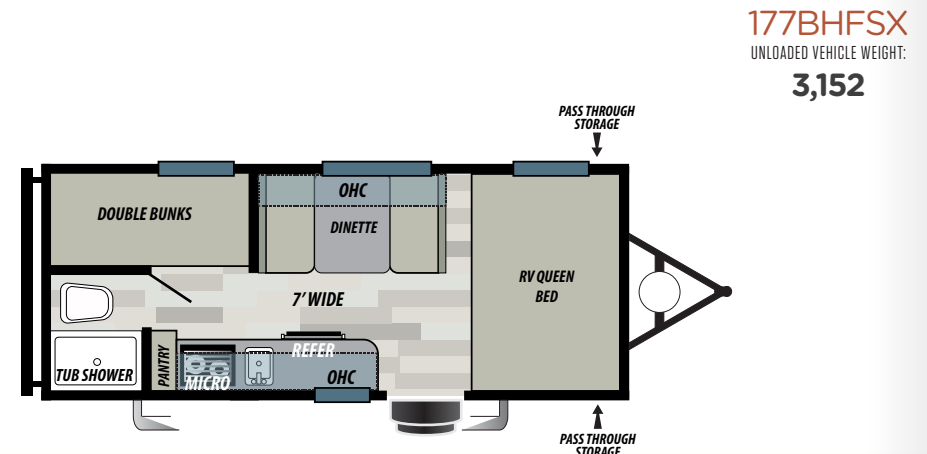
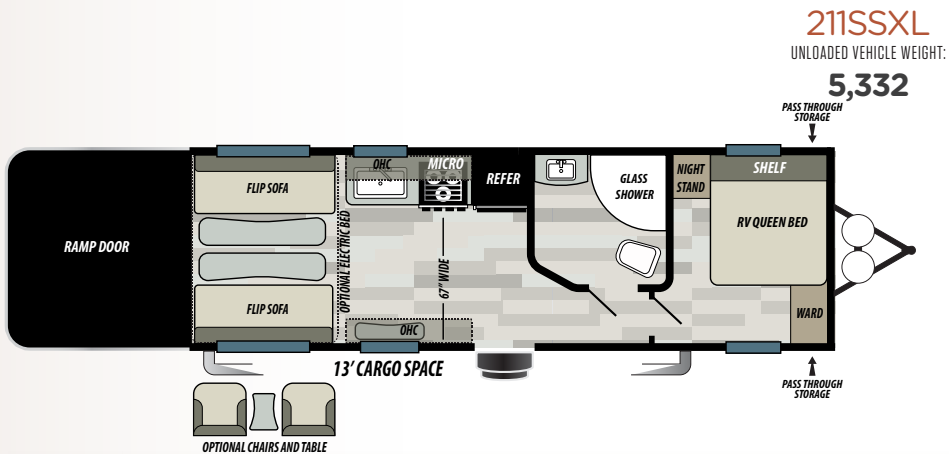
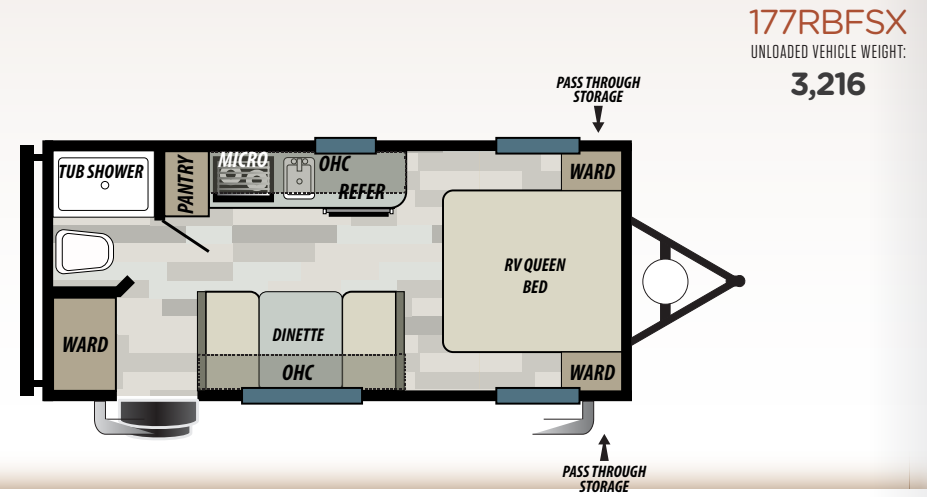
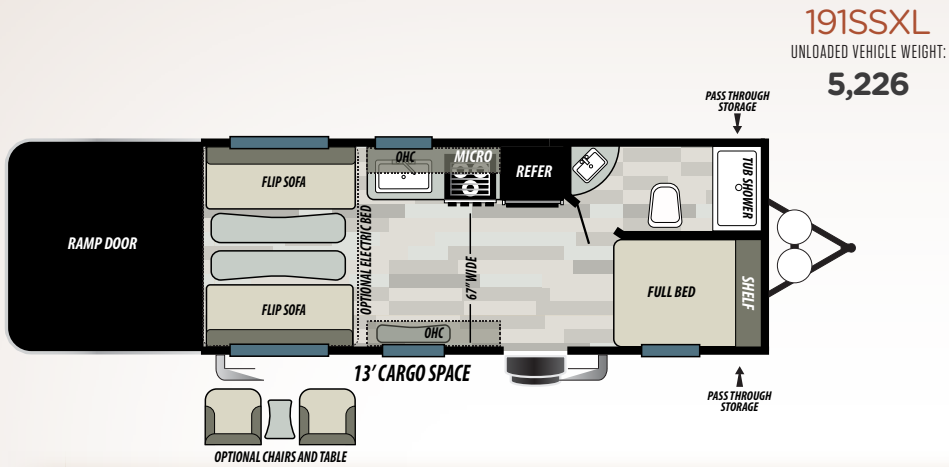

	191SSXL	211SSXL	251SSXL	177RBFSX	177BHFSX
HITCH WEIGHT (LBS)	710	890	835	410	380
AXLE WEIGHT (LBS)	8510	8690	8635	4310	4280
UNLOADED VEHICLE WEIGHT (LBS)	5226	5332	5759	3216	3152
CARGO CARRYING CAPACITY (LBS)	3322	3406	2914	1151	1185
EXTERIOR LENGTH (FT)	25' 9"	27' 5"	29' 5"	21' 6"	21' 6"
EXTERIOR HEIGHT (FT)	11' 10"	11' 10"	11' 10"	10' 3"	10' 3"
FRESH WATER (GAL)	56	56	56	28	28
GREY WATER (GAL)	40	35	35	22	22
BLACK WATER (GAL)	30	30	30	22	22
TIRE SIZE (IN)	15	15	15	15	15

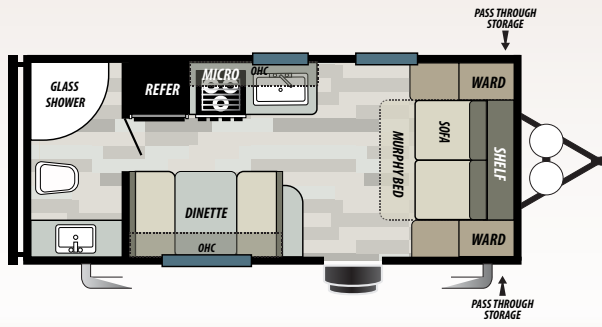

**190RBXL**  
UNLOADED VEHICLE WEIGHT:  
**4,590**

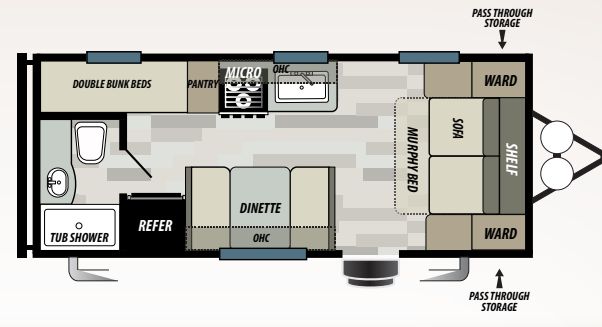

**201BHXL**  
UNLOADED VEHICLE WEIGHT:  
**4,211**

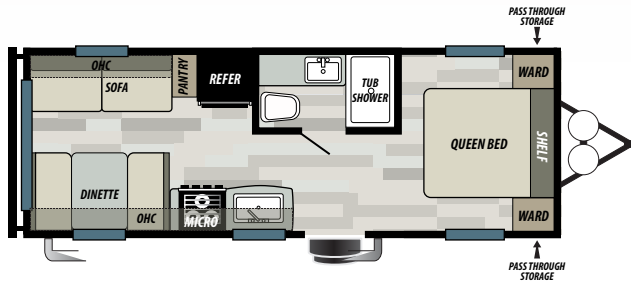

**202RDXL**  
UNLOADED VEHICLE WEIGHT:  
**4,522**

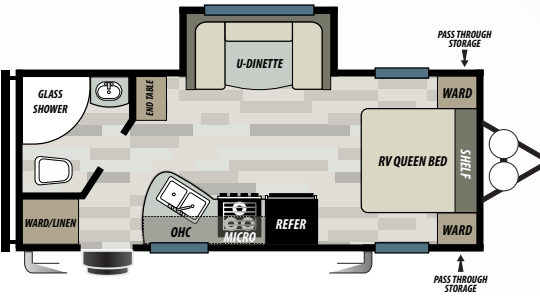

**210RBXL**  
UNLOADED VEHICLE WEIGHT:  
**4,798**

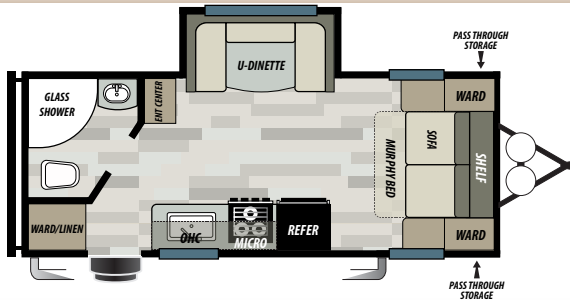

**212RBXL**  
UNLOADED VEHICLE WEIGHT:  
**5,064**

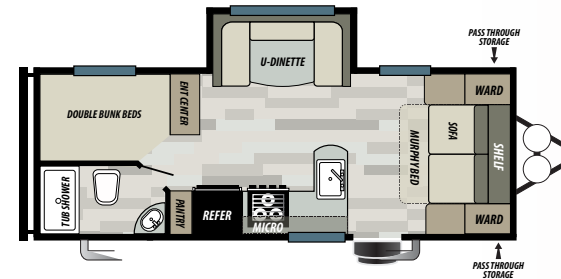

**221BHXL**  
UNLOADED VEHICLE WEIGHT:  
**5,241**

## SALEM CRUISE LITE FLOORPLAN KEY

Pillows and blankets shown on beds and bunks are for demonstration purposes only and do not come with your new coach.

- OHC** OVERHEAD CABINET
- WARD** WARDROBE
- MICRO** MICROWAVE
- LAV** BATHROOM SINK

	190RBXL	201BHXL	202RDXL	210RBXL	212RBXL	221BHXL
HITCH WEIGHT (LBS.)	570	465	552	540	610	665
AXLE WEIGHT (LBS.)	7570	7465	7552	7540	7610	7665
UNLOADED VEHICLE WEIGHT (LBS.)	4590	4211	4522	4798	5064	5241
CARGO CARRYING CAPACITY (LBS.)	3018	3292	3068	2780	2622	2462
EXTERIOR LENGTH (LBS.)	22' 8"	23' 8"	25' 10"	24' 8"	24' 4"	26' 5"
EXTERIOR HEIGHT (LBS.)	10' 1"	10' 4"	10' 4"	10' 10"	10' 10"	10' 10"
FRESH WATER (GAL.)	56	56	56	56	56	56
BLACK WATER (GAL.)	30	30	30	28	35	35
GREY WATER (GAL.)	30	30	22	30	30	30
TIRE SIZE (IN.)	15	15	15	15	15	15

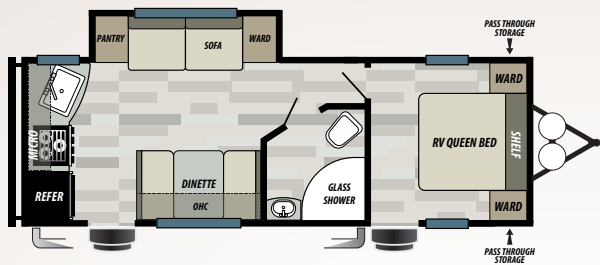

**231RKXL**  
UNLOADED VEHICLE WEIGHT:  
**5,367**

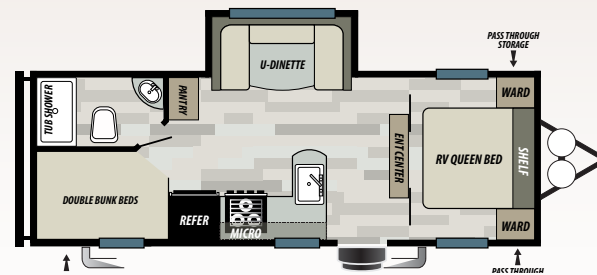

**241BHXL**  
UNLOADED VEHICLE WEIGHT:  
**5,241**

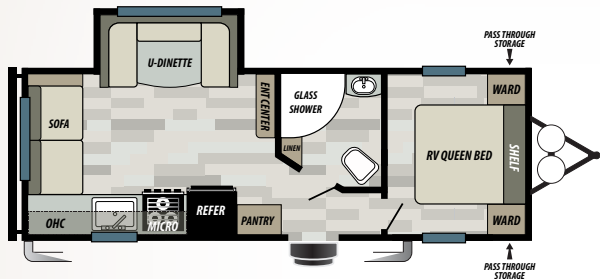

**241RLXL**  
UNLOADED VEHICLE WEIGHT:  
**5,516**

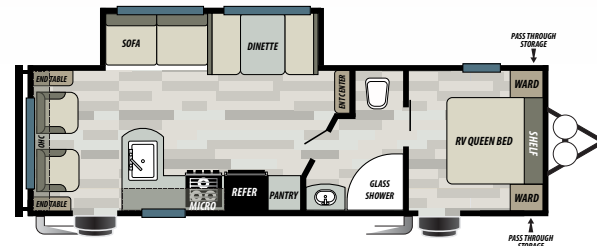

**254RLXL**  
UNLOADED VEHICLE WEIGHT:  
**6,101**

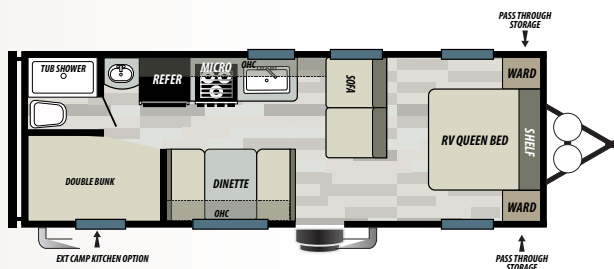

**261BHXL**  
UNLOADED VEHICLE WEIGHT:  
**4,753**

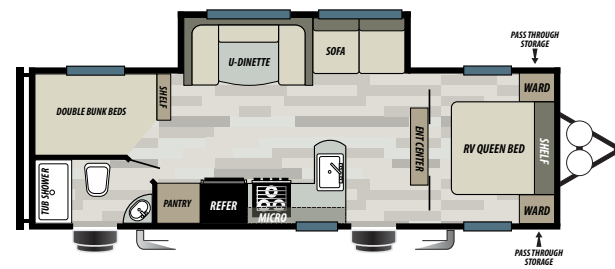

**263BHXL**  
UNLOADED VEHICLE WEIGHT:  
**5,931**

## SALEM FLOORPLAN KEY

Pillows and blankets shown on beds and bunks are for demonstration purposes only and do not come with your new coach.

<b>OHC</b>	<b>MICRO</b>
OVERHEAD CABINET	MICROWAVE
<b>WARD</b>	<b>LAV</b>
WARDROBE	BATHROOM SINK

	<b>231RKXL</b>	<b>241BHXL</b>	<b>241RLXL</b>	<b>254RLXL</b>	<b>261BHXL</b>	<b>263BHXL</b>
HITCH WEIGHT (LBS.)	545	595	680	685	495	635
AXLE WEIGHT (LBS.)	7545	7595	7680	7685	7495	7635
UNLOADED VEHICLE WEIGHT (LBS.)	5367	5241	5516	6101	4753	5931
CARGO CARRYING CAPACITY (LBS.)	2216	2392	2202	1622	2780	1742
EXTERIOR LENGTH (LBS.)	27' 4"	28' 3"	28' 8"	30' 11"	28' 4"	31' 8"
EXTERIOR HEIGHT (LBS.)	10' 4"	10' 10"	10' 10"	10' 10"	10' 4"	10' 10"
FRESH WATER (GAL.)	56	56	56	56	56	56
BLACK WATER (GAL.)	30	35	35	30	28	65
GREY WATER (GAL.)	30	30	30	28	30	30
TIRE SIZE (IN.)	15	15	15	15	15	15

**271BHXL**  
UNLOADED VEHICLE WEIGHT:  
**6,391**

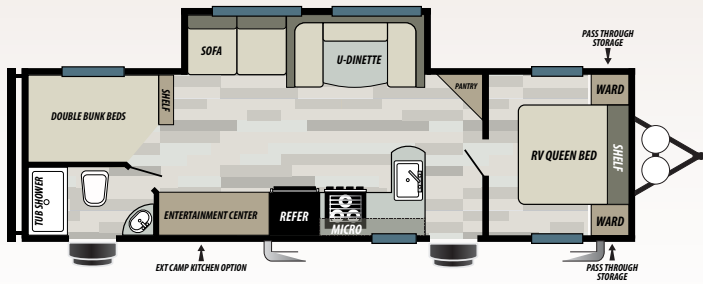

**CRUISE LITE**

# STANDARDS & OPTIONS

**273QBXL**  
UNLOADED VEHICLE WEIGHT:  
**6,156**

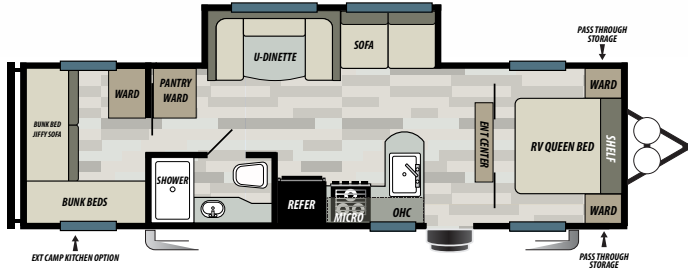

**282QBXL**  
UNLOADED VEHICLE WEIGHT:  
**6,495**

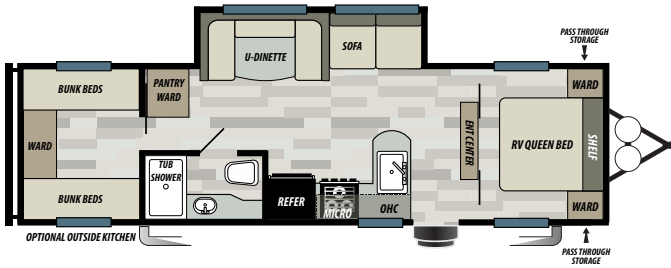

## STANDARD FEATURES

- New stainless steel single pole faucet
- New 6-way adjustable hidden hinges
- Large entertainment center, allows for larger TV (Some models)
- Aerodynamic front profile
- Mortise and tenon shaker style cabinet door
- 3 Burner cook top
- 13.5K A/C (Non-ducted)
- Textured rock guard
- Digital TV antenna w/ booster
- Cable / satellite ready
- Bluetooth stereo w/ remote (Limited time option\*)
- "Teddy bear" bunk mattress
- 2 gas struts under main bed
- Shoe nook at the end of the main bed (Per floorplan)
- Large tables at U-dinette
- 2 Exterior speakers
- 2 - 20 lb. LP bottles w/ hard cover
- Extra large kitchen overhead cabinets
- Stainless steel microwave
- Water heater by-pass
- Single door refrigerator
- Ball bearing drawer guides
- 6 Gal. Gas DSI water heater
- Radius shower enclosure (Per floorplan)
- Pass thru storage
- One piece kitchen backsplash
- High definition countertops

- 78" Interior height
- Brushed nickel cabinet hardware
- Beauflor® linoleum flooring
- Manual awning

## POPULAR OPTIONS

- Double door refer IPO single door
- Stabilizer jacks
- Range w/ oven IPO cook top
- Spare tire & carrier
- Ducted A/C
- Outside camp kitchen (Certain models)

## LIMITED TIME OPTIONS

- (Contact your local dealer for more information)
- Exterior LED light strip under awning
  - Recessed stove top w/ glass stove cover
  - Modern roller shades w/ autostop (Living, bed)
  - Green pkg: Solar prep & LED mushroom lights
  - Power awning w/ adjustable legs
  - Power stab jacks and power tongue jack
  - Push button remote w/ remote holster (Operates slides, stab jacks, awning, light)
  - Bluetooth stereo with remote
  - LED accent pkg
  - Backup camera prep
  - Stainless steel appliance package

\* See your dealer for more details about our Limited Time Options

	<b>271BHXL</b>	<b>273QBXL</b>	<b>282QBXL</b>
<b>HITCH WEIGHT (LBS.)</b>	775	760	705
<b>AXLE WEIGHT (LBS.)</b>	7775	7760	7705
<b>UNLOADED VEHICLE WEIGHT (LBS.)</b>	6391	6156	6495
<b>CARGO CARRYING CAPACITY (LBS.)</b>	1422	1642	1248
<b>EXTERIOR LENGTH (LBS.)</b>	32' 10"	33' 1"	32' 10"
<b>EXTERIOR HEIGHT (LBS.)</b>	10' 10"	10' 10"	10' 10"
<b>FRESH WATER (GAL.)</b>	56	56	56
<b>BLACK WATER (GAL.)</b>	65	28	30
<b>GREY WATER (GAL.)</b>	30	30	28
<b>TIRE SIZE (IN.)</b>	15	15	15





SHOWN IN OYSTER

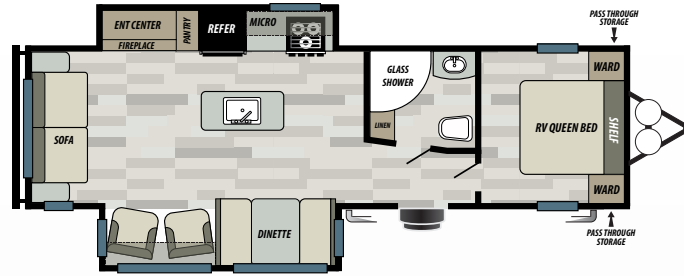

# 27REI

REAR LIVING COUPLE'S COACH

**Just the two of us.**

Enjoy your time away, in this incredibly spacious coach with a beautiful rear living area and maximized storage space.



SHOWN WITH CUSTOMER-SUPPLIED TV

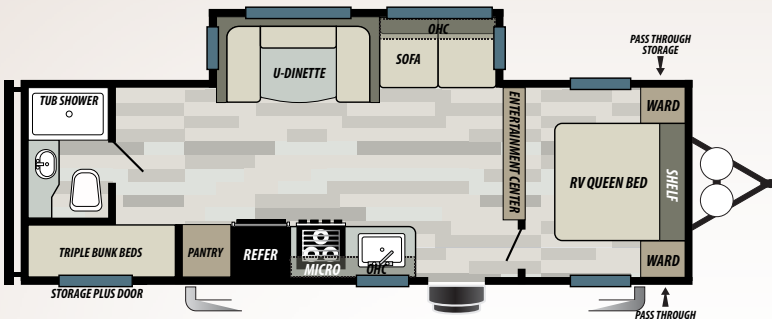

**26TBUD**  
UNLOADED VEHICLE WEIGHT:  
**5,867**

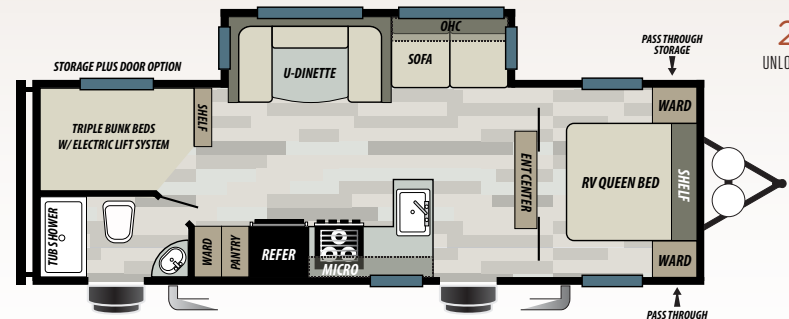

**27TDSS**  
UNLOADED VEHICLE WEIGHT:  
**6,702**

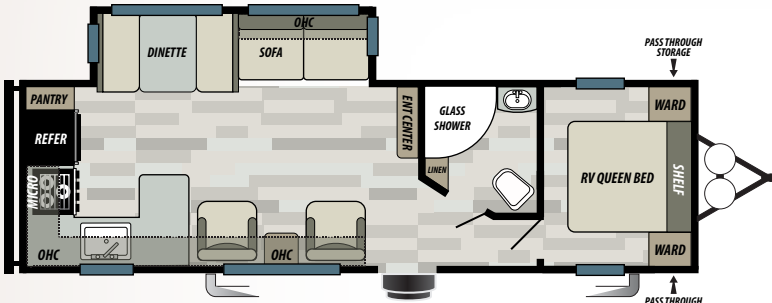

**27RKSS**  
UNLOADED VEHICLE WEIGHT:  
**6,432**

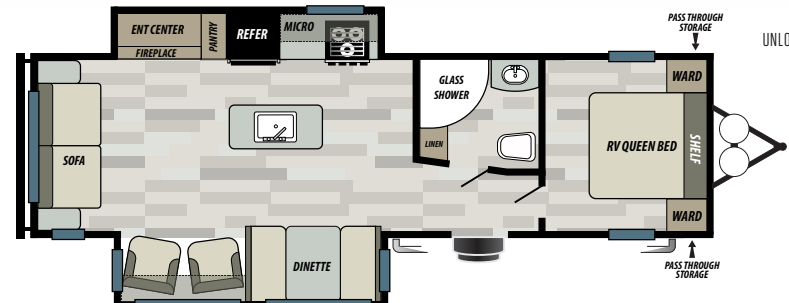

**27REI**  
UNLOADED VEHICLE WEIGHT:  
**7,934**

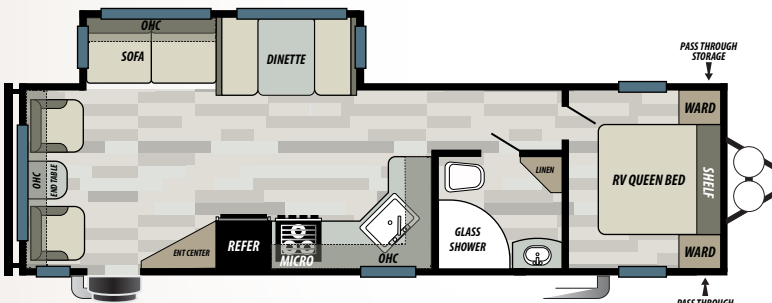

**28RLSS**  
UNLOADED VEHICLE WEIGHT:  
**7,075**

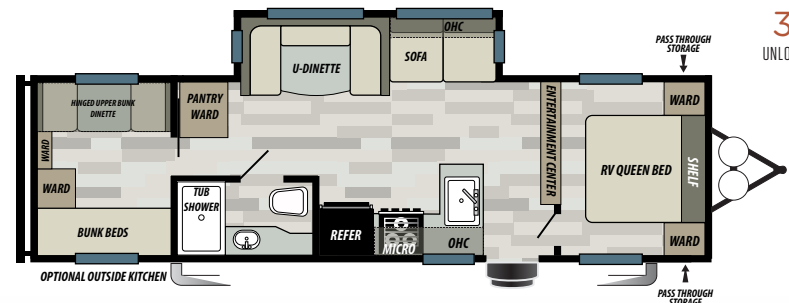

**30QBSS**  
UNLOADED VEHICLE WEIGHT:  
**7,147**

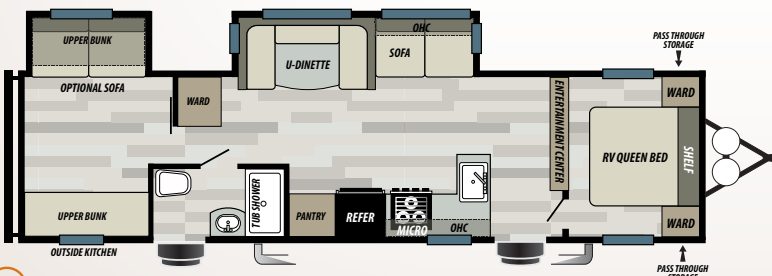

**32BHDS**  
UNLOADED VEHICLE WEIGHT:  
**8,064**

## SALEM FLOORPLAN KEY

Pillows and blankets shown on beds and bunks are for demonstration purposes only and do not come with your new coach.

**OHC**  
OVERHEAD CABINET  
**WARD**  
WARDROBE

**MICRO**  
MICROWAVE  
**LAV**  
BATHROOM SINK

# SALEM STANDARDS & OPTIONS

## CONSTRUCTION & EXTERIOR

- 5/8" tongue & groove floor decking
- Full walk on one-piece seamless Roof w/ 12 year manufacturer defect warranty
- Extra large full pass through storage (Per floorplan)
- Cold crack and mildew resistant vinyl patio awning
- Safety glass windows
- Metal framed 30" smooth radius corner fiberglass main entry door
- Powder coated I-beam frame
- Cambered chassis
- Gas/Electric quick recovery DSI water heater
- Water heater by-pass
- 2" wall construction, 16" (or less) on center
- R-7 fiberglass insulation throughout
- Triple seal slide out system
- Flush floor electric slide out systems
- Swing arm entry assist handle
- Two marine grade exterior speakers
- Aerodynamic front radius profile
- Smooth aluminum front cap
- One-piece slip-resistant Beauflor® vinyl flooring

## KITCHEN

- New Mortise and Tenon Shaker Style Cabinet Doors
- New Hidden hinges throughout
- Dometic® double door refrigerator (2 yr. warranty)

- High rise spring faucet (Limited Program Option)
- Residential Undermount Kitchen Sink
- Stainless steel finish microwave w/ carousel
- 3-Burner, high output range with oven (2 yr. warranty) Stainless steel finish on oven door
- Stainless steel finish range hood w/ 12-volt exhaust fan and light
- Full extension ball bearing drawer guides
- Knife rack (Behind cook top)
- Shelving in overhead cabinets in kitchen
- Central switch location for command center
- Brushed stainless finish hardware
- Abundant cabinet storage
- Large pots and pans drawer under dinette

## LIVING ROOM

- 80" interior height
- Ducted 13,500 BTU roof air conditioner w/ quick cool
- Huge storage drawer under jiffy sofa
- Booth dinette (Most models) and U-shaped dinette (Some models)
- Large dinette picture window
- Digital antenna with booster
- Bluetooth FM stereo and four speakers
- Suburban® forced air DSI furnace w/ digital thermostat (2 yr. warranty)
- In-floor ducted heat

- Cable TV hookup living room and bedroom
- Wall switch controls for ceiling lights at living room and bathroom

## BEDROOM

- NEW Denver mattress with pillow top in master bed (Limited program option)
- Strut lifted storage area under bed (Master bedroom)
- Bedside mirrored wardrobes w/ shelf above bed
- Bedside 110-volt power outlets (2)
- Increased space at the foot of the bed (Most models)
- Solid bedroom privacy doors (Most models)
- Shoe nook at the foot of the master bed
- Bedside hamper access (Most models)

## BATHROOM

- 12-volt power bath roof exhaust vent
- Foot flush toilet
- Vinyl tub surround (Radius angle showers have an enclosure) (Select floorplans)

## SECURITY AND SAFETY

- LP leak detector
- Smoke detector
- Carbon monoxide detector
- Fire extinguisher
- Welded heavy duty safety chains
- Electric brakes (All wheels)

- GFI receptacles
- ANSI 119.2 certified
- Meets all national highway administration specifications
- RVIA approved product

## OPTIONS

- Stabilizer jacks
- Skylight over tub
- 30-lb LP bottles w/ cover and auto change-over
- 15,000 BTU ducted air w/ quick cool

## LIMITED TIME OPTIONS

- (Contact your local dealer for more information)
- Denver 9" pillowtop mattress
- Exterior white LED light strip under awning
- LG Solid Surface Kitchen Countertops
- Modern roller shades w/ autoStop (Living, Bed)
- Residential designer spring faucet
- Green pkg: Solar prep & LED mushroom lights
- Power awning w/ adjustable legs
- Power stab jacks and power tongue jack
- Push button remote w/ remote holster (Operates slides, stab jacks, awning and light)
- Bluetooth stereo with remote
- Backup camera prep
- LED accent pkg

Contact your dealer for a complete list of options.

	26TBUD	27TDSS	27RKSS	27REI	28RLSS	30QBSS	32BHDS
HITCH WEIGHT (LBS.)	815	806	720	730	844	817	874
AXLE WEIGHT (LBS.)	7815	9999	9999	9999	9999	9999	9999
UNLOADED VEHICLE WEIGHT (LBS.)	5867	6702	6432	7934	7075	7147	8064
CARGO CARRYING CAPACITY (LBS.)	1986	3297	3567	2065	2913	2852	1935
EXTERIOR LENGTH (LBS.)	29' 1"	32' 4"	33' 6"	34' 1"	34' 9"	34'	36' 4"
EXTERIOR HEIGHT (LBS.)	11' 2"	11' 2"	11' 2"	11' 3"	11' 3"	11' 3"	11' 3"
FRESH WATER (GAL.)	56	56	56	56	56	56	56
BLACK WATER (GAL.)	34	75	65	60	80	65	58
GREY WATER (GAL.)	32	40	28	30	35	30	30
TIRE SIZE (IN.)	15	15	15	15	15	15	15

# THE SALEM LINE-UP



SALEM



SALEM CRUISE LITE

## Specification Definitions

**GVWR (Gross Vehicle Weight Rating)** - is the maximum permissible weight of the unit when fully loaded. It includes all weights, inclusive of all fluids, cargo, optional equipment and accessories. For safety and product performance do NOT exceed the GVWR.

**GAWR (Gross Axle Weight Rating)** - is the maximum permissible weight, including cargo, fluids, optional equipment and accessories that can be safely supported by a combination of all axles.

**UVW (Unloaded Vehicle Weight)\*** - is the typical weight of the unit as manufactured at the factory. It includes all weight at the unit's axle(s) and tongue or pin and LP Gas. The UVW does not include cargo, fresh potable water, additional optional equipment or dealer installed accessories.

\*Estimated average based on standard build optional equipment.

**CCC (Cargo Carrying Capacity)\*\*** - is the amount of weight available for fresh potable water, cargo, additional optional equipment and accessories. CCC is equal to GVWR minus UVW. Available CCC should accommodate fresh potable water (8.3 lbs per gallon). Before filling the fresh water tank, empty the black and gray tanks to provide for more cargo capacity.

\*\* Estimated average based on standard build optional equipment

Each Forest River RV is weighed at the manufacturing facility prior to shipping. A label identifying the unloaded vehicle weight of the actual unit and the cargo carrying capacity is applied to every Forest River RV prior to leaving our facilities.

The load capacity of your unit is designated by weight, not by volume, so you cannot necessarily use all available space when loading your unit.

All information contained in this brochure is believed to be accurate at the time of publication. However, during the model year, it may be necessary to make revisions and Forest River, Inc., reserves the right to make all such changes without notice, including prices, colors, materials, equipment and specifications as well as the addition of new models and the discontinuance of models shown in this brochure. Therefore, please consult with your Forest River dealer and confirm the existence of any materials, design or specifications that are material to your purchase decision. Litho. U.S.A. FDR 1507 P/W: 2018.04.10

**FREE MEMBERSHIP**  
to Forest River Owners' Group

[www.forestriverfrog.com](http://www.forestriverfrog.com)



YOUR SALEM DEALER

## CUSTOMER SATISFACTION



[www.ForestRiverBuyLocal.com](http://www.ForestRiverBuyLocal.com)



**Learn More**  
Scan this barcode using a QR Reader on your smart phone to learn more about Forest River.



A Berkshire Hathaway company.