

WILDWOOD XLITE

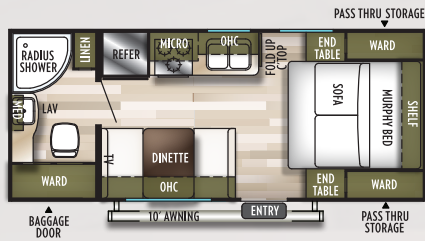

WE DON'T WAIT FOR THE FUTURE. **WE BUILD IT!**





171RBXL

UVW =3798

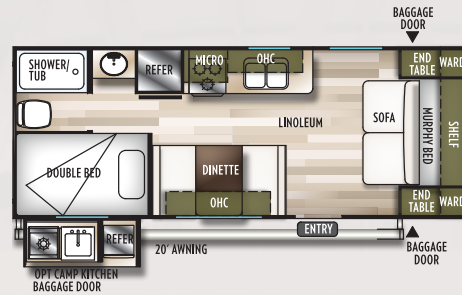

19DBXL

UVW =4380

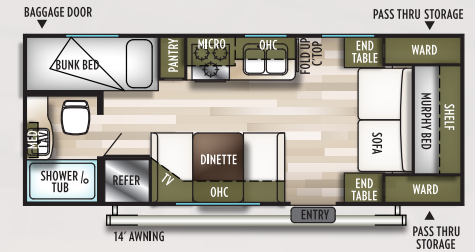

201BHL

UVW =4195

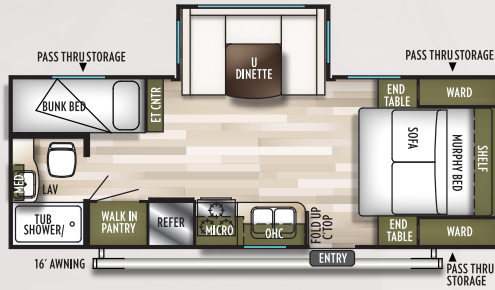

230BHL

UVW =4903

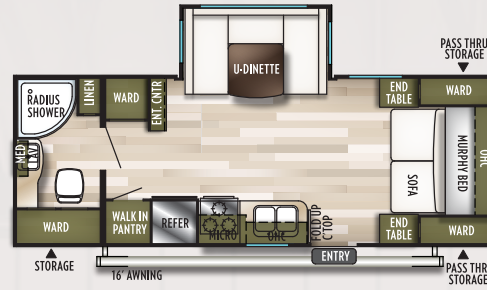

233RBXL

UVW =4895

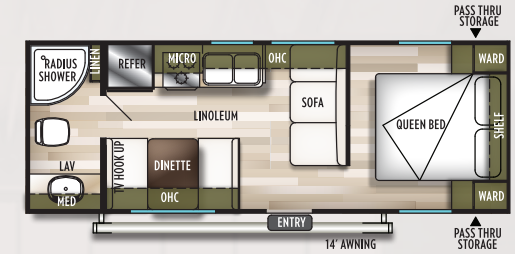

241QBXL

UVW =4135

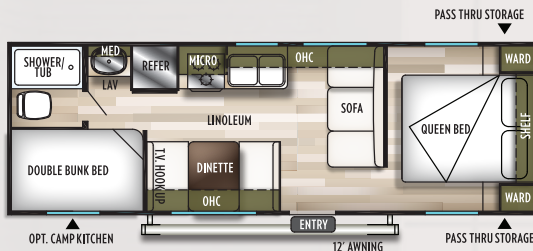

261BHL

UVW =4314

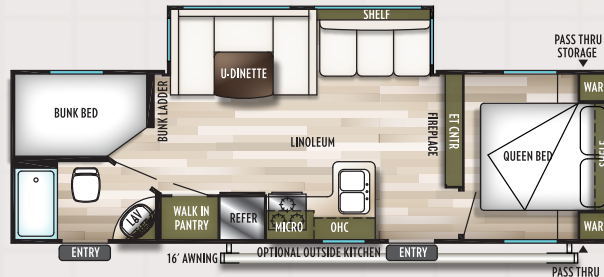

263BHL

UVW =5816

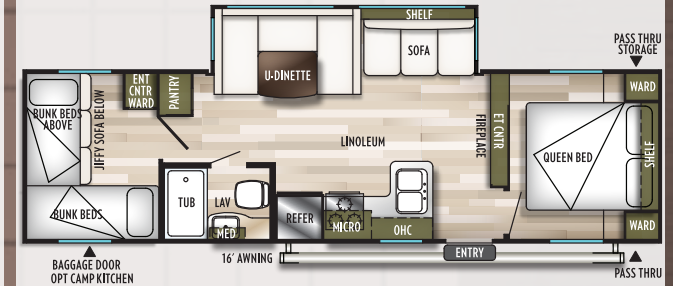

273QBXL

UVW =5937

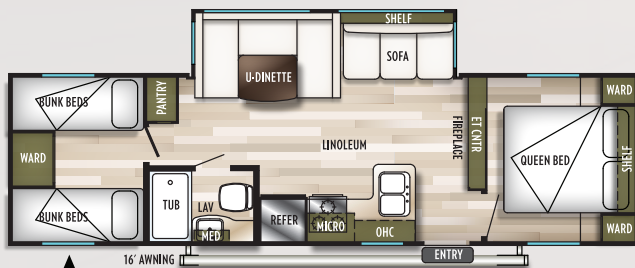

282QBXL

UVW =6155

	171RBXL	19DBXL	201BHL	230BHL	233RBXL	241QBXL	261BHL	263BHL	273QBXL	282QBXL
UVW	3798	4380	4195	4903	4895	4135	4314	5816	5937	6155
Hitch Wt.	521	520	528	694	716	499	434	682	680	636
Carrying Capacity	3685	3102	3295	2753	2783	3326	3082	1828	1705	1443
Ext. Length	22'5"	24'8"	23'7"	25'10"	26'3"	26'11"	29'1"	31'5"	33'3"	32'11"
Ext. Height	10'1"	10'1"	10'1"	10'4"	10'6"	10'1"	10'1"	10'4"	10'4"	10'4"
Fresh Water	38	40	38	38	38	38	38	38	38	38
Gray Water	30	28	30	30	30	40	30	60	32	30
Black Water	30	30	30	30	30	30	30	30	34	20
Tire Size	14"	14"	14"	14"	14"	14"	14"	14"	14"	14"

X-LITE
360° TOURS



<https://l.ead.me/bb1ixn>



241QBXL (SHOWN IN CLAY DECOR)



171RBXL (SHOWN IN MINK DECOR)

WHEN YOU COMPARE THE DIFFERENCE IS CLEAR

STOW AND GO STORAGE

WILDWOOD

WHO KNOWS?

COMPETITION

CLOTH ROLLER SHADES

WILDWOOD

ROCK-SOLID STABILIZING JACKS
EACH JACK HOLDS UP TO 5,000 LBS.

WILDWOOD

6 CU FT REFRIGERATOR

COMPETITION

TRADITIONAL BLINDS

COMPETITION

UNSTABLE & UNEASY

COMPETITION

SHAKY & UNSTABLE

COMPETITION

SOLID STEP

WILDWOOD

STAINLESS STEEL 10.7 CU FT 12-VOLT REFRIGERATOR

WILDWOOD

VISIT FORETRIVERINC.COM/WILDWOOD

TO EXPERIENCE COMPLETE STANDARDS & MUCH MORE

**24/7 EMERGENCY
ROADSIDE ASSISTANCE
WITH VEHICLE PURCHASE***

- | | |
|----------------|-----------------|
| TOWING | WINCH-OUT |
| JUMP-STARTS | MOBILE MECHANIC |
| TIRE CHANGES | TECHNICAL |
| FLUID DELIVERY | SUPPORT |
| LOCKOUT | DEALER LOCATOR |
| SERVICE | SERVICES |



*VALID FOR 1 YEAR FROM DATE OF PURCHASE

FREE MEMBERSHIP
to Forest River Owners' Group

www.forestriverfrog.com



Learn More
Scan this barcode using
a QR Reader on your
smart phone to learn
more about Forest River.



A Berkshire Hathaway company.

FOREST RIVER, INC. 55470 G.R. 1 ELKHART, IN 46515 | (574) 533-5934
WWW.FORESTRIVERINC.COM/WILDWOOD | WWW.FORESTRIVERACCESSORIES.COM



PRE-DELIVERY INSPECTION FACILITY

20,000 square feet of quality assurance. The bare essentials for a premium product. This state-of-the-art facility gives immediate daily feedback to production for quality assurance in every unit built.

Specification Definitions

GVWR (Gross Vehicle Weight Rating) - is the maximum permissible weight of the unit when fully loaded. It includes all weights, inclusive of all fluids, cargo, optional equipment and accessories. For safety and product performance do NOT exceed the GVWR.

GAWR (Gross Axle Weight Rating) - is the maximum permissible weight, including cargo, fluids, optional equipment and accessories that can be safely supported by a combination of all axles.

UVW (Unloaded Vehicle Weight)* - is the typical weight of the unit as manufactured at the factory. It includes all weight at the unit's axle(s) and tongue or pin and LP Gas. The UVW does not include cargo, fresh potable water, additional optional equipment or dealer installed accessories.

*Estimated average based on standard build optional equipment.

CCC (Cargo Carrying Capacity)** - is the amount of weight available for fresh potable water, cargo, additional optional equipment and accessories. CCC is equal to GVWR minus UVW. Available CCC should accommodate fresh potable water (8.2 lbs per gallon). Before filling the fresh water tank, empty the black and gray tanks to provide for more cargo capacity.

** Estimated average based on standard build optional equipment

Each Forest River RV is weighed at the manufacturing facility prior to shipping. A label identifying the unloaded vehicle weight of the actual unit and the cargo carrying capacity is applied to every Forest River RV prior to leaving our facilities.

The load capacity of your unit is designated by weight, not by volume, so you cannot necessarily use all available space when loading your unit.

All information contained in this brochure is believed to be accurate at the time of publication. However, during the model year, it may be necessary to make revisions and Forest River, Inc., reserves the right to make all such changes without notice, including prices, colors, materials, equipment and specifications as well as the addition of new models and the discontinuance of models shown in this brochure. Therefore, please consult with your Forest River dealer and confirm the existence of any materials, design or specifications that are material to your purchase decision. Litho. U.S.A. FOR 1422 P/W: 2017.11.01

CUSTOMER SATISFACTION



www.ForestRiverBuyLocal.com

YOUR WILDWOOD DEALER 2019

WILDWOOD
PRODUCT FAMILY



X-LITE



WILDWOOD



HERITAGE GLEN



DLX | LODGE | GRAND LODGE