

XLR
TOY HAULERS

HYPERLITE

YOU'LL FIND THE BEST STORIES ON THE ROAD LESS TRAVELED



2022

HYPERLITE

The Hyperlite's rustic yet modern decor makes you feel at home even while you're out exploring. Custom styling and quality features are all packed into this lightweight design. Today's tow vehicles can handle more and Hyperlite certainly gives you more.



Every Hyperlite model offers a standard TV, solid surface countertops, and maintains a minimum of 74" storage width.



Entertainment center featuring 39" Smart TV, HD sound bar and electric fireplace.



Our 3310 is an exclusive layout, never before offered in a toy hauler.



The 2815 has storage that is unmatched in this size travel trailer.



The 2513 offers a spacious bedroom with ample storage.



Each Hyperlite bathroom is designed to maximize functionality and convenience (2815 shown).



3412 model shown.



WIDER INTERIORS

Each model maintains a minimum 74" interior width even with the slides retracted in. Our legacy continues with 102" wide-body Hyperlite HD models offering premium features and slides on all models.

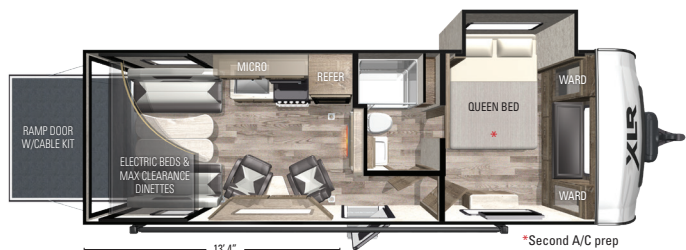

2513	Hitch Weight (lbs)	UVW (lbs)	CCC (lbs)	Exterior Length	Exterior Height	Exterior Width	Water Capacities (fresh / gray / black)
Awning 18"	1450	7612	3532	29' 10"	12' 1"	101"	102/60/30

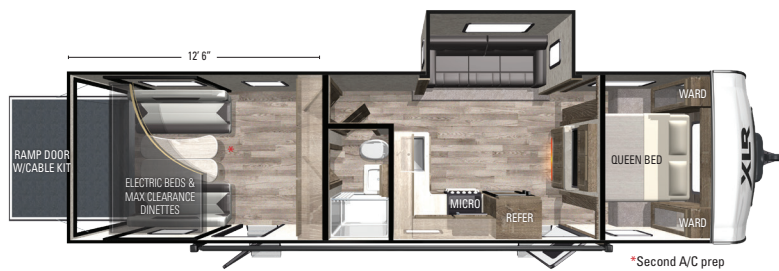

3212	Hitch Weight (lbs)	UVW (lbs)	CCC (lbs)	Exterior Length	Exterior Height	Exterior Width	Water Capacities (fresh / gray / black)
Awning 20"	1485	8593	3092	36' 4"	12' 1"	102"	102/60/30

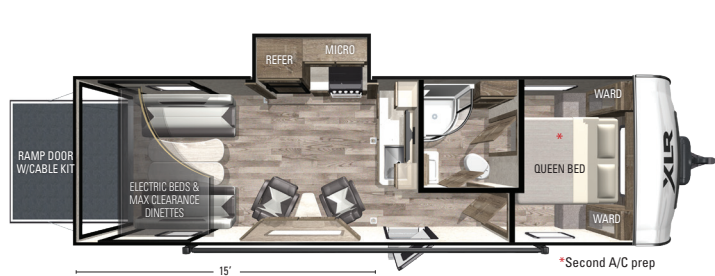

2815	Hitch Weight (lbs)	UVW (lbs)	CCC (lbs)	Exterior Length	Exterior Height	Exterior Width	Water Capacities (fresh / gray / black)
Awning 20"	1230	8008	3712	32' 4"	12' 1"	102"	102/64/32



3310	Hitch Weight (lbs)	UVW (lbs)	CCC (lbs)	Exterior Length	Exterior Height	Exterior Width	Water Capacities (fresh / gray / black)
Awning 20"	1580	9998	1782	37' 3"	12' 1"	102"	102/60/30

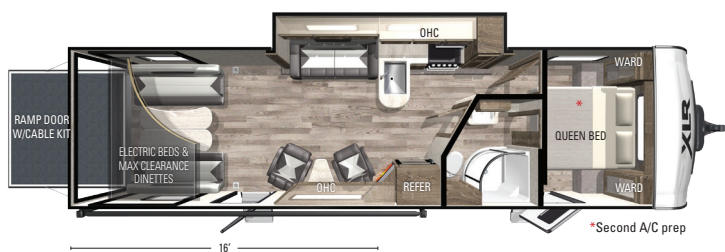

3016	Hitch Weight (lbs)	UVW (lbs)	CCC (lbs)	Exterior Length	Exterior Height	Exterior Width	Water Capacities (fresh / gray / black)
Awning 20"	1410	8853	2757	35' 3"	12' 1"	102"	102/60/30

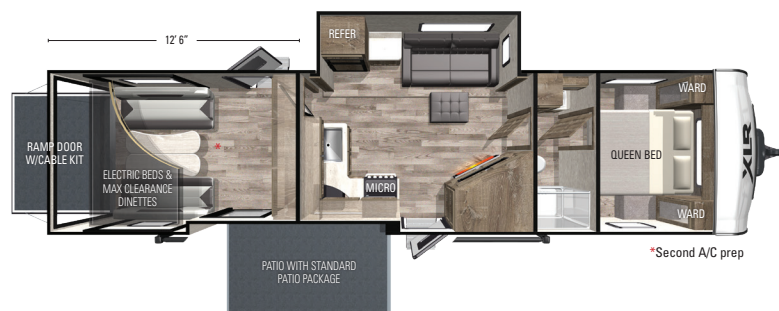

3412	Hitch Weight (lbs)	UVW (lbs)	CCC (lbs)	Exterior Length	Exterior Height	Exterior Width	Water Capacities (fresh / gray / black)
Awning 20"	1388	10010	3378	38' 8"	12' 1"	101"	102/60/30

SCAN THE QR CODE WITH YOUR PHONE CAMERA APP FOR MORE INFORMATION:



FLOORPLANS



MORE FEATURES



VIDEOS



QUALITY FEATURES

A Hyperlite is built to withstand the rigors of heavy use. You'll find more quality, user-friendly features, coupled with premium components, materials and custom fit-and-finish.

For more information on colors, options and available features consult your authorized Hyperlite dealer.



INTERIOR DECOR COLOR OPTIONS

Choose from Hickory (grey) or Walnut (dark brown) interior decor packages. Quality materials and craftsmanship go into every Hyperlite unit.



Hickory interior



Walnut interior

TALE OF THE TAPE WHEN SIZE MATTERS

Hyperlite has redefined what a Travel Trailer Toy Hauler should look and feel like. Our 2022 exteriors feature UV resistant Gel-Coated fiberglass with aluminum framing, fully enclosed "Body-Armor" underbelly, and full LED taillights to name a few. These spacious garages and interiors provide maximum space.



* Height from the dovetail to bottom of the bed is 81" and the height from dovetail to the 3 season door opening is 87".



NEW ECO MODE

Hyperlite's NPS Yamaha generator features the new ECO MODE, the latest iteration of software and components for a quieter, more efficient, operation.



FUELING STATION

Take it all with you! Now you can load the toys for the weekend and keep them going with our on-board 20 gal. fueling station.

TPMS BY TST

Monitored air and temperature readings for each wheel with real time display.



NITROFILL

NitroFill keeps tires cooler and cooler tires give you peace of mind.



MORryde® SUSPENSION

3" of vertical travel which reduces road shock and chassis fatigue.



TIE-DOWNS

5000-lb rated tie-downs are anchored to steel plates.



LIPPERT® WEATHER-PROOF RAMP DOOR

Able to leave out in all conditions minimizing the risk to the ramp door.



MAVERICK RAMP PATIO PACKAGE

Sets up in less than 30 seconds.



ALUMINUM TREAD TRIPLE STEPS

Makes entering and exiting your XLR easier.



CENTRAL VACUUM

Our central vacuum system features convenient access and ease of use.



WIDE-BODY FRAME



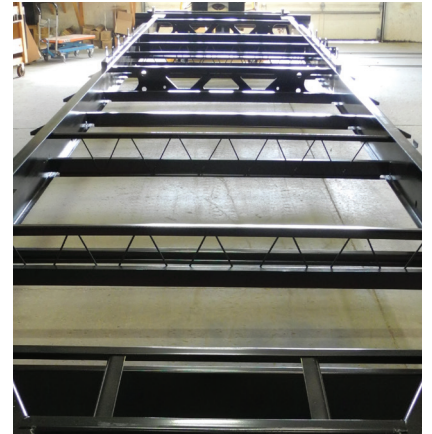







102" wide body chassis for a minimum of 74" of interior width w/the slides in on every floorplan.



WHY XTRA BUILT MATTERS?

What's XTRA BUILT? Compare us to other Travel Trailers and you'll see that an XLR Toy Hauler is simply built right. We know that Action Campers use their RV's the way they play—harder. So upgraded features and quality construction put you in control...on or off road!



 <p>Our radiant-reflective insulation layers are 97% efficient in keeping you comfortable.</p>	 <p>A MORryde® CRE3000 premium suspension smooths out even the toughest of North America's roads.</p>
 <p>Heavy-duty Dexter® axles offer you best in class carrying capacities.</p>	 <p>A Wide-Track frame design provides a more stable and stronger foundation over our skinnier competition.</p>
 <p>All units are wired for 50AMP service with color coded wires making maintenance and repairs even easier.</p>	 <p>XLR utilizes weather resistant tongue-and-groove plywood in all main living areas.</p>
 <p>The XLR fully enclosed "Body Armor" underbelly is insulated and uses a panel system for ease of access.</p>	 <p>XLR has offered the strongest 5,000-lb. tie-down anchor system in the industry since day one to secure your precious cargo.</p>
 <p>Our vacuum-bonded technology provides superior adhesion and durability.</p>	 <p>Our 1.5" fresh water drain provides a lightning fast way to empty your tank.</p>

AXLES, TIRES & SUSPENSION

Dexter® axles and Lionshead® tires and wheels are the best in the business. With Lionshead "No Excuses Guarantee," we have your back. An upgraded suspension will smooth out the road and provide the safest means of travel for you and your family.



XTRA CONSTRUCTION FEATURES

- ① Body Armor Protective Underbelly
- ② Ducted Loop A/C Distribution System
- ③ Laminated & Insulated Slide Room
- ④ Best in Class 5,000-lb. Tie-Down System
- ⑤ Dexter® Axles
- ⑥ Aluminum Framed Sidewalls
- ⑦ Tongue & Groove Plywood Floor Decking
- ⑧ Gelcoat Fiberglass Exterior

STANDARD FEATURES

EXTERIOR PACKAGE

- Friction Hinge Entry Door with Window
- Dual 20# LP Tanks with Cover
- Black Tank Flush
- UV Resistant Gel-Coated Fiberglass Exterior
- Radius Fully-Walkable Roof
- Singular Roof Membrane with 12-Year Warranty
- Insulated Storage Compartment Doors
- Vacuum-Bonded Aluminum-Framed Sidewalls
- Laminated & Insulated Slide Room Walls
- Fully Enclosed "Body-Armor" Underbelly with Radiant Foil Layer
- Electric Awning with LED Lights
- Full-LED Rear Taillights
- Alumi-Tread Main Entry Steps
- Fiberglass Front Cap with Automotive Window

CHASSIS & SUSPENSION PACKAGE

- MORryde CRE3000 Suspension Enhancement
- Aluminum Wheels
- Dexter EZLube® Axles
- Full-Sized Spare Tire
- Nev-R-Adjust® Brakes
- 16" Radial Tires with Nitrofill™

SAFETY PACKAGE

- Power Tongue Jack
- 12V Battery Disconnect Switch
- 80% Tint Radius Safety Glass Windows
- LP/CO Detector
- Fire Extinguisher
- No Excuses Lionshead® Tire Warranty
- Tire Pressure Monitoring System

INTERIOR PACKAGE

- 17" Oven with Cast Iron Cooktop
- Bathroom Skylight
- Lumber Core Cabinet Stiles
- Adjustable Hidden Hinge Cabinet Hardware
- Full Extension Four-Sided Craftsman Drawers
- Radiant Foil Insulation Technology - Ceiling & Floors
- Stainless Steel Single Basin Sink
- 15,000 BTU Ducted Air Conditioning Distribution System
- Sink Drying Rack
- Hardwood Cabinet Doors
- Gas/Electric Refrigerator
- LED Accent Lighting
- Metropolitan Grey Countertops
- Master Suite with Queen Bed
- 72" Solid Passage Doors
- Master Bedroom Accent Wall

- Black Cabinet Hardware
- Underbed Storage Shelf
- Black Faucets
- Congoleum™ Stain-Resistant Vinyl Flooring
- Roller Shades in Bedroom & Living Room
- "Quick Clean" Central Vac
- Solid Surface Kitchen Countertop
- 100 Gallons Fresh Water Tank
- Rubber Garage Flooring (3212, 3310 & 3412 only)
- Electric Fireplace (N/A 2815)
- 50AMP Service
- 2nd A/C Prep

GARAGE PACKAGE

- Generator Prep
- 20 Gallon Fuel Station
- Single Electric Queen Bed with Max Clearance Sofa/Dinette
- 5,000# Cargo Tie Downs
- Insulated Floor
- Black Rear Privacy Screen
- Insulated Weatherproof Ramp Door
- Black Night Shades
- Ramp Patio Cable Kit
- Alumi-Tread Rear Entry Steps (3212, 3412, 3016, 3310)

TECHNOLOGY PACKAGE

- Winegard Air 360 Antenna with WiFi & 4G LTE Prep
- Backup Camera Prep
- Dual Zone Soundbar with Built-in Subwoofer
- TV and Cable Connections in Bedroom & Garage
- Exterior Speakers
- Convenient USB Charging Stations
- 39" Living Room TV
- Roof Satellite Prep

OPTIONAL FEATURES

- 5.5 Eco Mode Generator Powered by Yamaha
- 3-Season Rear Patio Door
- 2nd Air Conditioner
- VIP Party Deck (railing only)
- Solar Package - 190W Solar Panel with Inverter
- 12V Heated Holding Tanks
- Electric Stabilizer Jacks

CUSTOMERS LOVE THEIR XLR TOY HAULERS



WE'RE BEHIND YOU ALL THE WAY



PRE-DELIVERY INSPECTION FACILITY

20,000 square feet of quality assurance. The bare essentials for a premium product. This state-of-the-art facility gives immediate feedback to production for quality assurance in every unit built.

**24/7 EMERGENCY
ROADSIDE ASSISTANCE
WITH VEHICLE PURCHASE***

<p>TOWING JUMP-STARTS TIRE CHANGES FLUID DELIVERY LOCKOUT SERVICE</p>	<p>WINCH-OUT MOBILE MECHANIC TECHNICAL SUPPORT DEALER LOCATOR SERVICES</p>
---	--



*VALID FOR 1 YEAR FROM DATE OF PURCHASE

FREE MEMBERSHIP
to Forest River Owners' Group

www.forestriverfrog.com



FOREST RIVER OWNER DIGITAL KIT APP

Now you can have your Owner's Manual with you where ever you are. Download our FREE app from the App Store or Google Play and you'll have the information at your fingertips.



www.ForestRiverBuyLocal.com

Actual towing capacity is dependent on your particular loading and towing circumstances, which includes GVWR, GAWR and GCWR, as well as adequate trailer brakes. Please refer to the Owner's Manual of your vehicle for further information. All information contained in this brochure is believed to be accurate at the time of publication. However, during the model year, it may be necessary to make revisions and Forest River, Inc., reserves the right to make all such changes without notice, including prices, colors, materials, equipment and specifications as well as the addition of new models and the discontinuance of models shown in this brochure. Therefore, please consult with your Forest River dealer and confirm the existence of any materials, design or specifications that are material to your purchase decision. ©2021 XLR, a Division of Forest River, Inc., a Berkshire Hathaway company. All Rights Reserved. 9/21



Learn More

Scan this barcode using a QR Reader on your smart phone to learn more about Forest River.



A Berkshire Hathaway company.

XLR

TOY HAULERS

ACTION CAMPING™

2421 Century Drive / Goshen, IN 46528

Phone: 574-642-0438

E-mail: XLRinfo@forestriverinc.com



Visit our website at: forestriverinc.com/rvs/brand/XLR/toy-haulers for everything Hyperlite has to offer.

YOUR XLR ACTION CAMPING™ DEALER: