

# GEO PRO

BY ROCKWOOD

PROVIDING OUTDOOR FUN SINCE 1974





Living Area/Kitchen G20FBS

# Geo Pro

by Rockwood

## MODERN AMENITIES & STYLING

**The floor plan you want in the size you need.** We have custom designed our trailers with the best style and amenities while keeping your towing needs in mind. Modern, fresh interiors will almost make you forget you are in the great outdoors. Quality craftsmanship and attention to detail have been put into our Geo Pro travel trailers, all with you in mind.

### INTERIOR FEATURES

#### Fabrics

Idlewild Taupe

Orsino Pearl

Hubbard Flax

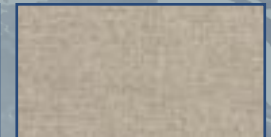

Sofa, Chairs,  
Dinette Cushions

Valances

Bedroom

#### Cabinets & Flooring

Sedona

Arya

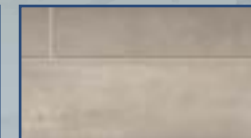
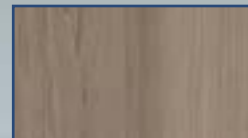

Cabinets

Floor Covering

Carpet

# Geo Pro Construction



## SUPERIOR CONSTRUCTION

- 1 Complete **Azdel** Wall Construction
- 2 5/8" Tongue & Groove Plywood Floor
- 3 Fully Laminated Walkable Roof
- 4 6-Sided Full-Aluminum Frame
- 5 Aluminum Floor Joists
- 6 Frameless Windows
- 7 Aluminum Truss Roof Bracing
- 8 Fiberglass Front Cap
- 9 Automotive Glass Windshield (N/A G15TB)



## STANDARD FEATURES

- 10 Key-Alike Lock System
- 11 Back-Up Camera Prep
- 12 200W Solar Panel with 1000W Inverter & 30 AMP Charge Controller
- 13 Maxxair Fan with Cover
- 14 Teton All-In-One WiFi Prep/Antenna
- 15 Sport Tire and Wheel Package
- 16 Additional Solar Prep
- 17 Double Battery Boxes
- 18 Double 20 Lb. LP Tanks



## SAFETY STANDARDS

- 19 MORryde Solid, Supported Steps
- 20 TST Tire Pressure Monitor System
- 21 Dexter Torsion Axles



## CLIMATE PROTECTION PACKAGE

- 22 12V Thermostat-Controlled Heated Tanks
- 23 Radiant Foil In Front Cap

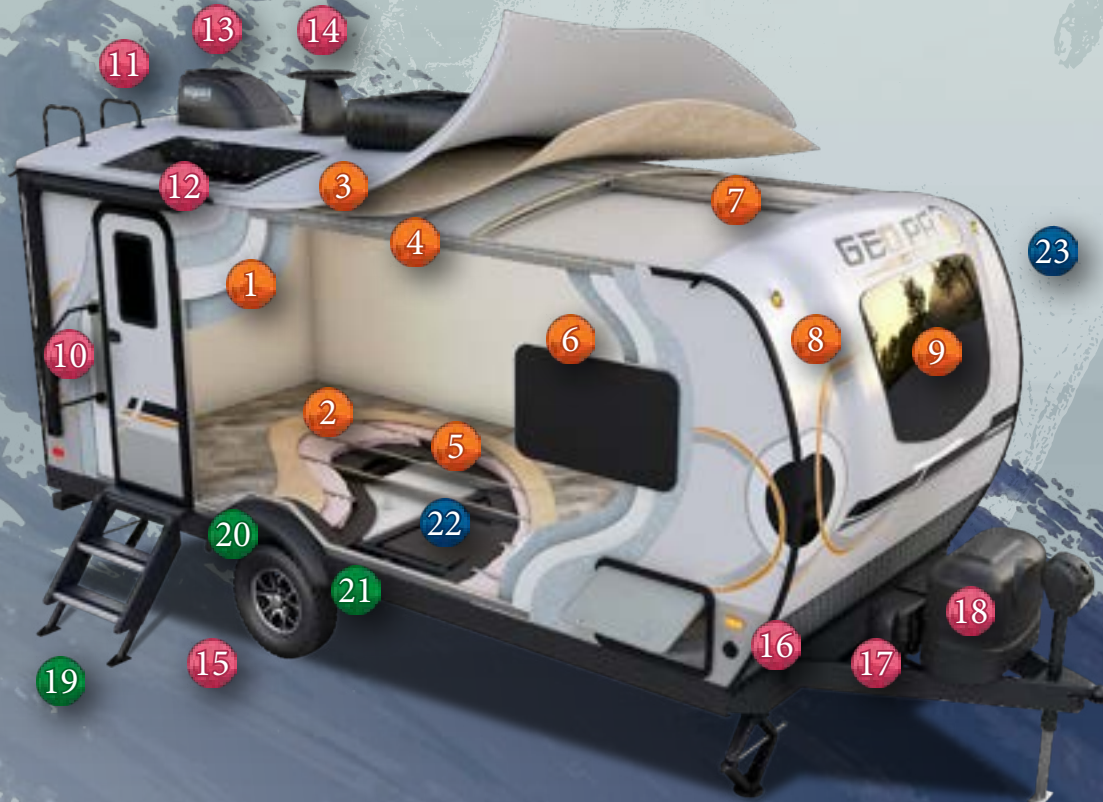

# POWER PACKAGE

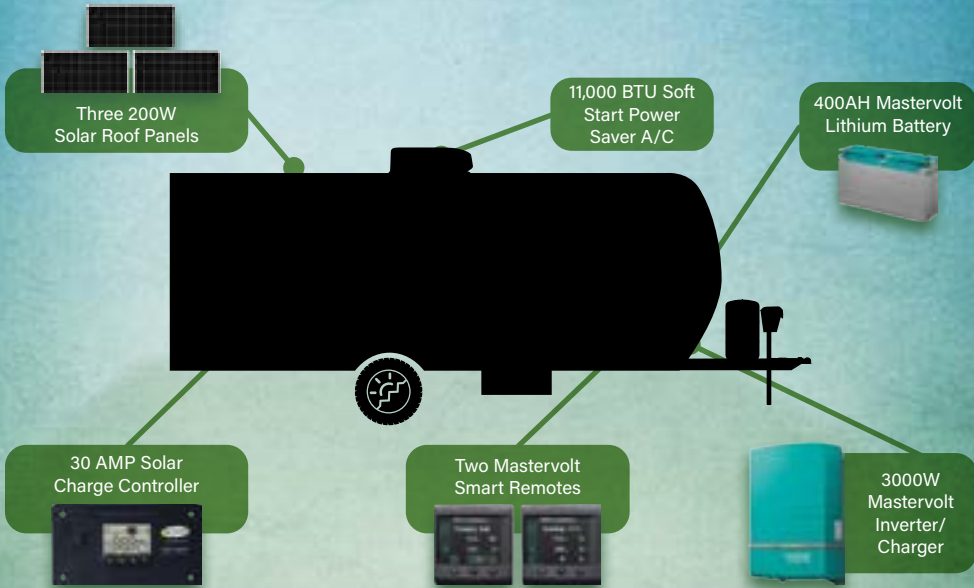

## ONLY AVAILABLE ON

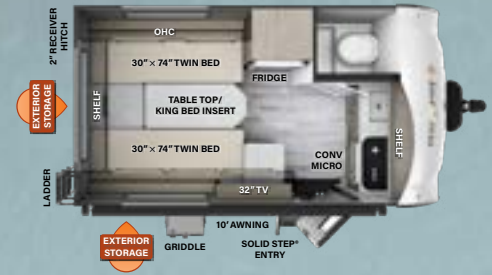
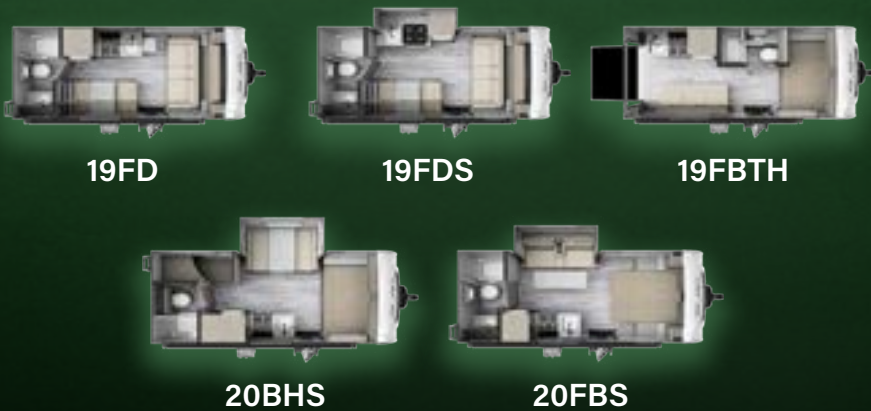

## G15TB

LENGTH: 15' 8" WIDTH: 7' 8" HEIGHT: 9' 10" HITCH: 357 AXLE: 2272

TWIN BED

UVW: 2667 CCC: 1210 F 31 GAL G 12 GAL B 12 GAL

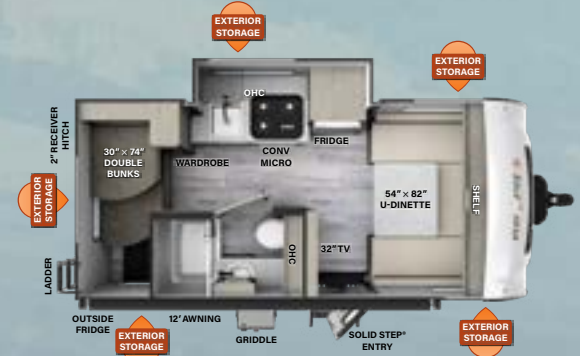

## G16BH

LENGTH: 18' 6" WIDTH: 7' 8" HEIGHT: 9' 10" HITCH: 486 AXLE: 2756

BUNK HOUSE

UVW: 3280 CCC: 1206 F 31 GAL G 27 GAL B 27 GAL



## G19FD

LENGTH: 20' 2" WIDTH: 7' 8" HEIGHT: 9' 10" HITCH: 409 AXLE: 2786

MURPHY BED

UVW: 3233 CCC: 1176 F 31 GAL G 27 GAL B 27 GAL



Murphy Bed G19FD



Living Area/Bedroom G20FBS



Kitchen G20FBS



G19FD Kitchen/Dinette



G19FD Bathroom



## G19FBS

FRONT BED

LENGTH: 20' 2" WIDTH: 7' 8" HEIGHT: 9' 10" HITCH: 479 AXLE: 2858

UVW: 3375 CCC: 1104 **F** 31 GAL **G** 27 GAL **B** 27 GAL

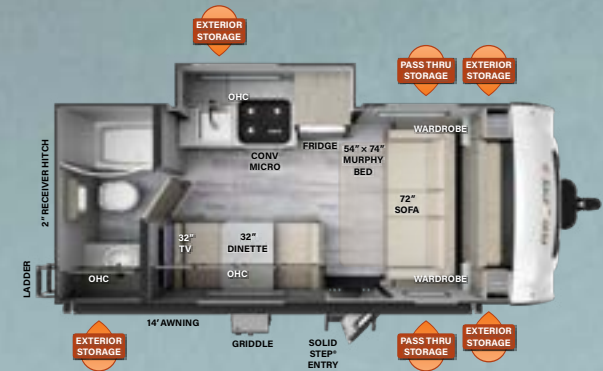

## G19FDS

MURPHY BED

LENGTH: 20' 2" WIDTH: 7' 8" HEIGHT: 9' 10" HITCH: 452 AXLE: 2870

UVW: 3360 CCC: 1092 **F** 31 GAL **G** 27 GAL **B** 27 GAL



## G19BH

BUNK HOUSE

LENGTH: 20' 2" WIDTH: 7' 8" HEIGHT: 9' 10" HITCH: 425 AXLE: 2746

UVW: 3209 CCC: 1216 **F** 31 GAL **G** 27 GAL **B** 27 GAL

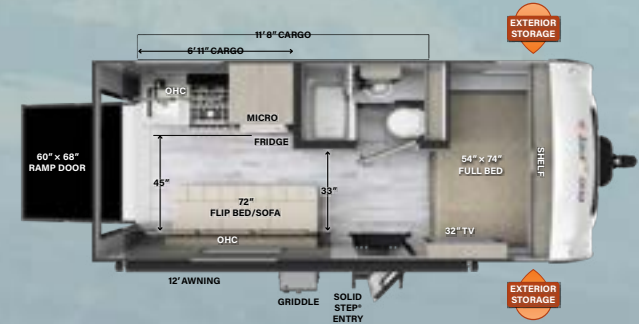

## G19FBTH

TOY HAULER

LENGTH: 20' 2" WIDTH: 7' 8" HEIGHT: 10' HITCH: 581 AXLE: 2814

UVW: 3433 CCC: 1498 **F** 31 GAL **G** 16 GAL **B** 27 GAL



## G20BHS

BUNK HOUSE

LENGTH: 21' 2" WIDTH: 7' 8" HEIGHT: 10' HITCH: 495 AXLE: 3014

UVW: 3513 CCC: 948 **F** 31 GAL **G** 27 GAL **B** 27 GAL

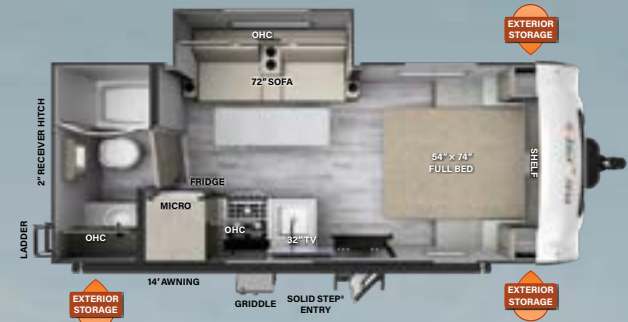

## G20FBS

FRONT BED

LENGTH: 21' 2" WIDTH: 7' 8" HEIGHT: 10' HITCH: 400 AXLE: 3004

UVW: 3442 CCC: 958 **F** 31 GAL **G** 27 GAL **B** 27 GAL

# Rockwood Warranty. Our Promise.

FOR DETAILS ON ROCKWOOD'S COMPLETE WARRANTY PROGRAM, SEE YOUR ROCKWOOD DEALER.

When it comes to backing products with the same quality and commitment it does when it begins the manufacturing process, the only name you have to remember when you're looking for a recreational vehicle is Rockwood. Rockwood offers the following additional limited warranties to the original purchasers. Consult written warranty for details.

**1** Eighteen-year roofing warranty

**2** Two-year fiberglass warranty.

**3** Ten-year Torflex® axle warranty.

**4** One-year bumper to bumper warranty.



## 24/7 EMERGENCY ROADSIDE ASSISTANCE WITH VEHICLE PURCHASE\*

TOWING  
JUMP-STARTS  
TIRE CHANGES  
FLUID DELIVERY  
LOCKOUT  
SERVICE

WINCH-OUT  
MOBILE MECHANIC  
TECHNICAL  
SUPPORT  
DEALER LOCATOR  
SERVICES



\*VALID FOR 1 YEAR FROM DATE OF PURCHASE



## PRE-DELIVERY INSPECTION FACILITY

20,000 square feet of quality assurance. The bare essentials for a premium product. This state-of-the-art facility gives immediate daily feedback to production for quality assurance in every unit built.

## CUSTOMER SATISFACTION



[www.ForestRiverBuyLocal.com](http://www.ForestRiverBuyLocal.com)

**FREE MEMBERSHIP**  
to Forest River Owners' Group

[www.forestriverfrog.com](http://www.forestriverfrog.com)



## Specification Definitions

**GVWR (Gross Vehicle Weight Rating):** is the maximum permissible weight of the unit when fully loaded. It includes all weights, inclusive of all fluids, cargo, optional equipment and accessories. For safety and product performance do NOT exceed the GVWR.  
**GAWR (Gross Axle Weight Rating):** is the maximum permissible weight, including cargo, fluids, optional equipment and accessories that can be safely supported by a combination of all axles. **UVW (Unloaded Vehicle Weight):**<sup>1</sup> is the typical weight of the unit as manufactured at the factory. It includes all weight at the unit's axle(s) and tongue or pin and LP Gas. The UVW does not include cargo, fresh potable water, additional optional equipment or dealer installed accessories. **CCC (Cargo Carrying Capacity):**<sup>1</sup> is the amount of weight available for fresh potable water, cargo, additional optional equipment and accessories. CCC is equal to GVWR minus UVW. Available CCC should accommodate fresh potable water (8.3 IWW per gallon). Before filling the fresh water tank, empty the black and gray tanks to provide for more cargo capacity. Each Forest River RV is weighed at the manufacturing facility prior to shipping. A label identifying the unloaded vehicle weight of the actual unit and the cargo carrying capacity is applied to every Forest River RV prior to leaving our facilities. The load capacity of your unit is designated by weight, not by volume, so you cannot necessarily use all available space when loading your unit.

All information contained in this brochure is believed to be accurate at the time of publication. However, during the model year, it may be necessary to make revisions and Forest River, Inc., reserves the right to make all such changes without notice, including prices, colors, materials, equipment and specifications as well as the addition of new models and the discontinuance of models shown in this brochure. Therefore, please consult with your Forest River dealer and confirm the existence of any materials, design or specifications that are material to your purchase decision.

<sup>1</sup> Estimated Average based on standard build optional equipment

Look for our other popular lines of Rockwood trailers.



ROCKWOOD FIFTH WHEELS



ROCKWOOD TRAVEL TRAILERS



ROCKWOOD TENT CAMPERS



Learn More  
Scan this barcode using  
a QR Reader on your  
smart phone to learn  
more about Forest River.



A Berkshire Hathaway company.

201 WEST ELM MILLERSBURG, IN 46543  
WWW.FORESTRIVERINC.COM/ROCKWOOD  
574.642.2640

YOUR **ROCKWOOD** DEALER



FOLLOW THE JOURNEY



@RockwoodRvs