

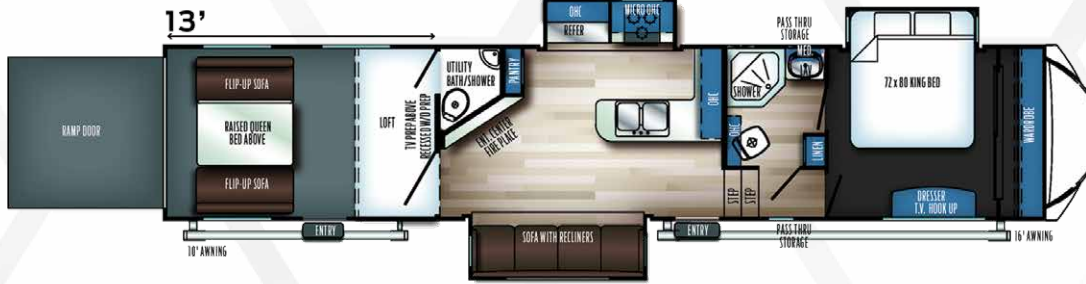

SCAN QR CODE
TO LEARN MORE ABOUT
ROGUE ARMORED
5TH WHEEL TOY HAULERS



FIFTH WHEEL TOY HAULERS



351G2
Actual Length: 45' 1"
Dry Weight: 13,000 lbs.

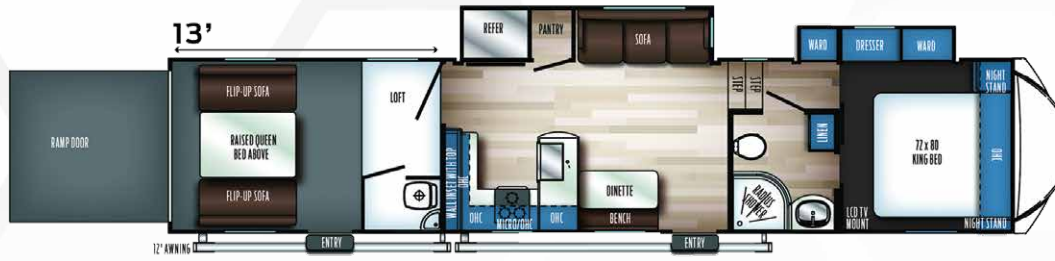

371A13
Actual Length: 43' 4"
Dry Weight: 12,764 lbs.



383G2
Actual Length: 45' 1"
Dry Weight: 13,219 lbs.



4007G2
Actual Length: 45' 4"
Dry Weight: 13,174 lbs.

TOY HAULER STANDARD BUILD: FEATURES AND OPTIONS

EQUIPMENT

- One control phone app for lights, slides, and awnings
- Roof mounted solar ready
- 7,000 lb. axles
- 16" Aluminum wheels
- On Demand Tankless Water Heater
- 50AMP service with detachable power cord
- Four Point Backup/Observation Camera ready
- Two 15,000 BTU A/Cs "Super H Ducted"
- Heated enclosed holding tanks
- 158 Gallon fresh tank capacity

GARAGE

- Quick Set garage bed system
- Flip up garage sofas w/ table
- 5,000 lb. tie downs mounted thru steel chassis plates
- DuraPoxy® gas/oil resistant flooring
- Solid Seal glass vapor door
- Rear screen wall
- Ram air vents (2)
- Power fan roof vent
- 3,000 lb. rated ramp door
- Ducted A/C, ducted heat
- Washer/dryer ready
- Half bath or Utility Bath in Garage

INTERIOR

- 16 Cu. Ft. 12 volt black glass residential-style refrigerator
- 30" Microwave
- 3 Burner range w/oven
- Solid surface countertops
- Zebra Shades in living areas
- Recliner sofas w/ heated seats, LED lights, and massage
- LED puck lighting throughout
- Black Glass entry doors
- Bluetooth stereo system
- Multiple USB charging stations
- Black stainless steel farm sink
- Pull down spray faucet
- Spa shower in master bath
- Glass shower surround
- Porcelain foot flush toilets
- Power adjustable king bed
- Skylight over shower
- Power vent fan in master bath
- Loft bunk ladder

SAFETY

- Fire extinguisher
- Smoke detector
- LP detector
- CO2 detector
- Emergency breakaway switch

EXTERIOR

- 102" Wide body construction
- Aluminum frame sidewalls
- Vacuum bonded sidewalls
- Fiberglass front cap with lights
- Generator prep with start/stop switch, and hour meter & fuel gauge
- 30 Gal. fuel station
- 6-Point automatic leveling system
- Ramp door patio system
- Spare tire & carrier
- Dual LED ramp cargo lights
- Exterior compartment lights
- LED brake/tail lights
- Solar Reflective windows
- Dual power awnings w/LED lights
- LP quick connect
- Tire Pressure Monitor System
- Outside shower
- Radius PVC walk on roof

OPTIONS

- 5500 Watt NPC generator
- Ramp patio step w/ wall mount
- Power Pack Solar/Inverter system
- Juice Pack 100 Watt solar system with battery and controller
- Juice Pack Expansion 100 Watt solar panel

All information contained in this brochure is believed to be accurate at the time of publication.

However, during the model year, it may be necessary to make revisions and Forest River, Inc. reserves the right to make all such changes without notice, including prices, colors, materials, equipment and specifications as well as the addition of new models and the discontinuance of models shown in this brochure.

Therefore, please consult with your Forest River dealer and confirm the existence of and materials, design or specifications that are material to your purchase decision.

For more information visit:
www.forestriverinc.com/Rogue



Learn More
Scan this barcode using
a QR Reader on your
smart phone to learn
more about Forest River.



A Berkshire Hathaway company.

SPECIFICATIONS	351	371	383	4007
Dry Hitch Weight	3,435 lb.	2,685 lb.	3,300 lb.	3,100 lb.
Unloaded Vehicle Weight	13,000 lb.	12,764 lb.	13,219 lb.	13,174 lb.
Axle Weight	10,079 lb.	9,919 lb.	10,074 lb.	10,074 lb.
GVWR w/Brakes	17,435 lb.	16,685 lb.	17,300 lb.	17,100 lb.
Cargo Carrying Capacity	4,042 lb.	3,921 lb.	4,081 lb.	3,926 lb.
Exterior Length	45' 1"	43' 4"	45' 1"	45' 4"
Exterior Height w/ AC	13' 4"	13' 4"	13' 4"	13' 4"
Exterior Width	102"	102"	102"	102"
Fresh Capacity	158 gal.	158 gal.	158 gal.	158 gal.
GreyCapacity	100 gal.	100 gal.	100 gal.	100 gal.
Black Capacity	40 gal.	40 gal.	40 gal.	40 gal.
Rear Bath Tank Capacity	40 gal.	40 gal.	40 gal.	40 gal.
Awning Size	10' & 16'	12' & 18'	12' & 15'	12' & 18'