

## EXTERIOR FEATURES

- 8" I Beam Steel Mains - Basement Frame
- Detachable Hitch
- Corrosion Resistant Poly Underbelly
- 2" X 6" Transverse Floor Joist 16" on Center
- Central Floor Heat Duct
- 5/8" Tongue and Groove Plywood Floor Decking
- Roof Decking with Felt Paper
- Fiberglass Shingles with 30 Year Warranty
- Permanent 5" Soffit - Sidewalls
- R-22 Fiberglass Insulation with Vapor Barrier
- Truss Rafters
- 2" X 4" Sidewall Studs 16" on Center
- 7' 6" Sidewall Height
- Rear Door with Screen and Deadbolt Lock
- Vinyl Siding with Lifetime Warranty
- OSB Sheathing with Weather Wrap
- 110V Recept at City Water Fill
- Residential Style Shutters\*

## LIVING AREA

- Sofa Hide-a-Bed and Swivel Rocker
- Stain Resistant Carpet with Pad
- Vertical Blind at Patio Door
- Decorator Valances
- 6 Panel Interior Doors
- Ceiling Fan w/Light Kit (1)
- Large Entertainment Center with TV Jack\*
- Residential Trim (All Windows)
- Decor Coordinated Wall Panels

## KITCHEN/DINING AREA

- 17 cu. ft. -2 Door Frost Free- White
- 30" or 24" Range - White\*
- Spacemaster® Microwave\*
- Solid Wood Cabinet Doors
- Laminated Counter Top Self-Edged with Back Splash
- Stainless Steel Kitchen Sink
- Drop Leaf Table with 4 Chairs
- Dinette Chairs with Lumbar Support
- "No Wax" Vinyl Floor
- Drawers with Rollers
- GFI Receptacle
- Track Lighting in Kitchen

## BATH AREA

- 1-Piece Fiberglass Tub/Shower with Shower Curtain
- Residential Style Ceramic Commode
- Power Exhaust Fan with Light
- Custom Hardwood Medicine Cabinet
- GFI Receptacle
- High Pressure Laminated Vanity Top with Back Splash
- Large Sink with Faucet
- Linen Cabinet\*
- Residential Style Bath Accessories

## BEDROOM AREA

- 60" X 75" Box Spring and Mattress with Metal Frame\*
- Spacious Wardrobes with Drawers Below
- Chest of Drawers\*
- Egress Window
- Mirrored Wardrobe Doors
- Ceiling Fan with Light\*

## ADDITIONAL FEATURES

- 50 Amp Electrical Service with Power Cord
- 20 Gal. Electric Water Heater with Exterior Door
- 56,000 BTU Furnace Electronic Ignition\*
- Fire Extinguisher
- Exterior GFI Receptacle and Cover
- 2 Exterior Porch Lights
- LP Gas Line
- Touch Control Wall Switches
- Copper Wiring
- Hurricane Tie Downs Straps
- CSA Z241 Seal
- Smoke Detector
- Cove Ceiling Trim
- Seaspray Ceiling Board
- LP Detector\*

## OPTIONAL FEATURES

- A/C 15,000 BTU Floor Ducted
- Water Heater, 10 Gal. Gas DSI
- Bedspread
- Nightstand and Lamp
- End Table and Lamp
- Metal Underbelly
- Rear Loft\*
- Front Trap Windows
- Dinette Bay
- Dining Room Hutch
- Home Theater System

\* Denotes where available

### 355FL

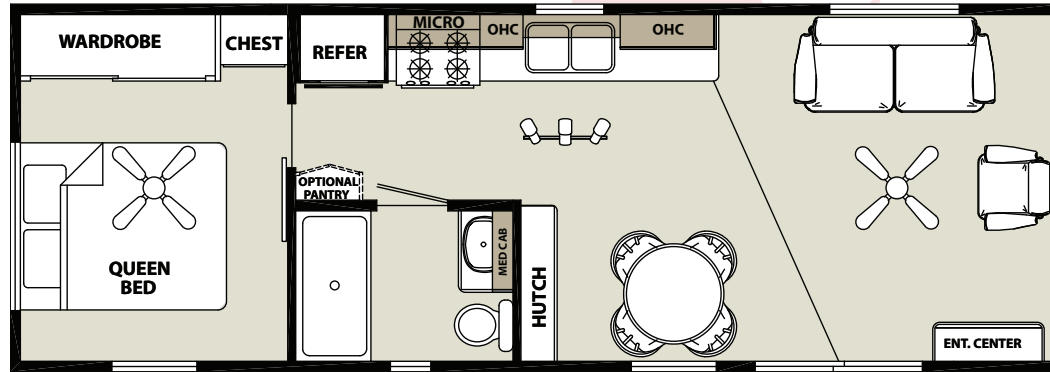

### 41BH

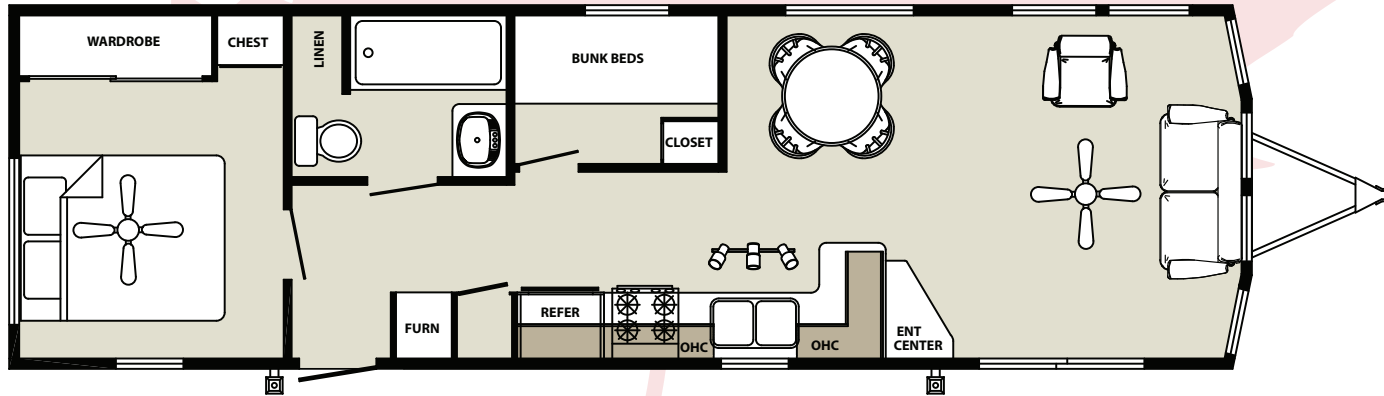

**Learn More**  
Scan this barcode using a QR Reader on your smart phone to learn more about Forest River.



A Berkshire Hathaway company.

Forest River, Inc.  
Park Model Division  
28936 Phillips St.  
Elkhart, IN 46514  
Phone: (574) 264-7613  
Fax: (574) 264-7364  
[www.forestriverinc.com](http://www.forestriverinc.com)  
[www.forestriveraccessories.com](http://www.forestriveraccessories.com)

All information contained in this brochure is believed to be accurate at the time of publication. However, during the model year, it may be necessary to make revisions and Forest River, Inc., reserves the right to make all such changes without notice, including prices, colors, materials, equipment and specifications as well as the addition of new models and the discontinuance of models shown in this brochure. Therefore, please consult with your Forest River dealer and confirm the existence of any materials, design or specifications that are material to your purchase decision.