





LIMITED EDITION FLOORPLANS

TANDEM AXLES



2300RBL
LENGTH: 28' 5"
UVW: TBD

SINGLE AXLES



1610RBL
LENGTH: 20' 1"
UVW: 2889 LBS



2400BHL
LENGTH: 29' 4"
UVW: TBD



1620BHL
LENGTH: 20' 1"
UVW: 2809 LBS



2600BSL
LENGTH: 32' 7"
UVW: TBD



SINGLE AXLE FLOORPLANS

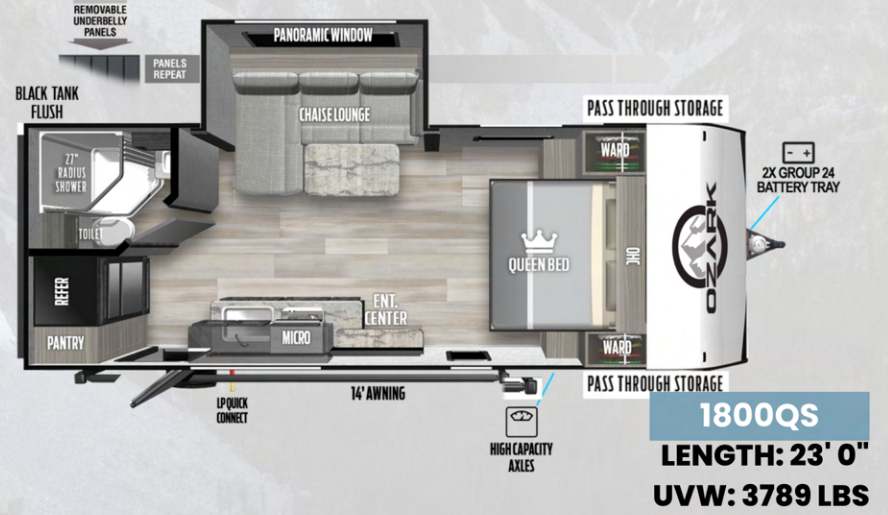
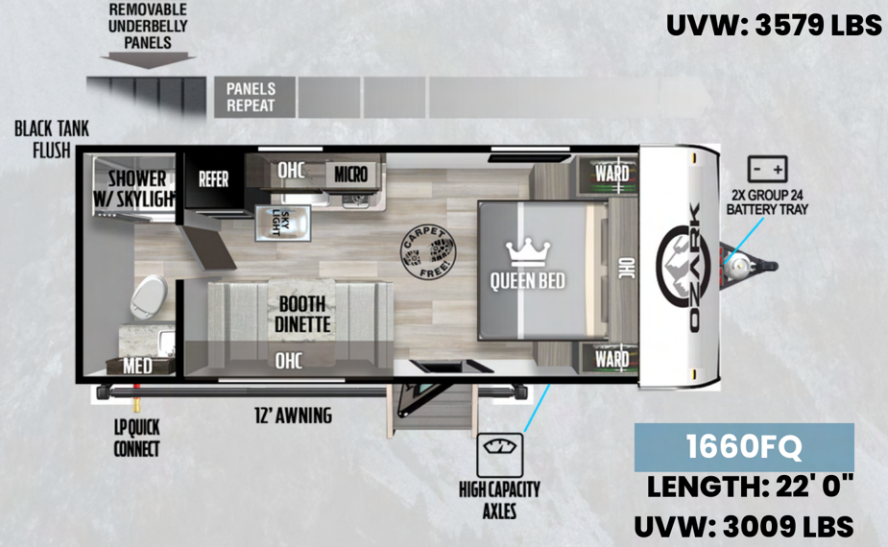
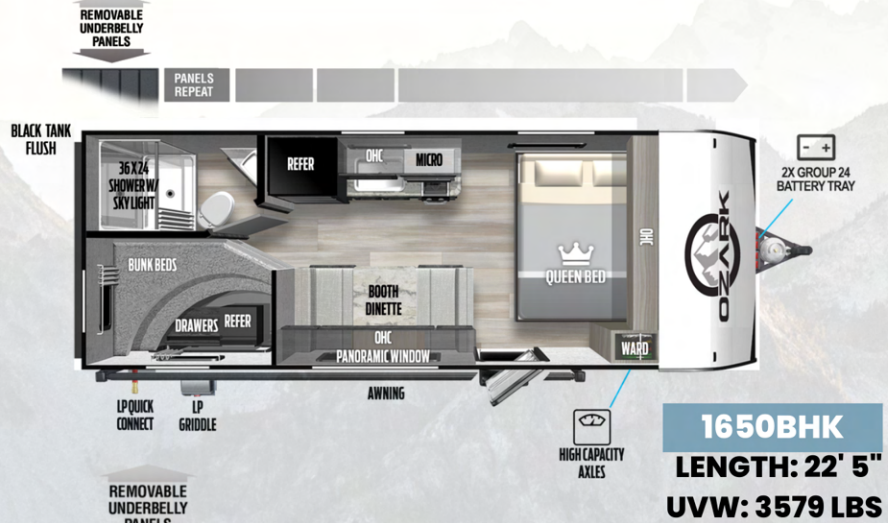
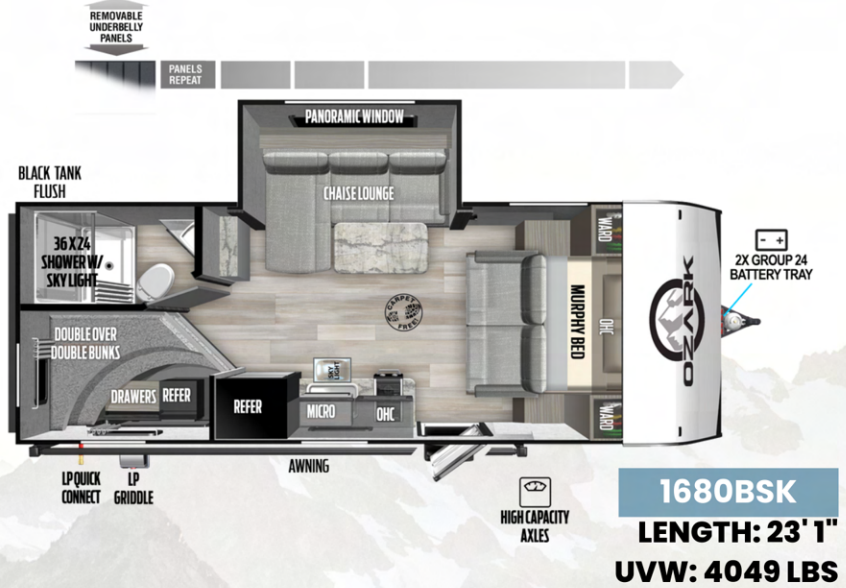



TANDEM AXLE FLOORPLANS

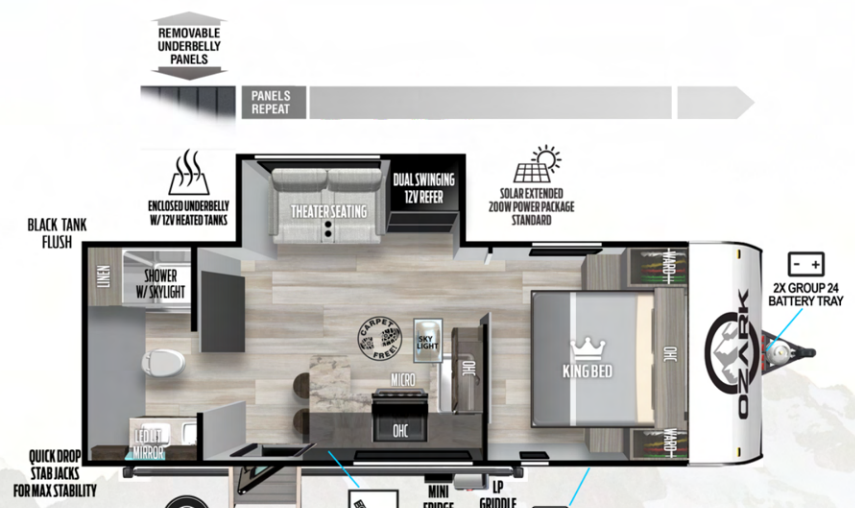

2430RBK
LENGTH: 26' 1"
UVW: 5578 LBS

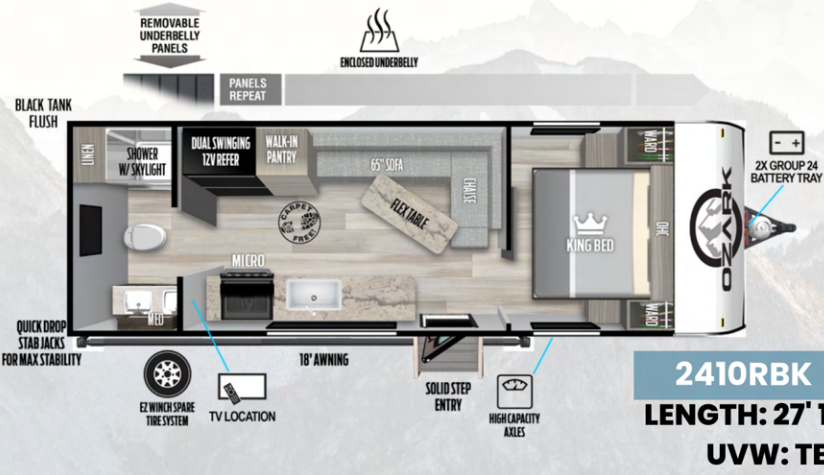

2410RBK
LENGTH: 27' 11"
UVW: TBD

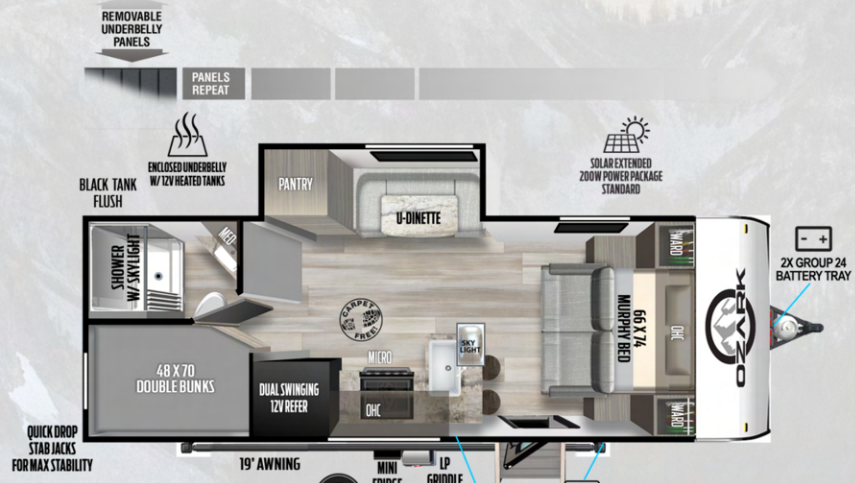

2440BHK
LENGTH: 26' 1"
UVW: 5752 LBS

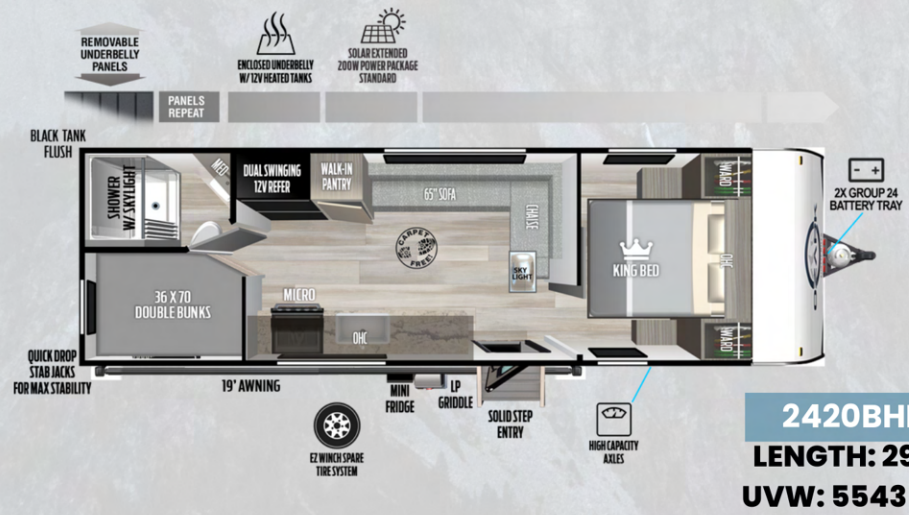

2420BHK
LENGTH: 29' 11"
UVW: 5543 LBS



TANDEM AXLE FLOORPLANS

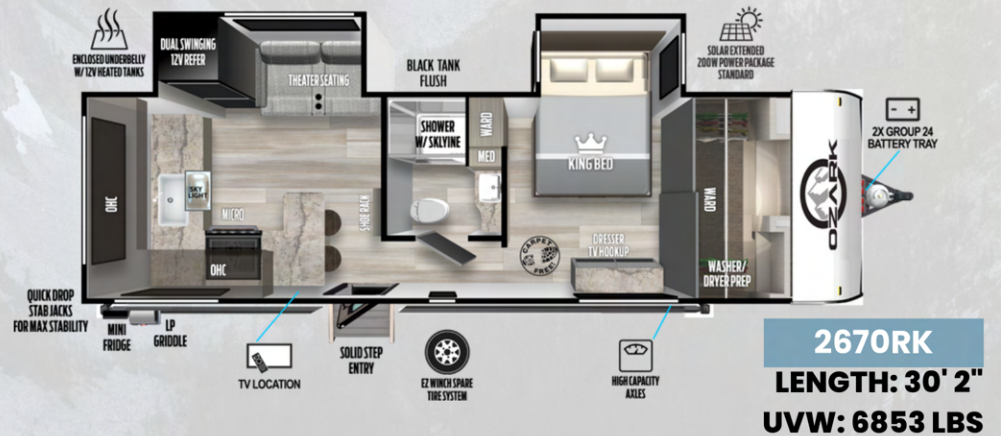
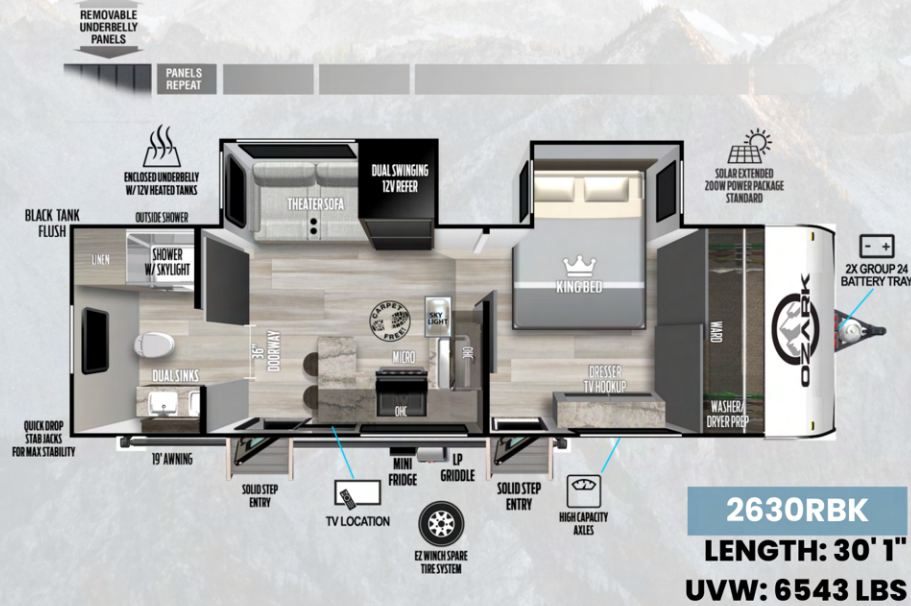
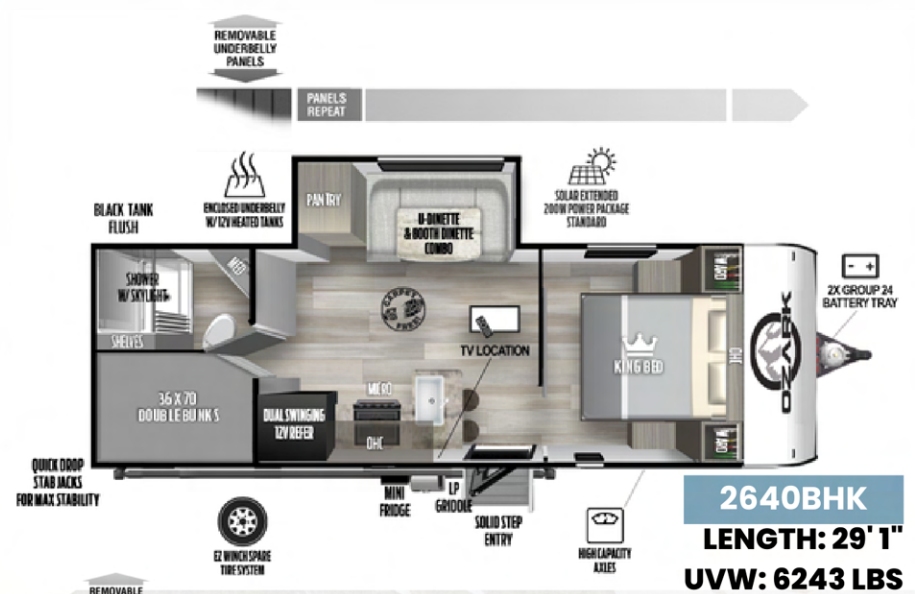



TOY HAULER FLOORPLANS

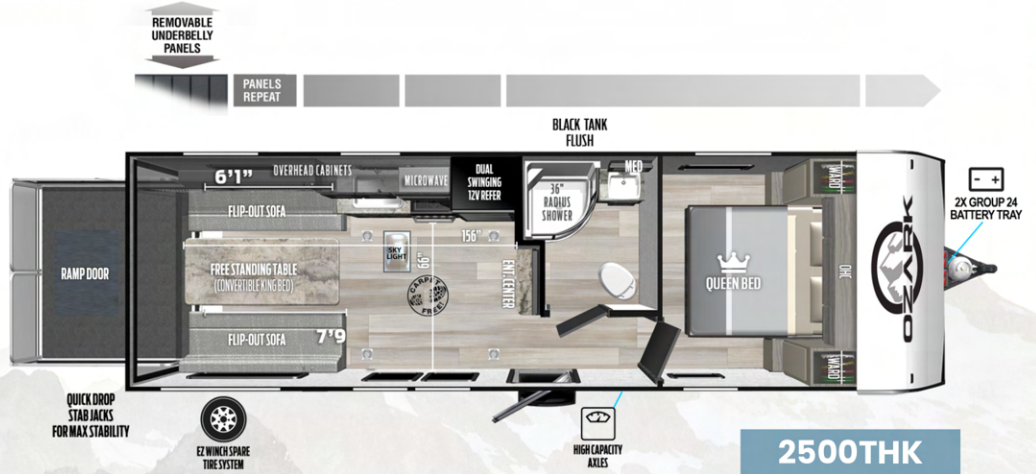

2500THK
LENGTH: 28' 8"
UVW: 4913 LBS

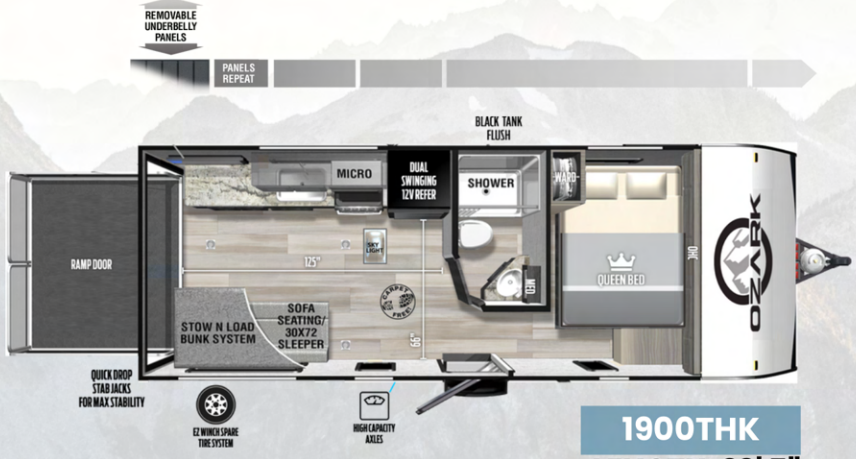

1900THK
LENGTH: 23' 5"
UVW: 4359 LBS

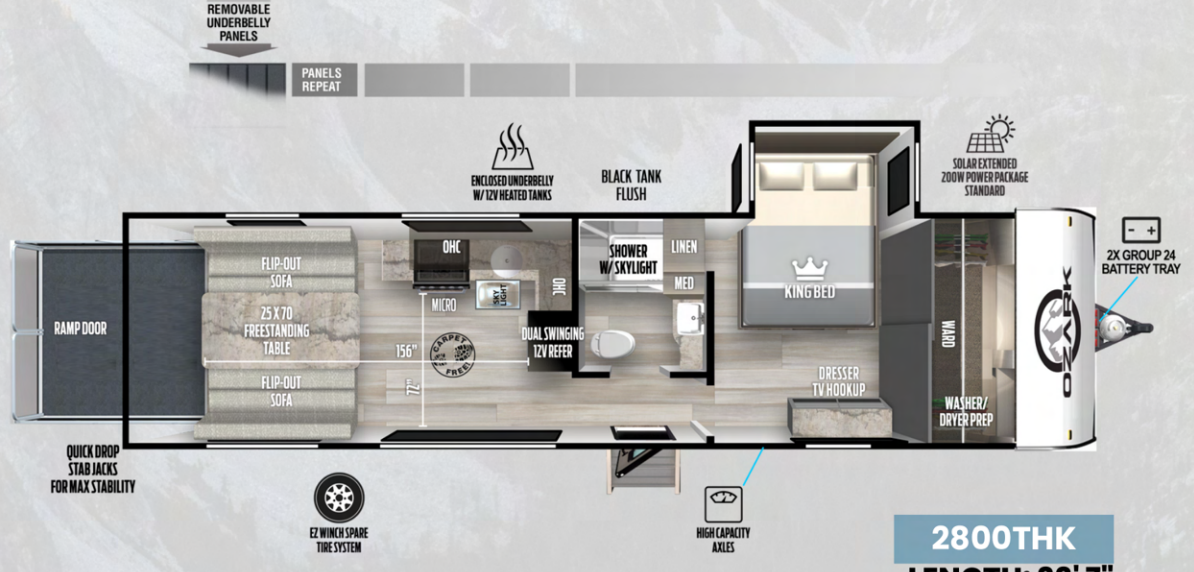

2800THK
LENGTH: 33' 7"
UVW: 7188 LBS



**ELEVATE YOUR
EXPECTATIONS**

For the most recent
specs, pictures, and 360
tours visit
forestriverinc.com/ozark
or
Scan QR Code below





Your Ozark Dealer

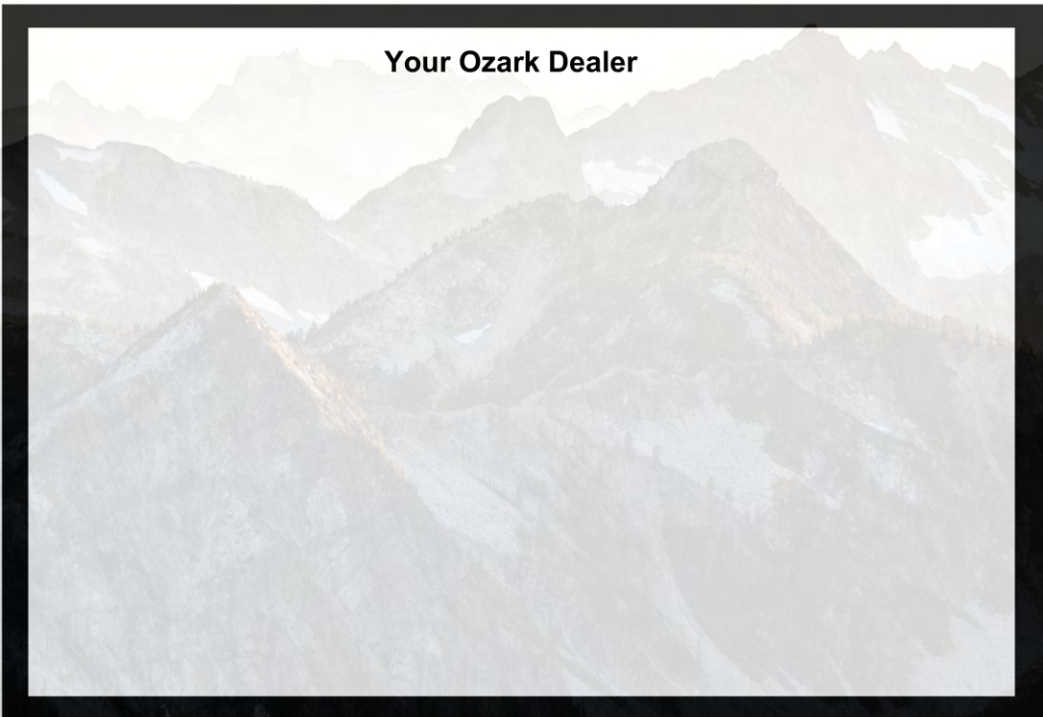

For the most recent specs, pictures, and 360 tours visit forestriverinc.com/ozark or Scan QR Code below



@ozarkbyforestriver



@OzarkRV

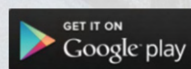
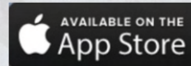

Download the Forest River mobile app or visit our dynamic online manual to enhance your ownership experience. These interactive options provide incredible ease and insight into use, maintenance and enjoyment of your Forest River product. From "How-To" videos, pictures and illustrations of various components, systems and features, to fully searchable content and downloadable PDFs for individual component owner's manuals, answers are always just a click away



UVW (Unloaded Vehicle Weight)* is the typical weight of the unit as manufactured at the factory. It includes all weight at the unit's axle(s) and tongue or pin and LP Gas. The UVW does not include cargo, fresh potable water, additional optional equipment or dealer installed accessories. Estimated Average based on standard build optional equipment. CCC (Cargo Carrying Capacity) is the amount of weight available for fresh potable water, cargo, additional optional equipment and accessories. CCC is equal to GVWR minus UVW. Available CCC should accommodate fresh potable water (8.3 lbs per gallon). Before filling the fresh water tank, empty the black and gray tanks to provide for more cargo capacity. Estimated average based on standard build optional equipment. See back page for additional specification definitions. GVWR (Gross Vehicle Weight Rating) - is the maximum permissible weight of the unit when fully loaded. It includes all weights, inclusive of all fluids, cargo, optional equipment and accessories. For safety and product performance do NOT exceed the GVWR. GAWR (Gross Axle Weight Rating) is the maximum permissible weight, including cargo, fluids, optional equipment and accessories that can be safely supported by a combination of all axles. Each Forest River RV is weighed at the manufacturing facility prior to shipping. A label identifying the unloaded vehicle weight of the actual uAll information contained in this brochure is believed to be accurate at the time of publication. However, during the model year, it may be necessary to make revisions and Forest River, Inc., reserves the right to make all such changes without notice, including prices, colors, materials, equipment and specifications as well as the addition of new models and the discontinuance of models shown in this brochure. Therefore, please consult with your Forest River dealer and confirm the existence of any materials, design or specifications that are material to your purchase decision. © 2023 Ozark, a Division of Forest River, Inc., a Berkshire Hathaway company. All Rights Reserved