

CEDAR CREEK

2025 **WIDEBODY** FLOORPLANS



361RL / PEBBLE FURNITURE



361RL / PEBBLE FURNITURE



361RL / PEBBLE FURNITURE



FOREST RIVER

FORESTRIVERINC.COM



OUR ELITE FLEET OF STYLES

Cedar Creek is dedicated to enhancing the joy of the outdoors and your peace of mind, by building better quality recreational vehicles designed to withstand rugged road conditions and extreme temperatures. Experience Cedar Creek and see where the road leads, and enjoy what life has to offer!



361RL

HITCH WEIGHT	GVWR	UVW	CCC	LENGTH	HEIGHT	WIDTH
2,505 lb.	16,505 lb.	14,190 lb.	2,396 lb.	40' 9"	13' 5"	101"

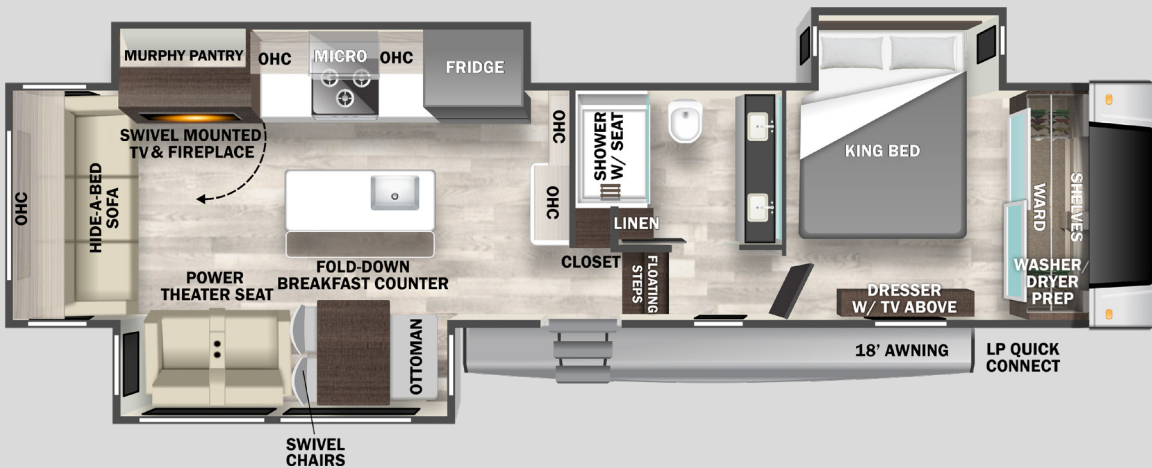

370FL

HITCH WEIGHT	GVWR	UVW	CCC	LENGTH	HEIGHT	WIDTH
2,685	16,685	14,694	1,991	41' 5"	13' 5"	101"

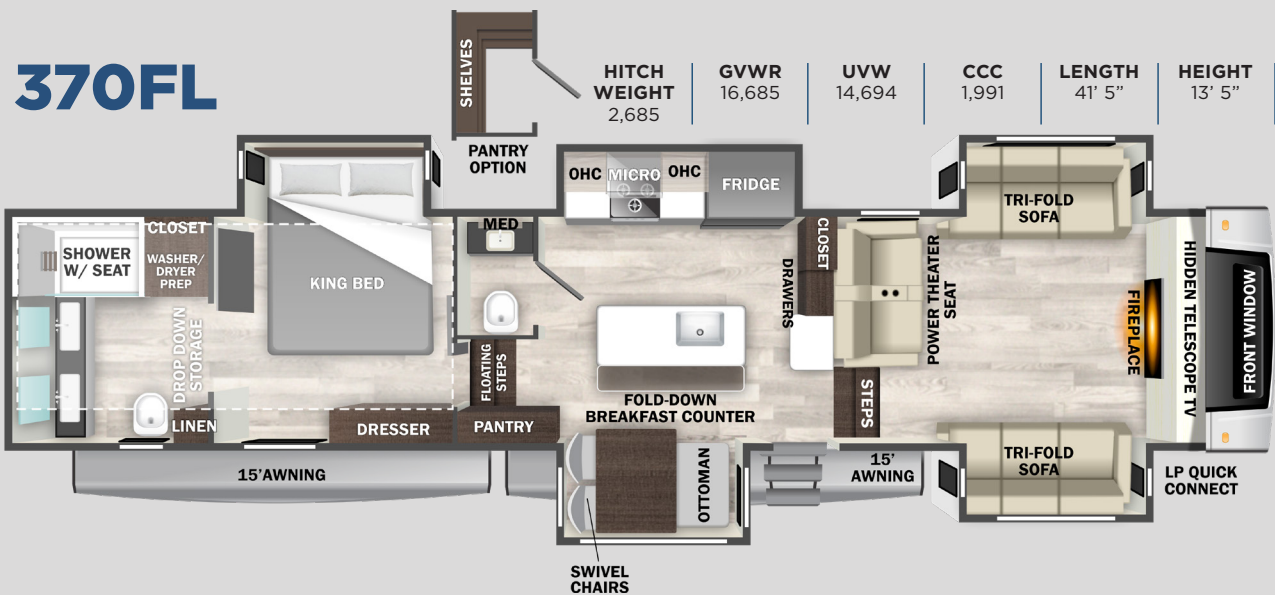

379BHO

HITCH WEIGHT	GVWR	UVW	CCC	LENGTH	HEIGHT	WIDTH
2,495 lb.	17,995 lb.	15,114 lb.	2,881 lb.	43'2"	13' 5"	101"

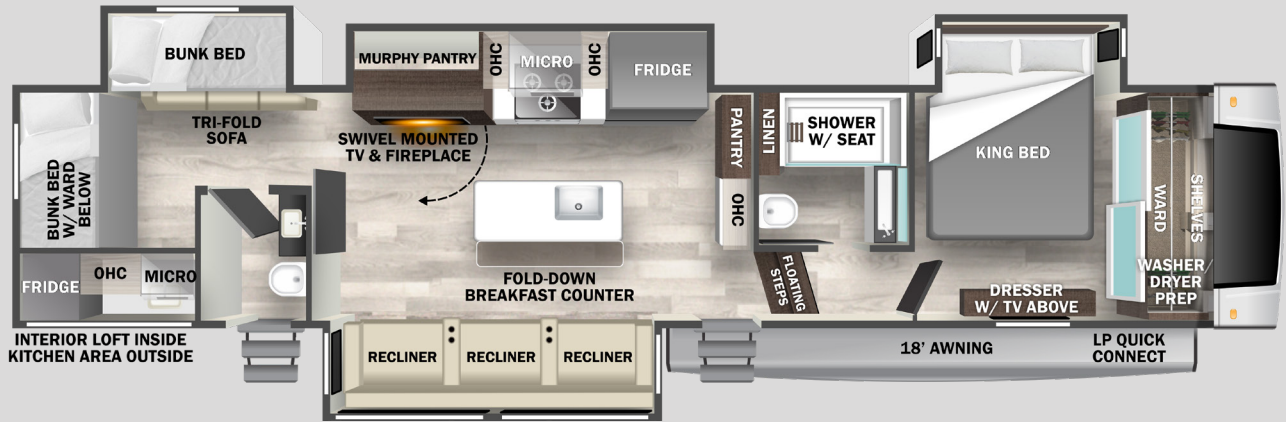

381MUD

HITCH WEIGHT	GVWR	UVW	CCC	LENGTH	HEIGHT	WIDTH
2,490 lb.	18,000 lb.	15,429 lb.	2,571 lb.	43' 5"	13' 5"	101"

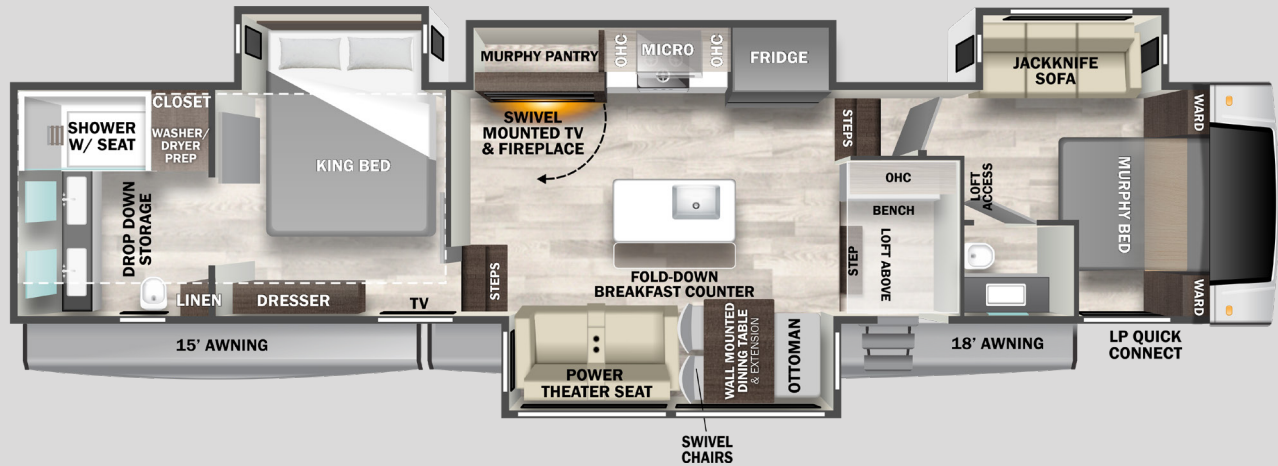

395WOW

HITCH WEIGHT	GVWR	UVW	CCC	LENGTH	HEIGHT	WIDTH
2,445 lb.	18,000 lb.	14,859 lb.	3,171 lb.	43' 2"	13' 5"	101"



FIFTH WHEEL TOP FEATURE HIGHLIGHTS

EXTERIOR

- New 101" Wide Body Frame
- "True" Gelcoat Exterior (The Best of the Best in Exteriors)
- True Gelcoat, Painted, Front Cap
- Cedar Creek's Famous All Aluminum Superstructure on 16" Centers or less
- 3M® Bonded Sidewalls—Resilient, they grow stronger with age. They also have outstanding resistance to UV, heat, cold, moisture, oils, gasoline, and highway chemicals, which creates a bond that cannot delaminate with time.
- 6-Point Hydraulic – GEN 3 Leveling System w/Accent Lights
- 21,000 LB. Rhino Box Hitch
- Hehr Frameless, Tinted Automotive Style Windows
- Z-frame with Black Textured Metal Wrapped Skirting to the Frame
- TST™ Tire Pressure Monitoring System
- Metal Wrap Frame Cover
- Mid-Ship Turn Signals
- New Ultra Slim Rear Brake Lights
- "7,000# Axles on 36", 8000# Axles on 37" with ABS Electronic Brakes"
- Lionshead Special Trailer (ST) Tires "No Excuses" One-Year Guarantee! Goodyear Tires on 7K Axles and Cooper Tires on 8K Axles
- 4' x 6' ABS, Ribbed, Removable Underbelly Panels
- Animal Leash Latch
- Full, Walk-on Roof with AlphaPly TPO with Lifetime Warranty
- Motion Lights in Outside Storage Areas and Front Storage Area
- Road Warrior™ Suspension with Wet Bolts and Bronze Bushings
- Wired for a 3rd AC
- Wired for Furrion® Rear Observation Camera
- 12 Volt Heating Pads on All Black, Grey, & Fresh Water Tanks
- Heated Front Storage Compartment w/ Motion Lighting

INTERIOR

KITCHEN / LIVING ROOM

- 19.6 cu. Ft., Glass Front, 12v. Refrigerator with Icemaker
- 3 Burner Gas Oven with Pull Out Pan Drawer
- Flush Floor Slides in Kitchen and Living Area
- Suburban ST-60 60,000 BTU Tankless Water Heater

- Residential Kitchen Island with Solid Surface Counter with Flush Mount, Stainless Steel, Work Station Sink
- Breakfast Flip-Up Countertop in Island
- Cordless Sweeper
- Murphy Pantry (N/A 370FL)
- New Pull out Caddy in the Kitchen
- Residential Dovetail, Self-Closing Drawers, and Hidden Hinge Cabinet Doors
- Stainless Steel, 30" Over the Range Microwave with updated Backsplash
- Under Island Pullout Caddy & Baking Tray Storage
- Cutting Board Drawer with Cut-out Trash funnel
- Power Fan with Rain Sensor Override in Kitchen
- Vinyl Floor Covering
- Wall Mounted Walnut table with (2) chairs, Storage Ottoman, Table Extension, and Hidden Silverware Drawer
- Walnut / Two Tone Wooden Cabinets and Fascias
- Day / Night Roller Shades
- Power Theater Seating w/ USB charging ports
- Luxury Hide-a-Bed Sofa

INTERIOR

BATHROOM / BEDROOM

- Redesigned 48" x 30" Rectangular shower with a fold-down wooden bench, sliding glass doors, and Upgraded Shower Head
- Large Double Sink Bath Vanity with Solid Surface Countertop (Where Applicable)
- 18" High Porcelain Toilet with Top Circular Flush System
- Create-A-Breeze Circulation Fan
- Extra Storage for Linens
- LED Night Motion Lighting under the Vanity
- Flip-Up Dresser Top with hidden storage
- Black-Out Night Shades
- Prepped for an Optional Washer and Dryer

ELECTRONICS

- "Vegatouch® Control Panel and Firefly dimmer switches with wireless connectivity to your phone.
- 50" Smart Television w/Swing Arm (370FL on TV Lift)
- 32" Smart Television in the BR
- 12v. Bluetooth Stereo Speaker

- (2) Exterior Satellite & Cable Hook-Ups to Bedroom and LR
- New CradlePoint Wifi/5G Antenna and Day 1 Connectivity
- Pre-Wired for Satellite to the Roof

AVAILABLE OPTIONS

- 12' Power Awning on Dining Slide (N/A 370FL)
- Slide-Out Awning Toppers
- 21,000 LB CURT™ Air Ride Hitch Coupler
- 3rd AC with Power Management System
- 2ND "Rich Solar" 200 Watt Solar Panel
- LP Generator Prep
- 5.5K Onan Marquis Gold LP Generator w/LP Prep
- Cadet Wall Mounted Heater w/ Circulation Fan
- Fisher / Paykel Dishwasher Drawer in the Island (N/A 370FL, 381MUD, 379BHO)
- Dual Pane Frameless, Tinted Windows
- Full Body Paint Package (Onyx, Sapphire, Opal)
- Furrion Rear Observation or 4 Camera Security Systems
- Heat Pump on Main Air Conditioner
- King, Roof Mounted Satellite – My Dish RV Flexible Programming including local channels
- Lithium 200X Package (2 Lithium, 2 solar panels & Accessories)
- Lithium 480XL Package (4 Lithium, 4 Solar panels & Accessories)
- 30" Convection Microwave
- Splendide Side x Side, Washer / Dryer
- Upgraded Luxury King Bed

FABRIC CHOICES



CEDAR CREEK

FOREST RIVER INC. CEDAR CREEK DIVISION

501 Hawpatch Road • Topeka, IN 46571

Phone: 260-593-4013 • Parts & Service Phone: 260-593-4000



Visit our website at:

forestriverinc.com/cedar-creek

[@cedarcreekbyforestriver](https://www.instagram.com/cedarcreekbyforestriver)



Actual towing capacity is dependent on your particular loading and towing circumstances, which includes GVWR, GAWR and GCWR, as well as adequate trailer brakes. Please refer to the Owner's Manual of your vehicle for further information. All information contained in this brochure is believed to be accurate at the time of publication. However, during the model year, it may be necessary to make revisions and Forest River, Inc., reserves the right to make all such changes without notice, including prices, colors, materials, equipment and specifications as well as the addition of new models and the discontinuance of models shown in this brochure. Therefore, please consult with your Forest River dealer and confirm the existence of any materials, design or specifications that are material to your purchase decision. ©2024 Forest River, Inc., a Berkshire Hathaway company. All Rights Reserved. 8/24



FOREST RIVER

FORESTRIVERINC.COM