

# CEDAR CREEK EXPERIENCE

2025 WIDEBODY FLOORPLANS



FOREST RIVER

FORESTRIVERINC.COM

# 29RL

HITCH WEIGHT	GVWR	UVW	CCC	LENGTH	HEIGHT	WIDTH
2,525 lb.	16,525 lb.	11,894 lb.	4,631 lb.	35' 1"	13' 5"	101"

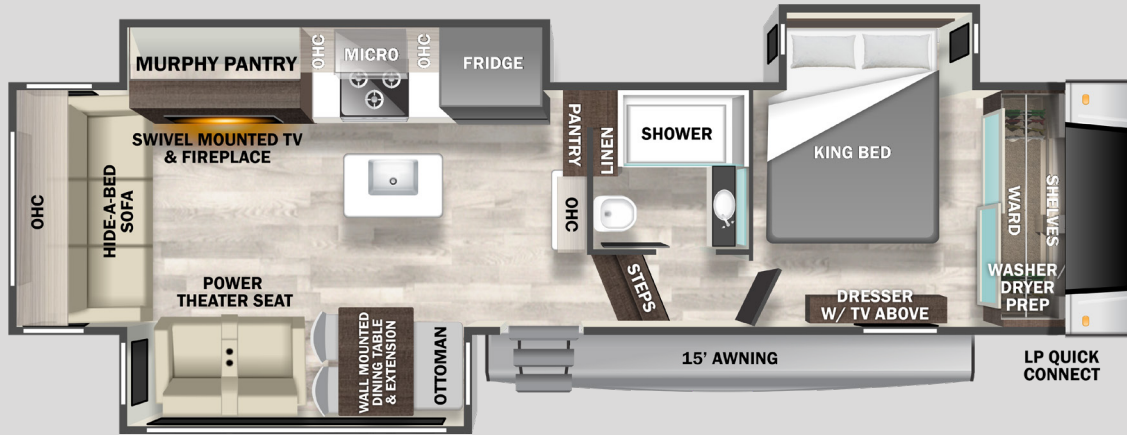

# 31RD

HITCH WEIGHT	GVWR	UVW	CCC	LENGTH	HEIGHT	WIDTH
2,150 lb.	16,150 lb.	11,939 lb.	4,211 lb.	35' 7"	13' 5"	101"

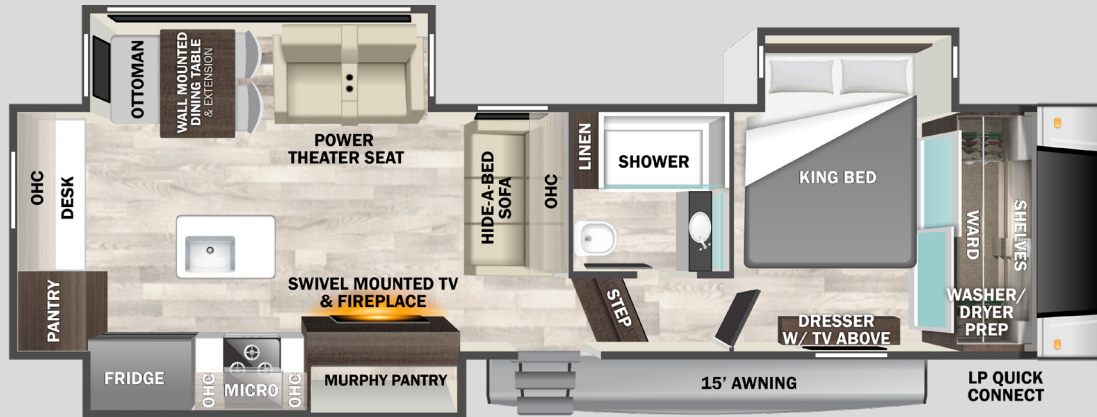

# 33BH

HITCH WEIGHT	GVWR	UVW	CCC	LENGTH	HEIGHT	WIDTH
2,296 lb.	16,296 lb.	13,380 lb.	2,915 lb.	39'	13' 5"	101"

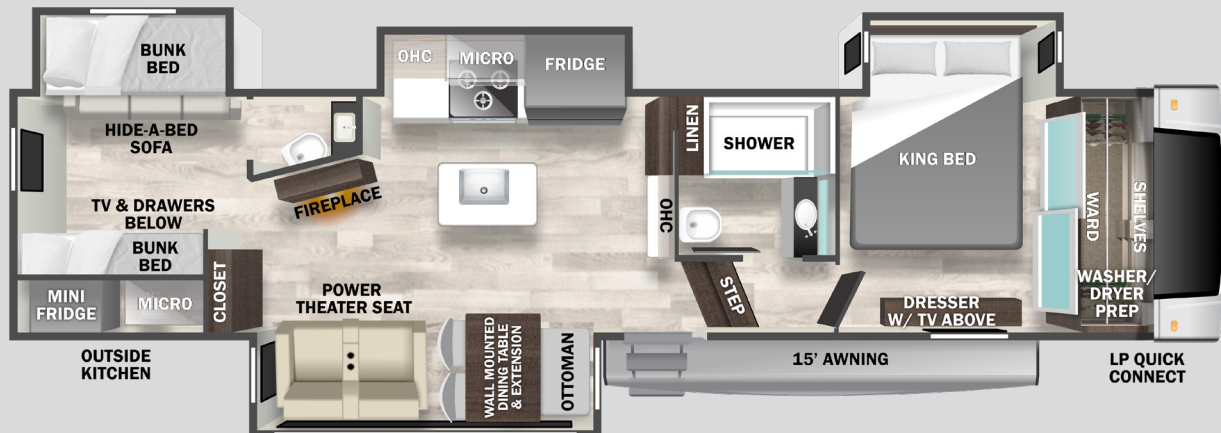

# 35RL

HITCH WEIGHT	GVWR	UVW	CCC	LENGTH	HEIGHT	WIDTH
2,185 lb.	16,185 lb.	12,614 lb.	3,571 lb.	39' 4"	13' 5"	101"



# 38DB

HITCH WEIGHT	GVWR	UVW	CCC	LENGTH	HEIGHT	WIDTH
2,855 lb.	16,855 lb.	14,704	2,151 lb.	43' 5"	13' 5"	101"



# 39RKB

HITCH WEIGHT	GVWR	UVW	CCC	LENGTH	HEIGHT	WIDTH
2,860	16,860	14,484	2,376	43'5"	13' 5"	101"

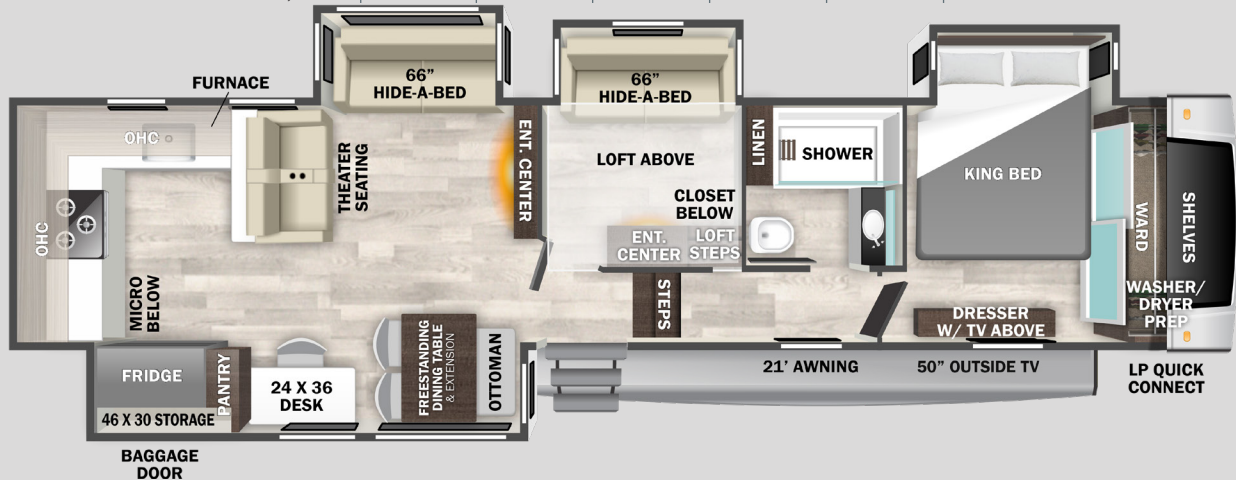

# EXPERIENCE TOP FEATURE HIGHLIGHTS

## EXTERIOR

- Cedar Creek's Famous All Aluminum Superstructure - 16" on Centers or Less True Gelcoat, Painted, Front Cap
- 101" Wide Body
- "True" Gelcoat Exterior (The Best of the Best in Exteriors)
- True Gelcoat, Painted, Front Cap
- 3M Bonded Sidewalls - Resilient, grows stronger with age. Also has outstanding resistance to UV, heat, cold moisture, oils, gasoline, highway chemicals, and creates a bond that cannot delaminate with time
- 6-Point Hydraulic Leveling System
- 21,000 LB. Rhino Box Hitch
- Z-frame
- TST Tire Pressure Monitoring System
- 7,000# Axles on 36">, 8000# Axles on 37< with ABS Electronic Brakes
- Lionshead Special Trailer (ST) Tires "No Excuses" One-Year Guarantee! Goodyear Tires on 7000# and Copper Tires on 8000#
- Road Warrior Suspension with Wet Bolts and Bronze Bushings
- Animal Leash Latch
- 4' x 6' ABS, Ribbed, Removable Underbelly Panels
- Full, Walk-on Roof with AlphaPly TPO with Lifetime Warranty
- 12 Volt Heating Pads on all Black, Grey, & Fresh Water Tanks
- Hinge 5 Tier MorRyde Easy-Steps

## INTERIOR

### KITCHEN / LIVING ROOM

- LED Lighting Fixtures
- 19.6 cu. ft., Glass Front, 12v. Refrigerator with Icemaker
- Residential, High Top, Swivel,

- Kitchen Faucet w/Pull Out Sprayer
- Stainless Steel, 30" Over the Range Microwave
- 3 Burner Range with Pull Out Utility Drawer
- Walnut Top, Free Standing Table & 2 Chairs w/Ottoman
- Solid Surface Island Countertop with Stainless Steel Flush Mount Sink and Workstations with more hidden front Storage
- Variable Speed, Power Fan with Rain Sensor Override in Kitchen
- Vinyl Floor Covering
- Black Out Night Roller Shades.
- Ashley Furniture Power Theater Seating with USB charging ports
- Ashley Ezy-Pull Sleeper Sofa
- Fireplace
- Overhead Rear Cabinet
- Luxury Window Valance
- Suburban ST-60 60,000 BTU Tank-less Water Heater

## INTERIOR

### BATHROOM / BEDROOM

- Full 48" x 30" Rectangular Shower with Seat and Sliding Glass Doors
- Large Bath Counter with Vessel Bowl Vanity
- Skylight over the Shower
- Upgraded Shower Head
- 18" High Porcelain Toilet with Top Circular Flush System
- Create-A-Breeze Circulation Fan
- Convenient Wall Switches for Fan & Lights
- Extra Storage for Linens
- LED Night lighting under the vanity

- Lighting above the Bed
- USB Ports
- Standard 72x80 King Bed
- Flip-Up Dresser Top with hidden storage
- Black-Out Night Shades
- Prepped for an Optional Washer and Dryer

## ELECTRONICS

- Smart Television w/Swing Arm
- 32" Smart Television in the BR
- 12v. Bluetooth Connectivity Speaker
- (2) Exterior Satellite & Cable Hook-Ups to Bedroom And LR
- Pre-Wired for satellite to the Roof

## AVAILABLE OPTIONS

- Slide-Out Awning Toppers
- 3rd AC with Power Management System
- 2ND "Rich Solar" 200 Watt Solar Panel
- LP Generator Prep
- Cadet Wall Mounted Heater with Circulation Fan

CEDAR CREEK  
**EXPERIENCE**



## FOREST RIVER INC. CEDAR CREEK DIVISION

501 Hawpatch Road • Topeka, IN 46571

Phone: 260-593-4013 • Parts & Service Phone: 260-593-4000

Visit our website at:

[forestriverinc.com/cedar-creek-experience](https://forestriverinc.com/cedar-creek-experience)

@cedarcreekbyforestriver



Actual towing capacity is dependent on your particular loading and towing circumstances, which includes GVWR, GAWR and GCWR, as well as adequate trailer brakes. Please refer to the Owner's Manual of your vehicle for further information. All information contained in this brochure is believed to be accurate at the time of publication. However, during the model year, it may be necessary to make revisions and Forest River, Inc., reserves the right to make all such changes without notice, including prices, colors, materials, equipment and specifications as well as the addition of new models and the discontinuance of models shown in this brochure. Therefore, please consult with your Forest River dealer and confirm the existence of any materials, design or specifications that are material to your purchase decision. ©2024 Forest River, Inc., a Berkshire Hathaway company. All Rights Reserved. 9/4



**FOREST RIVER**

**FORESTRIVERINC.COM**