

# WILDCAT



**FOREST RIVER**

[FORESTRIVERINC.COM](http://FORESTRIVERINC.COM)

# WILDCAT ONE TRAVEL TRAILERS



**T245DBX-ONE**

UVW	HITCH	CCC	LENGTH	HEIGHT	AWNING	CAPACITY (GAL)
TBD	TBD	TBD	TBD	TBD	20'	TBD TBD TBD



**T248RKX-ONE**

UVW	HITCH	CCC	LENGTH	HEIGHT	AWNING	CAPACITY (GAL)
6,523	670	2,947	30' 11"	11' 7"	19'	61 64 32



**T264BHX-ONE**

UVW	HITCH	CCC	LENGTH	HEIGHT	AWNING	CAPACITY (GAL)
7,239	912	2,477	34' 9"	11' 9"	20'	61 96 32

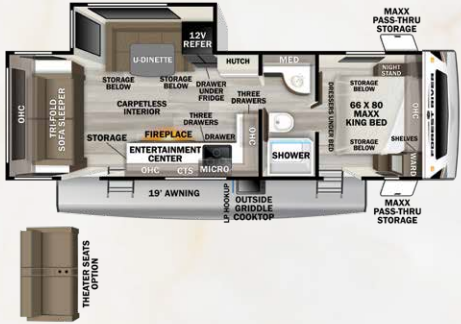

**T260RLX-ONE**

UVW	HITCH	CCC	LENGTH	HEIGHT	AWNING	CAPACITY (GAL)
6,568	677	2,909	31' 8"	11' 6"	19'	61 64 32



**T267MEX-ONE**

UVW	HITCH	CCC	LENGTH	HEIGHT	AWNING	CAPACITY (GAL)
6,976	933	2,757	32' 7"	11' 7"	20'	61 74 32

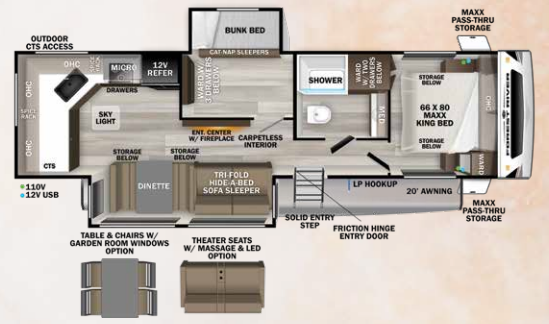

**T304MBX-ONE**

UVW	HITCH	CCC	LENGTH	HEIGHT	AWNING	CAPACITY (GAL)
7,671	768	1,897	35' 6"	11' 7"	20'	61 64 32

# WILDCAT MAXX TRAVEL TRAILERS



**T277FKX-MAXX**

UVW	HITCH	CCC	LENGTH	HEIGHT	AWNING	CAPACITY (GAL)
7,916	945	3,229	33' 11"	11' 9"	TBD	61 96 32

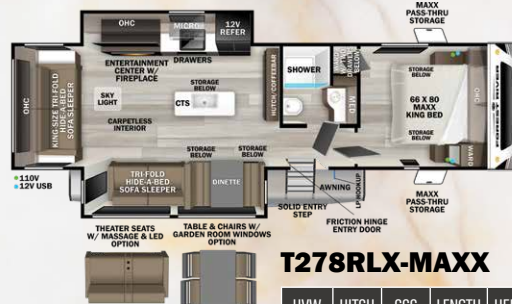

**T278RLX-MAXX**

UVW	HITCH	CCC	LENGTH	HEIGHT	AWNING	CAPACITY (GAL)
8,153	824	1,471	34' 9"	11' 7"	20'	61 108 54



**T310RKX-MAXX**

UVW	HITCH	CCC	LENGTH	HEIGHT	AWNING	CAPACITY (GAL)
7,820	911	1,891	35' 11"	11' 7"	20'	61 64 32

# WILDCAT TRAVEL TRAILER STANDARDS AND OPTIONS

## CONSTRUCTION

- 7' of Interior Ceiling Height (Travel Trailers) with Industry First: Maxx Strong Laminated Aluminum Framing
- 2" Thick Alumicat Vacuum-Bonded Gel-Coated Laminated Sidewalls with 2" High Density Block Foam Insulation
- 2¼" Welded Aluminum Framed Laminated Floor with 2" High Density Block Foam Insulation & 25' Dyna Span Floor Decking with Limited 25 Year Warranty
- 6' Slide Out Height (2" Vacuum Bonded Sidewalls & Ceiling with 1" 9-Ply Plywood Floors and Astro Foil Insulation; Slide room is Laminated on all four Sides)
- Aerodynamic Engineered Fiberglass Front Cap with Lower Diamond Plate Protection
- Full Walk On Truss Roof (5" in The Center Tapered to 3" on The Edge for Adequate Water Run Off) with 3/8" Decking and One-Piece PVC Roof with 15-Year Warranty
- EZ Lube Axles with Self-Adjusting Brakes
- Floorplan Specific Engineered Cambered I-Beam Chassis with Mega Ground Clearance
- 15" Load Range 'E' Radial Tires
- All Seasons MAXX Insulation Package
- Quick Cool Ducted 13.5 BTU Air Conditioning with Prefabricated Styrofoam Duct Work
- Pet-Friendly, Carpet-Free Interiors
- Fully Glued Residential Vinyl Flooring
- LP Gas Quick Connect for a BBQ or Outdoor Firepit
- Stylish 3M High-Definition Graphics Package with a 5-Year Warranty
- Outside Shower System with Hot and Cold Water
- One Touch Large Electric Awning with Added LED Strip Light
- Black Tank Flush Out Valve
- Tapered Front & Rear Skirt Metal for Added Ground Clearance
- 60,000 BTU On Demand/Quick Hot Tankless Water Heater with Active Freeze Protection (Endless Hot Water)
- 30" Main Entrance Door with Friction Hinge & Extra Large Grab Bar
- Best in Class Ultra Dark Tinted Safety Glass Panoramic Windows
- Rear Observation Camera Prep with Mounting Plate
- Rear Mounted Receiver for a Bike Rack or Storage Rack
- High Impact Molded Fender Skirt
- Spare Tire and Carrier
- Rear Wall Lippert Stow-and-Go Rear Ladder Bracket
- Electric Stabilizer Jacks (Front & Rear)

## EXECUTIVE KITCHEN

- Single Bowl, Waterfall, Multi-Function Workstation Sink (Comes with Glass Washer, Soap Dispenser, Colander, Task Basket, Pull-Down Faucet, & Cutting Board)
- Residential Shaker-Style Cabinet Doors
- Residential Hidden Hinges
- Solid Surface Countertops
- Black Finished Residential Door & Drawer Hardware
- Black Appliances
- Residential Full-Extension, Steel Ball-Bearing Drawer Guides
- Upgraded Microwave Oven
- Residential Size Black Stainless Steel Single Bowl Sink
- Black Pull-Out Residential Style Metal High-Rise Faucet with Pot Sprayer
- Residential 10+ Cubic Foot Black Glass Front, French Door, Quick Cool 12V Refrigerator with Auto Defrost & Large Lower Freezer Door
- Extra Large & Tall Overhead Cabinets with Shelf and Glass Inserts
- Extra Large Pots and Pans Drawers (Most Models)
- 17" Oven with 3-Burner Cast Iron Range With Oven Ignitor & Light (Wildcat ONE Models)
- 21" Oven with 3-Burner Cast Iron Range with Oven Ignitor & Light (Wildcat MAXX Models)
- Glass Range Cover
- Residential Style Range Vent with Light & Fan
- Cutlery Drawer
- Residential Kitchen Backsplash
- Central Trash System

## LIVING ROOM FEATURES

- Extra Large Booth Dinette with Under Seat Cabinet Doors & Dual Pedestal Table (Most Models)
- Tri-Fold Memory Foam, Hide-A-Bed Sleeper Sofa
- Extra Large-Dual Panoramic Dark Tinted Safety Glass Picture Windows Behind Sofa & Dinette
- Black Out Roller Shades
- 12-Volt, LED HDTV with Integrated 2-Zone Bluetooth/FM Tuner & Soundbar (Size varies by Model)
- Satellite & Cable Prep
- 12V LED Decorative Lighting in Slide-Outs
- Slider Windows at Ends of Slide-Outs
- Command Center with Monitor Panel

## BEDROOM FEATURES

- MAXX King 66" x 80" Long Residential Pillow-Top, Memory Foam Mattress
- Gas Struts to Lift Bed for Under-Bed Storage
- Fully Finished Bed Bases
- 7' High, Full Stand-Up Height in All Bedrooms
- Complete LED Lighting, Including Reading Lights
- Upgraded Residential Bedspread
- Shirt Closets on Each Side of Bed
- Bedroom Roof Vent
- CPAP & Tablet station at each side of bed (USB Ports & 110V plugs)
- Wardrobe (Most Models)
- Windows Open for cross Ventilation
- Front windshield in Maxx Models Only

## BATHROOM FEATURES

- 12" Power Vent Fan
- Porcelain Toilet with Foot Pedal Flush (MAXX Models)
- Foot Pedal Flush Toilet (ONE Models)
- Built-In Wood Medicine Cabinet with Mirrored Doors
- GFI Protected Receptacle
- Towel Hooks
- Large 30" X 36" Shower (Most Models)
- Large Sink with Extra Counter Space
- Shower Surround With Retractable Door
- Opaque Skylight Dome Over Shower for Additional Light & Increased Height

## SAFETY & SECURITY

- Carbon Monoxide Detector
- Smoke Detector
- LP Gas Detector
- Fire Extinguisher
- Large Axles with Self-Adjusting Brakes
- Emergency Escape Windows
- Safety Glass Windows
- No Slip Easy Load Entry Step
- 11,700 LB Safety Chains with Quick Disconnects
- Forest River Provided Roadside Assistance
- Backed by Forest River, a Subsidiary of Berkshire Hathaway

## OPTIONS

- Free Standing Table & 4 Chairs
- Garden Room (Includes Free Standing Table & Chairs)
- Dual Pane Windows
- 2ND 13.5 BTU A/C in Bedroom
- 15K BTU Ducted A/C
- Theater Seating IPO Tri-Fold Sofa
- 16" Aluminum Wheels & Load Range 'E' Tires
- Washington State Seal
- MVSA
- Canadian Z-240
- 30 LB LP Tanks in Place of 20 LB
- 50 AMP Service
- Prepped for Second A/C

## PEAK PACKAGE

- Front Windshield (MAXX Models)
- Black Tank Flush
- 10-Ply Load Range 'E' Tires
- Power Tongue Jack
- Friction Hinge Entry Doors
- Fold Down Entry Step (Main Entrance Only)
- Outside Kitchen (N/A on Some Models)
- MAXX King 66" x 80" Long Upgraded Mattress
- Large Single Bowl Stainless Steel Sink with Upgraded Designer Kitchen Faucet
- 21" 2-In-1 Range & Oven (MAXX Models)
- 10 Cubic Foot 12V Refrigerator
- Solid Surface Kitchen Countertops
- On Demand Water Heater
- Exterior Ladder Prep

## ALL SEASON MAXX INSULATION PACKAGE

- Extreme Ply PVC Roofing with 15-Year Limited Warranty
- Underbelly Armor Fully Enclosed Underbelly with Removable Panels
- 12V Thermostatically Controlled Heat Pads on all Holding Tanks with Built-in Thermostat
- Wrapped & Insulated Holding Tanks, R-7 Blanket Insulation, & Reflective Astro Foil Wrapped
- 2" Vacuum-Bonded Aluminum Framed Sidewalls with R-10 High-Density Block Foam in Slide-Out Walls & Roof
- Maxx-Strength Aluminum Framed Laminated Floor with 2" R-10 High-Density Block Foam Insulation
- Double Layered R-7 Fiberglass Insulation in Roof with Solar Reflective Astro Foil
- R-7 Front Insulation Wrapped in Solar Reflective Astro Foil
- 1" Insulated, Oversized Slam-Latch Baggage Doors 30,000 BTU Furnace
- Exterior Vented Attic for Breathable Roof
- Electric Fireplace with Thermostat & Remote Control, Heats up to 500 Square Feet
- 50 Amp Electric Service with 2nd A/C Prep (Option)
- Optional Dual Pane Windows
- Large LP Tanks with Auto Changeover & Protective Cover
- Remote Termination Dump Valves

## DYNAMIC TECHNOLOGY PACKAGE

- Vacuum Bonded 2" Welded Aluminum Structure
- Back-Up Camera Prep
- Roof Mounted Solar Panel Prep
- AM/FM Digital TV Antenna with 4G & Wi-Fi Extender Prep
- Exterior TV Connection
- Frame-Mounted Receiver Hitch
- Battery Disconnect
- 12-Volt, Dual Zone Smart TV with FM Tuner, Bluetooth, and Audio by JBL®
- Two (2) Exterior Speakers with Sound by JBL®
- Cellphone/ CPAP & Tablet Station at Each Side of Bed (USB Ports, 110V Plugs, & USB-C)
- 200-Watt Solar System with 30 Amp Quick Charge Controller with 8 Gauge Wiring—Expandable to 600 Watts
- Auto Detect Power Center (Automatically Detects Acid or Lithium Batteries)

## WILDCAT MAXX EXCLUSIVE FEATURES

- Front Windshield in Aerodynamic Gel-Coated Fiberglass Front Cap
- 21" Oven with a 3-Burner Cast Iron Range with Oven Ignitor
- Double Slide Out Floorplans
- Porcelain Foot Pedal Toilet



**T304MBX-ONE**

**UNDER-BED STORAGE**

Beds lift up to reveal a roomy storage area underneath.



**T267MEX-ONE**

*Shown with optional Garden Room Windows, Free Standing Table & Chairs, and Theater Seating*

**EACH NEW FOREST RIVER PURCHASE PROVIDES:**

- ✔ Pre-delivery Inspection.      ✔ Digital Owner's Manual.
- ✔ Free Membership to Forest River Owners Group (FROG).  
Learn more at [www.forestriverfrog.com](http://www.forestriverfrog.com).
- ✔ A Contribution to Care Camps Foundation [www.carecamps.org](http://www.carecamps.org).
- ✔ 1 Year Free Roadside Assistance from Date of Purchase.



**LEARN MORE:**

Scan this QR code with your mobile device to learn more about Forest River.



**SPECIFICATION DEFINITIONS:**

Scan this barcode using a QR reader on your smartphone to learn RV terminology and more!



YOUR **WILDCAT** DEALER

All information contained in this brochure is believed to be accurate at the time of publication. However, during any model year, it may be necessary to make changes to the manufacturing process of the units and information in this brochure. Your unit may differ from the information in this brochure due to any changes in the manufacturing process and equipment. Forest River, Inc., reserves the right to make all such changes without notice, including prices, colors, combinations, materials, equipment and specifications of any model as well as the addition of new models and the discontinuation of models shown in this brochure. Therefore, please consult with your Forest River dealer and confirm the availability of any materials, combinations, designs, or specifications that are meaningful to your purchase decision. © 2025 Wildcat, a Division of Forest River, Inc., a Berkshire Hathaway Company. All Rights Reserved. Forest River, Inc. 01/25