

FR3

FOREST RIVER

FR3 PLUS

FOREST RIVER

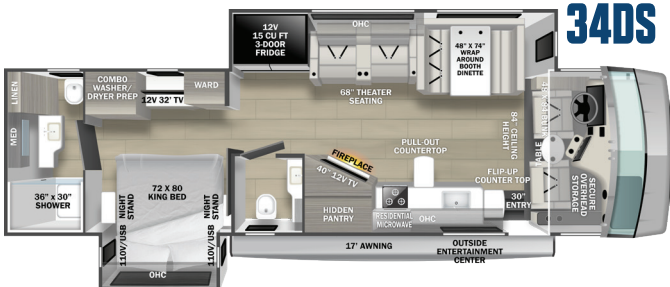
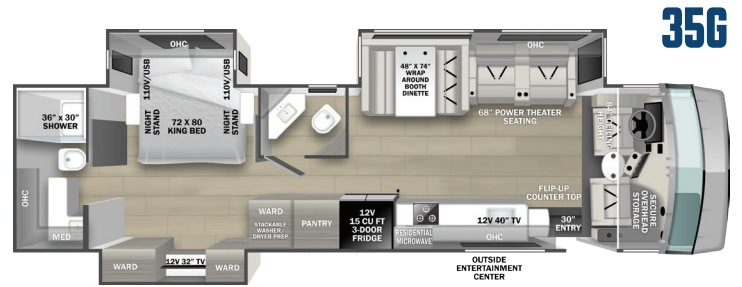
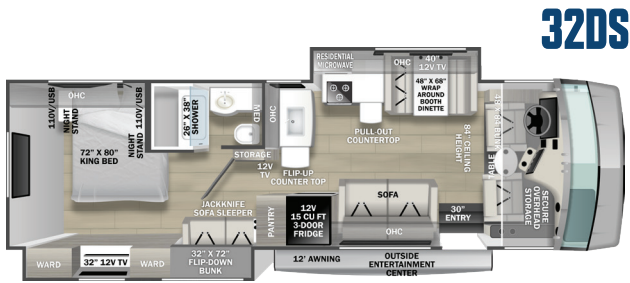
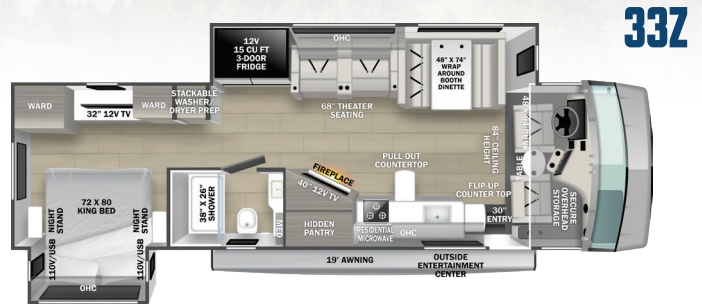
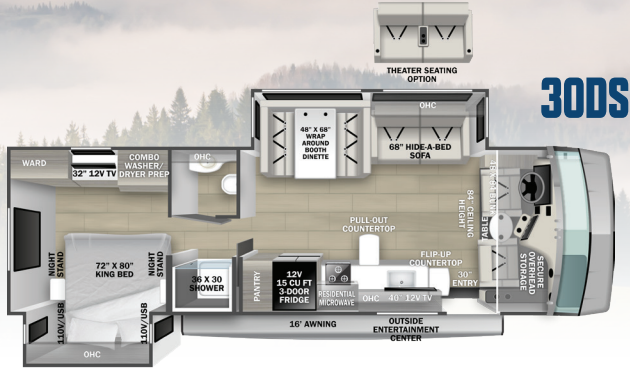

FR3 SPECIFICATIONS



MODEL	30DS	32DS	34DS	33Z	35G
Chassis***	Ford F53	Ford F53	Ford F53	Ford F53	Ford F53
Engine	7.3L V-8	7.3L V-8	7.3L V-8	7.3L V-8	7.3L V-8
Horse Power	335	335	335	335	335
Torque (lb.-ft.)	468	468	468	468	468
Wheelbase	228"	228"	228"	228"	252"
GVWR (lbs.)	20,500	20,500	20,500	22,000	24,000
GCWR (lbs.)	26,000	26,000	26,000	26,000	30,000
GAWR Front (lbs.)	7,500	7,500	7,500	8,000	9,000
GAWR Rear (lbs.)	13,500	13,500	13,500	15,000	15,500
Interior Height	82"	82"	82"	84"	84"
Exterior Width	101"	101"	101"	101"	101"
Exterior Length	31' 11"	33' 11"	35' 11"	35' 1"	37' 7"
Exterior Height (with A/C)	12' 5"	12' 5"	12' 5"	12' 6"	12' 6"
Fuel Capacity (gal.)	80	80	80	80	80
LP Capacity (lbs.)	103	103	103	103	103
Fresh Water Capacity (gal.)	52	52	52	73	73
Water Heater Capacity (gal.)	6	6	6	10	10
Gray Tank Capacity (gal.)	42	42	52	52	52
Black Tank Capacity (gal.)	42	42	52	52	52
Exterior Storage (cu. ft.)	115	152	184	139	108
Awning Length	16'	12'	17'	19'	17'

GVWR (Gross Vehicle Weight Rating) is the maximum permissible weight of the unit when fully loaded. It includes all weights, inclusive of all fluids, occupants, cargo, optional equipment and accessories. For safety and product performance do NOT exceed the GVWR.

GCWR (Gross Combined Weight Rating) is the maximum permissible loaded weight of your motor home and any towed trailer or towed vehicle. Actual GCWR of this vehicle may be limited by the sum of the GVWR and the installed hitch receiver maximum capacity rating; see hitch rating label for detail.

GAWR (Gross Axle Weight Rating) is the maximum permissible weight, including cargo, fluids, optional equipment and accessories that can be safely supported by each axle.

UVW (Unloaded Vehicle Weight)* is the typical weight of the unit as manufactured at the factory. It includes all weight at the unit's axle(s), including full fuel, all fluids and LP Gas. The UVW does not include cargo, fresh potable water, additional optional equipment or dealer installed accessories.

*Estimated Average based on standard build optional equipment.

CCC (Cargo Carrying Capacity)** is the amount of weight available for fresh potable water, cargo, passengers, additional optional equipment and accessories. CCC is equal to GVWR minus UVW. Available CCC should accommodate fresh potable water (8.3 lbs per gallon). Before filling the fresh water tank, empty the black and gray tanks to provide for more cargo capacity.

** Estimated average based on standard build optional equipment

Each Forest River motorhome is weighed at the manufacturing facility prior to shipping. A label identifying the unloaded vehicle weight of the actual unit and the cargo carrying capacity is applied to every Forest River motorhome prior to leaving our facilities.

The load capacity of your unit is designated by weight, not by volume, so you cannot necessarily use all available space when loading your unit.

Actual towing capacity is dependent upon your particular loading and towing circumstances, which includes the GVWR, GAWR and GCWR as well as adequate trailer brakes. Please refer to the Operator's Manual of your vehicle for further towing information.

All information contained in this brochure is believed to be accurate at the time of publication. However, during the model year, it may be necessary to make revisions and Forest River reserves the right to make all such changes without notice, including prices, colors, materials, equipment and specifications as well as the addition of new models and the discontinuance of models shown in this brochure. Therefore, please consult with your Forest River dealer and confirm the existence of any materials, design or specifications that are material to your purchase decision. 8/24

©Copyright 2024 FR3 a Division of Forest River Inc - All Rights Reserved.

KEY FEATURES

- **1-100 Amp Battle Born lithium coach battery with 1-200W solar panel standard** (Power Pack Option: One additional Battle Born 100W lithium battery and one additional 200W solar panel) (in FR3) **2-100 Amp Battle Born lithium batteries** (in FR3 Plus)
- **Solid hardwood cabinetry throughout motorhome**
- **72" x 80" King Size bed**
- **GE 15k front A/C with heat pump and GE 13.5k rear A/C** (Two 15k A/C's standard in FR3 Plus)
- **Arctic Package as standard equipment** (ducted holding tanks, heat pads, insulated heated connections)
- **One-piece seamless fiberglass roof**
- **10.1" Sony radio with wireless Apple CarPlay and Android Auto**
- **AGS (Auto Gen Start)**
- **Full body paint with Diamond Shield front cap protection** (FR3 Plus)
- **22.5" Alcoa Aluminum wheels** (FR3 Plus)
- **Soft touch ceilings** (FR3 Plus)
- **Frameless windows with built in shades and screens** (FR3 Plus)
- **Stackable Washer/Dryer option** (FR3 Plus)
- **Solid Surface kitchen countertops and dinette tabletop** (FR3 Plus)
- **Fiberglass rear cap** (FR3 Plus)
- **Power driver cockpit chair** (FR3 Plus)



Learn More:

Scan this barcode using a QR reader on your smart phone to learn more about Forest River.



FOREST RIVER

A Berkshire Hathaway Company



Forest River Inc.
FR3 Division
902 County Road 1
Elkhart, IN 46515
(574) 367-3285