

# SHAMROCK

EXPANDABLE TRAVEL TRAILERS

BY *Flagstaff*

PROUDLY  
*Millersburg Made*  
SINCE 1974



FOREST RIVER

FORESTRIVERINC.COM



# Shamrock Travel Trailers

## YOU'RE IN LUCK WITH THE SHAMROCK!

The 2025 Shamrock combines the feel of a traditional with expandable fold out beds with heated mattresses, providing a spacious interior and unique camping experience.

Amenities include a standard 1800W inverter with inverted outlets, 200W roof mounted solar panel with a 30A controller, 15,000 BTU A/C, hybrid woven flooring in flush floor slide outs, aluminum framed dinette and bed bases, and a Showermiser water saving system.



## SUPERIOR CONSTRUCTION

1. Complete **Composite** Wall Construction
2. 5/8" Tongue & Groove Plywood Floor
3. Fully **Laminated** Walkable Roof
4. Six-Sided Full-Aluminum Frame
5. Aluminum Floor Joists
6. Aluminum Dinette, Bed, and Bunk
7. Easy Reach Lockable Latch System

## STANDARD FEATURES

8. 200W Solar Panel w/1800W Inverter & 30A Charge Controller
9. Back-Up Camera Prep
10. Two Maxxair Fans with Cover
11. Winegard Air 360+ Prepped for Wi-Fi
12. Key-Alike Lock System
13. Slam Baggage Doors
14. Additional Solar Prep
15. Double Battery Boxes
16. Double 20 Lb. LP Tanks
17. 5-Year Vinyl Warranty

## SAFETY STANDARDS

18. Nitrogen-Filled Tires with Balancing Beads
19. Dexter® Torflex® Axles (17E: Curt® Slipper Roller)
20. TST Tire Pressure Monitor System
21. Goodyear Endurance Tires
22. MORryde® Strut Assist Steps<sup>1</sup>

## CLIMATE PROTECTION PACKAGE

23. 12V Thermostat-Controlled Heated Tanks
24. Radiant Foil in Underbelly

## OPTIONAL FEATURES (NOT PICTURED)

25. Additional 200W Solar Panel
26. Slide Toppers
27. 2nd A/C Where Applicable





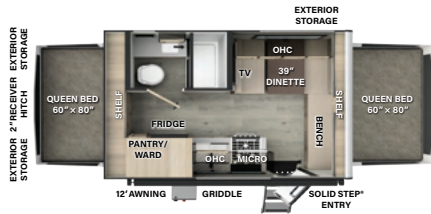
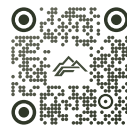

**17E**

LENGTH: 18' 9" OPEN LENGTH: 23' 6" WIDTH: 8' HEIGHT: 10' 4"

HITCH: 464 AXLE: 3356 UVW: 3858 CCC: 1606

F 54 GAL G 29 GAL B 29 GAL

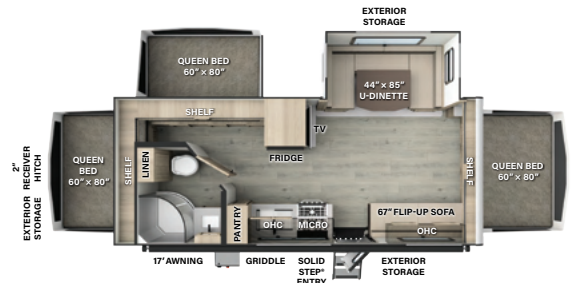

**233S**

LENGTH: 24' 10" OPEN LENGTH: 29' 7" WIDTH: 8' HEIGHT: 10' 6"

HITCH: 652 AXLE: 4421 UVW: 5111 CCC: 1541

F 54 GAL G 29 GAL B 29 GAL

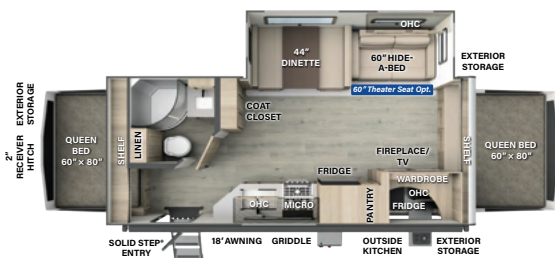

**235S**

LENGTH: 24' 10" OPEN LENGTH: 29' 7" WIDTH: 8' HEIGHT: 10' 11"

HITCH: 738 AXLE: 4863 UVW: 5639 CCC: 1259

F 54 GAL G 29 GAL B 29 GAL

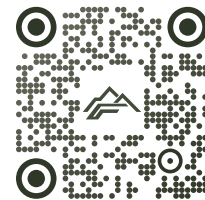



SCAN THE QR CODE WITH YOUR MOBILE DEVICE  
VIRTUAL TOURS, PHOTOS, VIDEOS, FOLLOW FLAGSTAFF ON SOCIAL MEDIA, AND MORE!



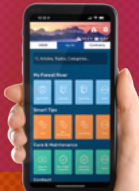

Download the App!



 Download on the App Store

 GET IT ON Google Play

Apple and App Store are registered trademarks of Apple Inc. Google Play and the Google Play logo are trademarks of Google LLC.

*For half a century, we have proudly and passionately crafted recreational vehicles that have become synonymous with quality, innovation, and adventure.*

*Since our establishment in 1974, we've committed ourselves to putting quality first and doing things right, every step of the way.*





# Flagstaff

201 WEST ELM MILLERSBURG, IN 46543  
WWW.FORESTRIVERINC.COM/FLAGSTAFF  
574.642.2640



RV WITH US



@FlagstaffRVs

# 50

CELEBRATING  
YEARS

FLAGSTAFF  
SINCE 1974

## Flagstaff Warranty. Our Promise.

FOR DETAILS ON FLAGSTAFF'S COMPLETE WARRANTY PROGRAM, SEE YOUR FLAGSTAFF DEALER.

When it comes to backing products with the same quality and commitment it does when it begins the manufacturing process, the only name you have to remember when you're looking for a recreational vehicle is Flagstaff. Flagstaff offers the following additional limited warranties to the original purchasers. Consult written warranty for details.

**1** Limited Lifetime roofing warranty.\*

\*Lifetime warranty is limited to original owner

**2** Two-year fiberglass warranty.

**3** Ten-year Torflex® axle warranty.

**4** One-year bumper to bumper warranty.

## SHAMROCK PACKAGES

### SHAMROCK TRAVEL TRAILER STANDARD PACKAGE H

- White/Alloy 2 Tone Fiberglass Exterior
- Square Bunk Ends w/Attached Boots & Aircraft Cable
- Automotive Grade Easy Latch Bunk Latch/Lock
- Power Tongue Jack
- Stabilizer Jacks
- Composite Structural Exterior Walls
- Vacuum Laminated Roof
- Aluminum Cage Construction
- Framed Windows
- Slam Latch Baggage Doors w/Magnetic Catch
- 15,000 BTU A/C
- Enclosed Underbelly w/Thermostatically Controlled Heated Holding Tanks
- Pre-wire for Backup Camera
- Bunk Fan/Light Combo
- Power Awning
- 200W Solar Panel w/Inverter & Additional Solar Side Port
- AIR 360+ Omnidirectional Antenna w/WI-FI Prep
- One Control® App Monitor Panel
- Smart TV
- 12V Smart Entertainment TV w/Stereo
- 12V Refrigerator
- Fireplace (Where Available)
- Microwave
- Gas Oven w/Glass Cover
- 35K Furnace
- 2 Maxxair Vents w/Covers
- 6 Gallon Quick Recovery Auto Ignite Gas/Electric Water Heater
- Dexter® Torflex® Torsion Axles (Curt\* Slipper Roller 17E)
- Goodyear Endurance Tires w/TPMS Tire Pressure Monitoring System
- Roller Shades
- Heated Mattresses
- MORryde Strut Assist Steps (N/A for double steps)
- Key Alike Doors
- Residential Look Kitchen Countertops w/Undermount Sink
- Soft Close Roller Bearing Drawers
- Hidden Hinge Cabinet Doors
- Black Tank Flush
- Water Saver Shower Miser
- Water Filter Supplied
- Exterior Hot/Cold Water Port
- Gas Griddle
- 2" Accessory Hitch
- Spare Tire Carrier & Cover
- Power Tongue Jack

### OPTIONS

- 2 Soft Start 13.5K Roof A/Cs IPO STD 15K A/C (N/A 17E)
- Slide Topper
- Theater Seat IPO Hide-A-Bed
- Extra 200W Roof Solar Panel

### EACH NEW FOREST RIVER PURCHASE PROVIDES:

- ✓ Pre-delivery Inspection.
- ✓ Free Membership to Forest River Owners Group (FROG). Learn more at [www.forestriverfrog.com](http://www.forestriverfrog.com).
- ✓ A Contribution to Care Camps Foundation [www.carecamps.org](http://www.carecamps.org).
- ✓ 1 Year Free Roadside Assistance from Date of Purchase.



### LEARN MORE:

Scan this QR code with your mobile device to learn more about Forest River.



### SPECIFICATION DEFINITIONS:

Scan this barcode using a QR reader on your smartphone to learn RV terminology and more!



YOUR **FLAGSTAFF** DEALER

All information contained in this brochure is believed to be accurate at the time of publication. However, during any model year, it may be necessary to make changes to the manufacturing process of the units and information in this brochure. Your unit may differ from the information in this brochure due to any changes in the manufacturing process and equipment. Forest River, Inc., reserves the right to make all such changes without notice, including prices, colors, combinations, materials, equipment and specifications of any model as well as the addition of new models and the discontinuance of models shown in this brochure. Therefore, please consult with your Forest River dealer and confirm the availability of any materials, combinations, designs, or specifications that are meaningful to your purchase decision. © 2024 Flagstaff, a Division of Forest River, Inc., a Berkshire Hathaway Company. All Rights Reserved. Forest River, Inc. 10/24