

# FLAGSTAFF

OTG – MAC – HARDSIDE



**FOREST RIVER**

[FORESTRIVERINC.COM](http://FORESTRIVERINC.COM)



### CORE CONVENIENCE PACKAGE:

(N/A 141OTG, 171OTG)

- Two Tone Fiberglass
- Maxxair Fan
- 12V Fridge w/125W Roof Solar Panel
- Awning w/LED Lighting (N/A Hardside)
- Water Filtration
- 20K BTU Furnace
- 6 Gal Gas Water Heater (N/A T10LE, T10RB)
- Hanging Pantry/Wardrobe
- (Where Available)
- CO Detector
- Under Bunk A/C (15K BTU Tents, 11K BTU Hardsides; N/A T10LE)
- Double LP Tanks (Single for T10LE)
- Power Lift (Tent Campers)
- Black Steel Wheels (Aluminum - Hardside)

## TENT CAMPERS SPECIFICATIONS

Floorplan	Closed Length	Open Length	Box Size	Closed Height	Hitch Weight	Axle Weight	UVW	CCC	Awning	Fresh Water	Gray Water	Black Water
141OTG	11' 10"	17' 2"	8'	4' 10"	162 lb	1157 lb	1319 lb	939 lb	N/A	N/A	N/A	N/A
171OTG	13' 10"	13' 10"	10'	4' 10"	183 lb	1116 lb	1299 lb	980 lb	N/A	N/A	N/A	N/A
164MT	11' 10"	17' 2"	8'	5'	250 lb	1475 lb	1763 lb	583 lb	7'	18 gal	N/A	N/A
192MT	16' 7"	20' 7"	10'	5'	240 lb	1875 lb	2153 lb	1087 lb	9'	18 gal	N/A	N/A
193MT	16' 7"	20' 5"	10'	5'	235 lb	1905 lb	2178 lb	1057 lb	9'	18 gal	N/A	N/A
227MT	18' 7"	20' 5"	12'	5' 1"	300 lb	2140 lb	2478 lb	1322 lb	11'	18 gal	N/A	N/A
238MT	16' 10"	23' 11"	12'	5'	290 lb	2190 lb	2518 lb	772 lb	11'	18 gal	N/A	N/A
27FMT	19' 3"	25' 9"	14'	6' 4"	400 lb	2594 lb	3032 lb	868 lb	13'	18 gal	6 gal	12 gal
T10LE	14' 5"	14' 5"	10'	5' 1"	255 lb	1455 lb	1748 lb	1247 lb	10'	18 gal	N/A	N/A
T10RB	16' 4"	16' 4"	10'	5' 1"	228 lb	1658 lb	1924 lb	1304 lb	10'	18 gal	N/A	N/A
T12FD	16' 5"	16' 5"	12'	5' 3"	285 lb	1889 lb	2212 lb	1073 lb	12'	18 gal	N/A	N/A
T12ST	18' 4"	18' 4"	12'	5' 1"	284 lb	1798 lb	2120 lb	1164 lb	12'	18 gal	N/A	N/A
T12RG	16' 5"	16' 5"	12'	5' 8"	310 lb	1845 lb	2193 lb	1117 lb	12'	18 gal	N/A	N/A
T21HS	20' 4"	20' 4"	14'	5' 8"	305 lb	2385 lb	2728 lb	577 lb	14'	18 gal	N/A	N/A
T21HSB	18' 5"	18' 5"	14'	5' 8"	290 lb	2195 lb	2523 lb	767 lb	14'	18 gal	N/A	N/A



**LEARN MORE ABOUT TENT CAMPERS:**

[FORESTRIVERINC.COM/RVS/FLAGSTAFF-TENT](https://forestriverinc.com/rvs/flagstaff-tent)



**LEARN MORE ABOUT HARDSIDE POP-UP CAMPERS:**

[FORESTRIVERINC.COM/RVS/FLAGSTAFF-HARDSIDE](https://forestriverinc.com/rvs/flagstaff-hardside)



# FLAGSTAFF

## OTG

The Flagstaff OTG Series tent campers offer a budget-friendly, no-fuss upgrade from traditional tent camping. With simple, weather-resistant design and essential comforts, they provide sleeping space, basic amenities, and easy towing—all at a great price. It's camping distilled to what matters most: freedom, flexibility, and fun.

## 141OTG

UVW: 1319 lb

CCC: 939 lb

Hitch Weight: 162 lb

Closed Length: 11' 10"

Exterior Length: 17' 2"

Closed Height: 4' 10"

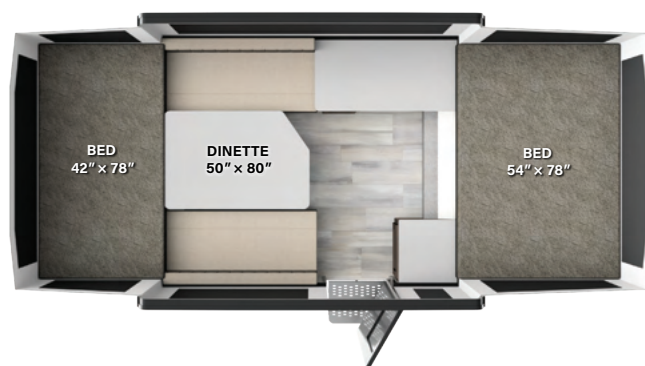

OTG | 171OTG



## 171OTG

UVW: 1299 lb

CCC: 980 lb

Hitch Weight: 183 lb

Closed Length: 11' 10"

Exterior Length: 13' 10"

Closed Height: 4' 10"

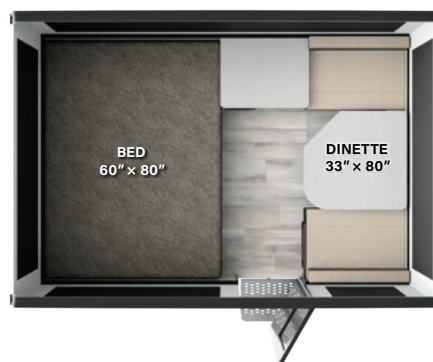

# FLAGSTAFF MAC

## 164MT

UVW: 1763 lb

CCC: 583 lb

Hitch Weight: 250 lb

Closed Length: 11' 10"

Exterior Length: 17' 2"

Closed Height: 5'

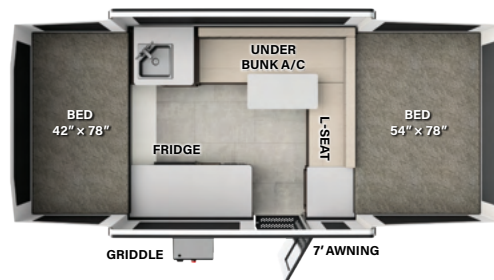

## 192MT **NEW**

UVW: 2153 lb

CCC: 1087 lb

Hitch Weight: 240 lb

Closed Length: 16' 7"

Exterior Length: 20' 7"

Closed Height: 5'

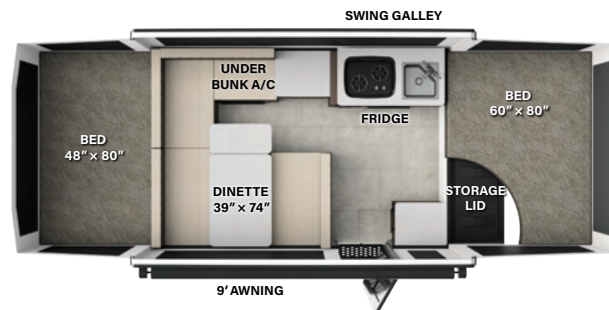

## 193MT **NEW**

UVW: 2178 lb

CCC: 1057 lb

Hitch Weight: 235 lb

Closed Length: 16' 7"

Exterior Length: 20' 5"

Closed Height: 5'

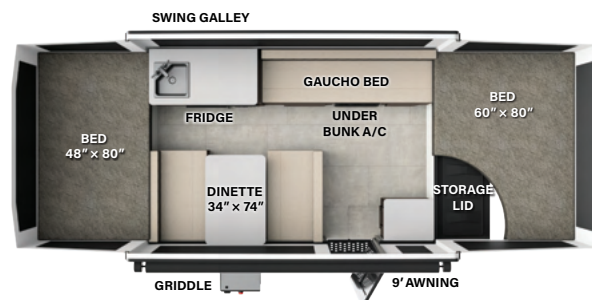

Flagstaff MAC tent campers offer the perfect blend of comfort and convenience for outdoor enthusiasts. Their lightweight, compact design makes towing and storage easy, even with smaller vehicles. Despite their size, they feature perks like LED-lit awnings, power roof lifts, A/C, and standard solar. With roomy sleeping space and quick setup, they deliver the charm of camping with modern comfort—so you can spend less time prepping and more time exploring.

## 227MT NEW

UVW: 2478 lb

CCC: 1322 lb

Hitch Weight: 300 lb

Closed Length: 18' 7"

Exterior Length: 20' 5"

Closed Height: 5' 1"

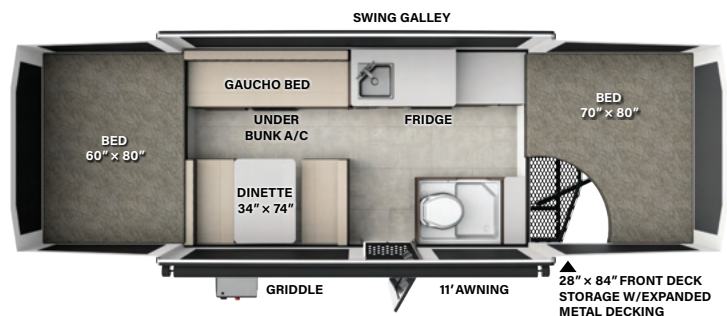

## 238MT NEW

UVW: 2518 lb

CCC: 772 lb

Hitch Weight: 290 lb

Closed Length: 16' 10"

Exterior Length: 23' 11"

Closed Height: 5'

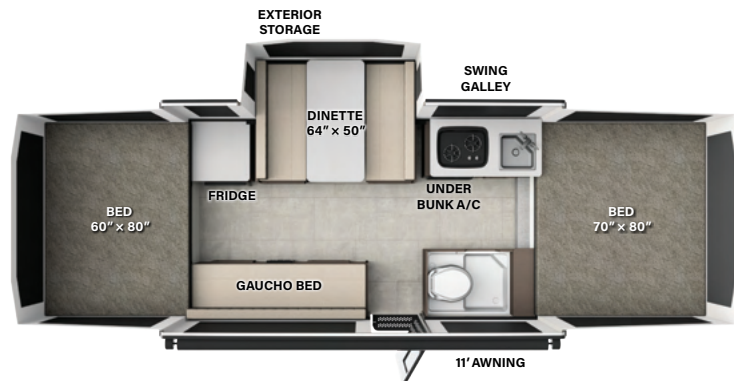

## 27MT

UVW: 3032 lb

CCC: 868 lb

Hitch Weight: 400 lb

Closed Length: 19' 3"

Exterior Length: 25' 9"

Closed Height: 6' 4"

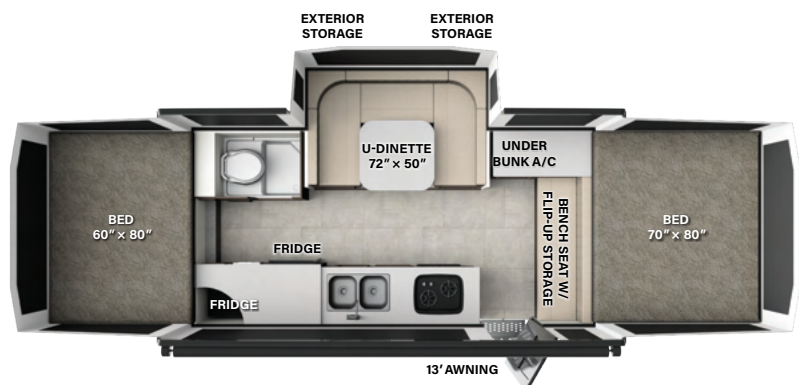



# FLAGSTAFF HARDSIDE

The Flagstaff Classic Hardside series delivers comfort and convenience in a compact, towable design that fits in most garages. Insulated walls and roof offer better temperature and sound control than tent campers. With 11K A/C, 20K Furnace, 125W Solar, and fast setup, you're ready to relax in minutes.

## T10LE **NEW**

UVW: 1748 lb

CCC: 1247 lb

Hitch Weight: 255 lb

Closed Length: 14' 5"

Exterior Length: 14' 5"

Closed Height: 5' 1"

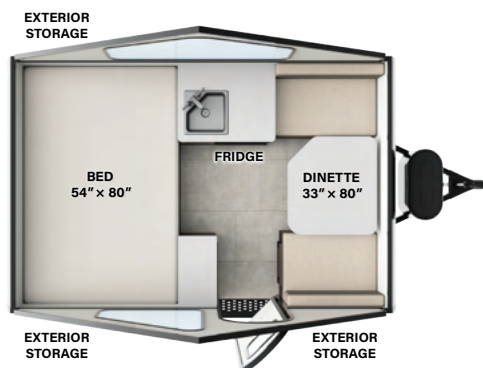

## T10RB

UVW: 1924 lb

CCC: 1304 lb

Hitch Weight: 228 lb

Closed Length: 16' 4"

Exterior Length: 16' 4"

Closed Height: 5' 1"

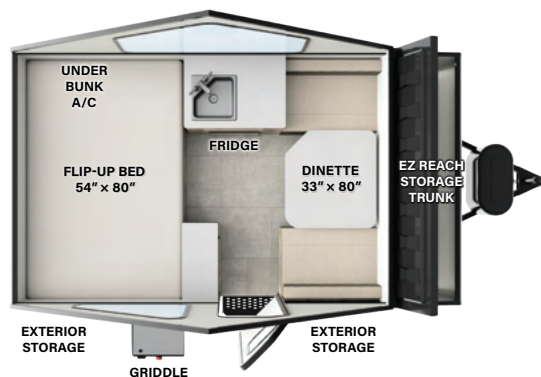

## T12FD **NEW**

UVW: 2212 lb

CCC: 1073 lb

Hitch Weight: 285 lb

Closed Length: 16' 5"

Exterior Length: 16' 5"

Closed Height: 5' 3"

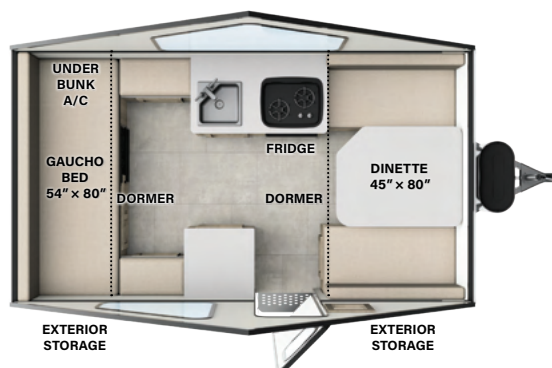

# T12ST

UVW: 2120 lb

CCC: 1164 lb

Hitch Weight: 284 lb

Closed Length: 18' 4"

Exterior Length: 18' 4"

Closed Height: 5' 1"

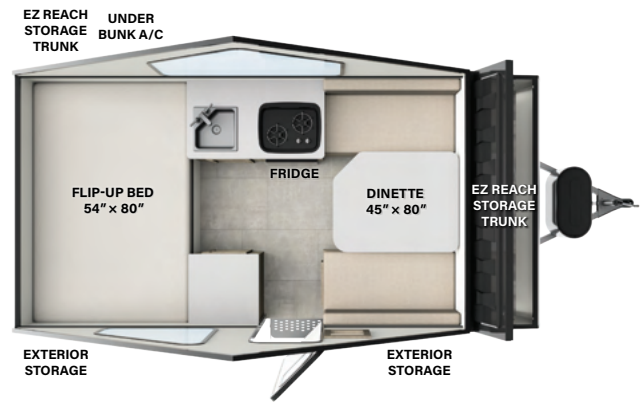

# T12RG NEW

UVW: 2193 lb

CCC: 1117 lb

Hitch Weight: 310 lb

Closed Length: 16' 5"

Exterior Length: 16' 5"

Closed Height: 5' 8"

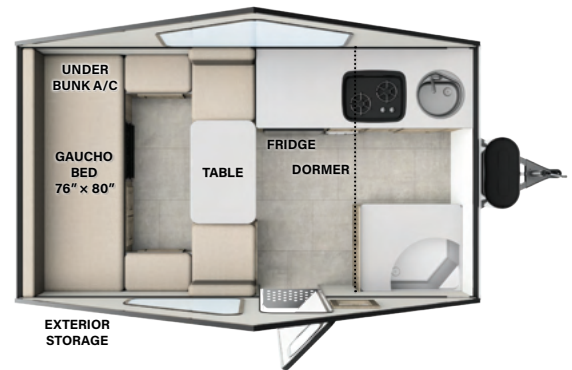

# T21HS

UVW: 2728 lb

CCC: 577 lb

Hitch Weight: 305 lb

Closed Length: 20' 4"

Exterior Length: 20' 4"

Closed Height: 5' 8"

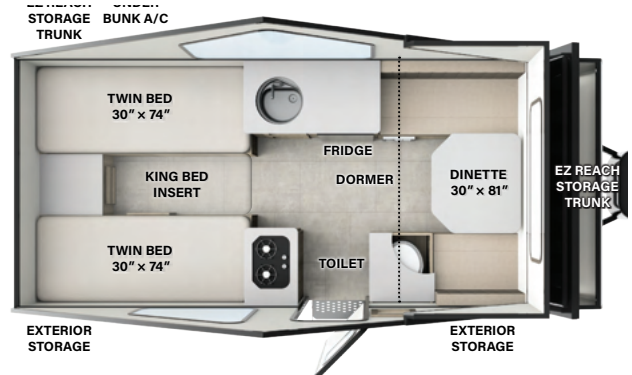

# T21HSB NEW

UVW: 2523 lb

CCC: 767 lb

Hitch Weight: 290 lb

Closed Length: 18' 5"

Exterior Length: 18' 5"

Closed Height: 5' 8"

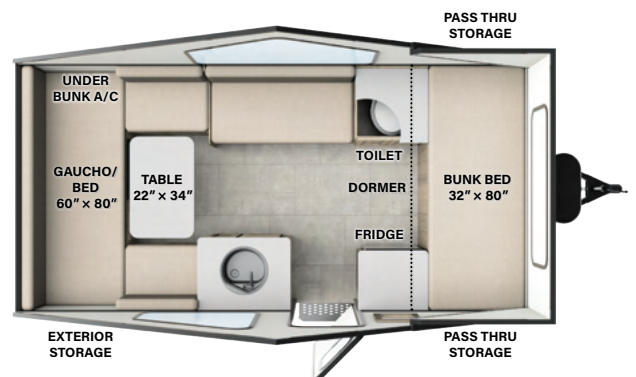

# THE FLAGSTAFF PROMISE

Flagstaff stands behind its craftsmanship with unwavering commitment from start to finish. When you choose Flagstaff, you're choosing an RV backed by our comprehensive limited warranties. For complete details, please consult the written warranty or your Flagstaff dealer.

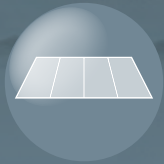

**FIVE YEAR  
ROOFING  
WARRANTY**

*(Excludes Hardside)*



**TWENTY FIVE  
YEAR FLOORING  
WARRANTY**



**TEN YEAR  
TORFLEX® AXLE  
WARRANTY**

*(Hardside Only)*



**FIVE YEAR  
FRAME  
WARRANTY**



**FIVE YEAR  
TENTING  
WARRANTY**



**LIMITED LIFETIME  
LIFTER SYSTEM  
WARRANTY**

*(Excludes Hardside)*

**MILLERSBURG  
MADE**

The story of Flagstaff is deeply intertwined with the town of Millersburg, Indiana. Here, generations of families have contributed to the creation of RVs known for their reliability and lasting value. "Millersburg Made" signifies a commitment to community and a dedication to building RVs you can trust. It's the assurance that your Flagstaff has been built with care, by people who take pride in their work and stand behind every RV that leaves our doors.

## EACH NEW FOREST RIVER PURCHASE PROVIDES:

- ✓ Pre-delivery Inspection.
- ✓ Digital Owner's Manual.
- ✓ Free Membership to Forest River Owners Group (FROG).  
Learn more at [www.forestriverfrog.com](http://www.forestriverfrog.com).
- ✓ A Contribution to Care Camps Foundation [www.carecamps.org](http://www.carecamps.org).
- ✓ 1 Year Free Roadside Assistance from Date of Purchase.



### LEARN MORE:

Scan this QR code with your mobile device to learn more about Forest River.



## SPECIFICATION DEFINITIONS:

Scan this barcode using a QR reader on your smartphone to learn RV terminology and more!



YOUR **FLAGSTAFF** DEALER