

SALEM

HEMISPHERE

— HYPER-LYTE TRAVEL TRAILERS

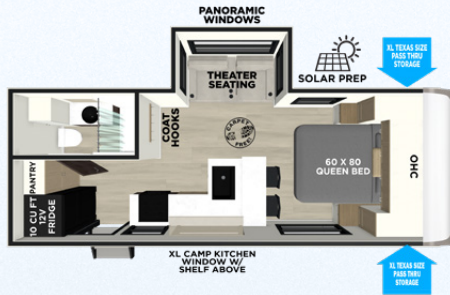

NEW MODEL

21RBHL

SLEEPS	UVW	LENGTH	HEIGHT
2	4,883 lbs	24' 11"	11' 1"

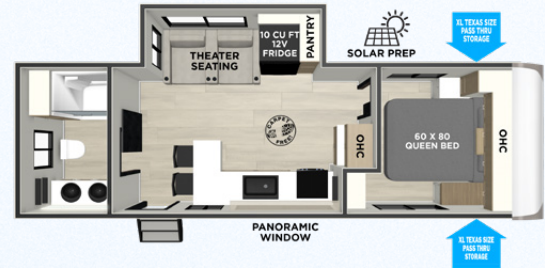

24RBHL

SLEEPS	UVW	LENGTH	HEIGHT
2	5,808 lbs	29' 7"	11' 1"

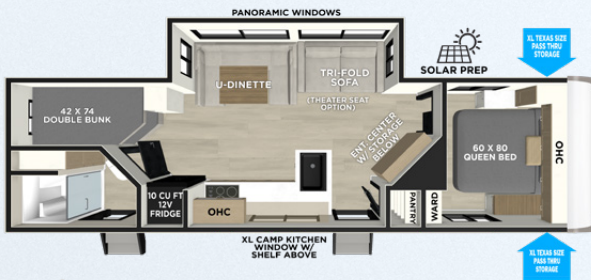

NEW MODEL

25BHHL

SLEEPS	UVW	LENGTH	HEIGHT
6	6,595 lbs	33' 11"	11' 5"

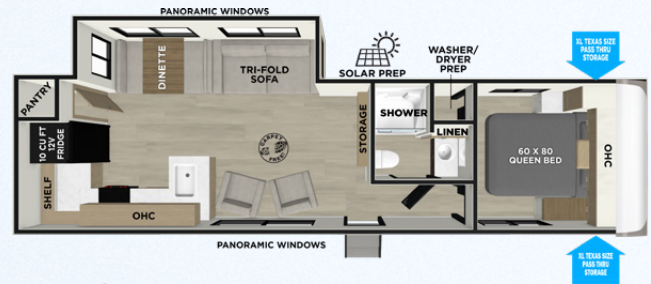

NEW MODEL

28RKHL

SLEEPS	UVW	LENGTH	HEIGHT
4	6,968 lbs	33' 11"	11' 5"



Designed to be towed by a variety of vehicles while still being feature rich and affordable. Affordability doesn't have to come at a compromise of superior features.

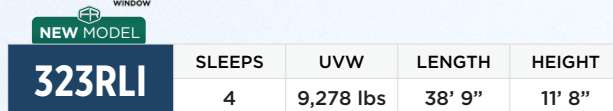
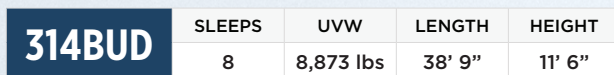
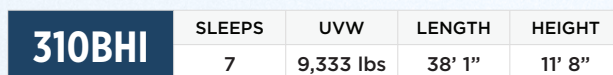
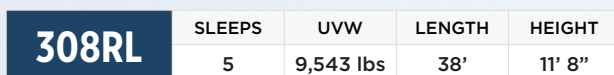
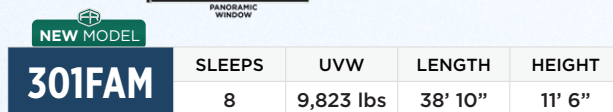
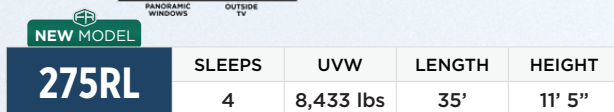
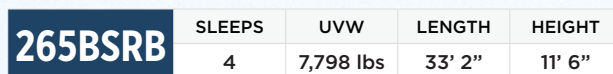
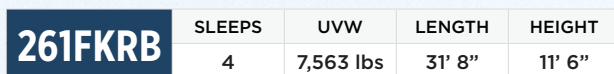

FIFTH WHEELS

[illegible]

PANORAMIC WINDOWS

30" X 74" BED ABOVE

30" X 24" CONVERTIBLE BED/SHOWER

U-DINETTE

THEATER SEAT

TABLE & CHAIRS

14 CU FT FRIDGE

WALK-IN SHOWER

66 X 90 KING BED

STORAGE

CLOSET

DRESSER

15,000 BTU AC UNIT

15,000 BTU HEATER

ENCLOSED UNDERBELLY W/ 12V HEATING PADS

SOLAR PREP FOR SOLAR PANEL INSTALLATION

FRIDGE

OUTSIDE KITCHEN/BAR

[illegible][illegible]

The floor plan for the 370SL motorhome shows a layout with a front bedroom (56 x 80 KING BED) and a bathroom (TOILET). The main living area includes a DINING area with a TRIFOLD SOFA, a KITCHEN with a SINK, STOVE, and REFRIG., and a SHOWER. There are also two additional TRIFOLD SOFAS and a DINING area with a TRIFOLD SOFA. The plan includes labels for PANORAMIC WINDOWS, EXTERIOR LIGHTS, and a TV. The overall dimensions are 37'0" L x 11'0" W.

[illegible]

1000 sq. ft. model home

Key features and areas labeled in the plan:

- Living Room:** Tri-Fold Sofa, Panoramic Windows, 6' x 6' x 6' TV Stand.
- Kitchen:** Pantry, Dishwasher, Stove, Microwave, Sink, 6' x 6' x 6' TV Stand.
- Dining Area:** Table, Seating, 6' x 6' x 6' TV Stand.
- Bedroom:** 72 x 80 King Bed, 6' x 6' x 6' TV Stand.
- Bathroom:** Shower, 6' x 6' x 6' TV Stand.
- Wardrobe:** 6' x 6' x 6' TV Stand.
- Hallway:** 6' x 6' x 6' TV Stand.
- Overall Dimensions:** 1000 sq. ft. model home.

20' AWNING

ENT. CENTER
ENT. AT 1/4" X 1/4" (REPLACE BELOW)

COFFEE TABLE

SECTIONAL SOFA

PULL-OUT PANTRY

MICRO OVEN

REFRIG. SERV. COUNTER

UTENSIL CUPB.

DISH. WASH.

WASHING CENTER

BACKLIT FLOATING SERV. SHELVES

ONE PEEP / FIBERGLASS ROOF BY 1/4" X 1/4" (REPLACE BELOW)

STORAGE

PULL-OUT TRAY

FRONT PORCHES

EMPLOYED UNDERBUILT W/ 12V HEATING PAD

SOLAR PANEL W/ OPTIONAL 500W SOLAR PACKAGE

SECOND LEVEL

ROOST43	SLEEPS	UVW	LENGTH	HEIGHT
	8	15,044 lbs	43' 9"	13' 5"

SALEM

HEMISPHERE

HYPER-LYTE TRAVEL TRAILERS • TRAVEL TRAILERS • FIFTH WHEELS

NOTES:

This image shows a single sheet of white paper with horizontal blue or grey ruling lines. The lines are evenly spaced and run across the width of the page. There are no margins, text, or other markings on the paper.

**SCAN TO VIEW
MORE INFO OR VISIT:**

FORESTRIVERINC.COM/RVS/HEMISPHERE-TRAVEL-TRAILERS



**SCAN TO VIEW
MORE INFO OR VISIT:**

FORESTRIVERINC.COM/RVS/HEMISPHERE-FIFTH-WHEELS



FOREST RIVER

All information shown is believed to be accurate at the time of publication. However, during any model year, it may be necessary to make changes to the manufacturing process of the units and information shown. Your unit may differ from the information shown due to any changes in the manufacturing process and equipment. Forest River, Inc., reserves the right to make all such changes without notice, including prices, colors, combinations, materials, equipment and specifications of any model as well as the addition of new models and the discontinuance of models shown. Therefore, please consult with your Forest River dealer and confirm the availability of any materials, combinations, designs, or specifications that are meaningful to your purchase decision. © 2025 Forest River, Inc., a Berkshire Hathaway Company. All Rights Reserved.