

TRACKS

PUMA



FOREST RIVER

FORESTRIVERINC.COM/RVS/PUMA-TRACKS

TRACKS TRAVEL TRAILERS

BUILT WITH SUPERIOR STANDARDS



TRACKS LITE: All the quality and comfort you love from Tracks, now in a lighter, more budget-friendly package. Designed for easy towing—even with small SUVs—the all-new Tracks Lite series brings big adventures within reach, proving that less weight doesn't mean less style or comfort.

TRACKS: Lightweight, stylish, and built for adventure—Tracks Travel Trailers turn every trip into something extraordinary. Designed with modern travelers in mind, each Tracks pairs easy towing with spacious, thoughtfully crafted interiors that feel like home on the road. From smart storage to bright, open living spaces, Tracks makes it simple to chase the moments that matter most—wherever your journey leads.



**SCAN TO VIEW PRICING AND
MORE INFORMATION OR VISIT:**

FORESTRIVERINC.COM/RVS/PUMA-TRACKS



KEY FEATURES

TRACKS LITE

- Power Awning w/LED Lights
- Steel Wheels
- Power Tongue Jack
- 15K BTU A/C
- Tub Surround w/Skylight
- Ball Bearing Drawer Guides
- Microwave
- Slam Latch Baggage Doors w/Magnets
- Bathroom Power Vent
- Black Tank Flush
- Stainless Steel Kitchen Sink
- LED Interior and Exterior Lights
- USB Ports
- Roller Shades
- 11 cu ft 12V Refrigerator
- Ladder Bracket
- Fully Enclosed/Heated Underbelly
- Fully Laminated Rear and Side Walls
- Fully Laminated Roof
- Rack & Pinion Electric Slide Out w/Manual Override
- 5/8" Tongue & Groove Flooring
- True Flush Floor Slide Out
- Porcelain Toilet
- Power Vent Fan in All Bathrooms
- Smoked Glass Kitchen Cabinet Doors
- Extra Large Dinettes
- Two Tone Cabinetry
- Two 20 lb LP Tanks
- Performance Fiberglass

TRACKS LITE OPTIONS

- Bedroom A/C (50 Amp Included)
- Power Stab Jacks
- 50 Amp Service (302 Only)
- 3rd A/C (302 Only)
- 200 Watt Solar Panel & Charge Controller
- Heated Holding Tanks
- Outside Griddle - Prep Table
- Tri-Fold Sofa Upgrade
- Theater Seat
- Wi-Fi Booster
- TV

TRACKS

- Power Awning w/LED Lights
- Aluminum Wheels
- Bluetooth* Stereo w/Speakers
- Power Tongue Jack
- 15K BTU A/C
- 200 Watt Solar Panel
- Tub Surround w/Skylight
- Ball Bearing Drawer Guides
- Microwave
- Slam Latch Baggage Doors w/Magnets
- Power Vent - Bathroom
- Black Tank Flush
- Stainless Steel Kitchen Sink
- LED Interior and Exterior Lights
- USB Ports
- Roller Shades
- 11 cu ft 12V Refrigerator
- Built w/Azdel Composite
- Ladder Bracket
- 50 Amp Service
- Drop Frame Storage (N/A 3060, 3200, 3380, 3070, 3300)
- Fully Enclosed/Heated Underbelly
- Fully Laminated Rear and Side Walls
- Fully Laminated Roof (Crowned Ceiling)
- Rack & Pinion Electric Slide Out w/Manual Override
- 5/8" Tongue & Groove Flooring
- Pre-Wired for Double/Triple A/C (N/A 2420, 2430, 2750)
- True Flush Floor Slide Out
- Porcelain Toilet
- Hidden Pantry (2420, 2430, 2580, 2750, 3150, 3380)
- Power Vent Fan in All Bathrooms
- Smoked Glass Kitchen Cabinet Doors
- Extra Large Dinettes
- Back Splash/Sink Cover
- Power Stabilizer Jacks
- Fiberglass Cap
- TV (Sizes Vary)
- Fireplace
- Hybrid Slide Out Carpet
- Bed Spread w/2 Pillow Shams
- Two Tone Cabinetry
- Theater Seating (N/A on 2430, 2750, 3070, 3300, 3380)

TRACKS OPTIONS

- Full Front Cap w/Line-X Rock Guard (STD on 3060, 3070, 3200, 3300, 3380 Only)
- Bedroom A/C
- Heated Holding Tanks
- 2nd Hide-A-Bed (IPO Theater Seat—3060 Only)
- Free Standing Table w/2 Ottomans & Bench (2580, 3150, 3200, 3380 Only)
- Outside Griddle—Prep Table
- Tri-Fold Sofa Upgrade (N/A 2430, 2750, 3070, 3300)
- Washer/Dryer (3060, 2580, 3200, 3380, 3070)
- Wi-Fi Booster
- 3rd A/C (N/A 2420, 2430)

PUMA TRACKS LITE



232UD **NEW**

UVW: 4858 lb
CCC: 1582 lb
Hitch Weight: 590 lb
Exterior Length: 25' 9"



235BH **NEW** **BUNK**

UVW: 4658 lb
CCC: 1585 lb
Hitch Weight: 560 lb
Exterior Length: 25' 11"



237RK **NEW**

UVW: 4918 lb
CCC: 1587 lb
Hitch Weight: 670 lb
Exterior Length: 25' 9"



302BHS **NEW** **BUNK**

UVW: 6348 lb
CCC: 1252 lb
Hitch Weight: 725 lb
Exterior Length: 33' 6"

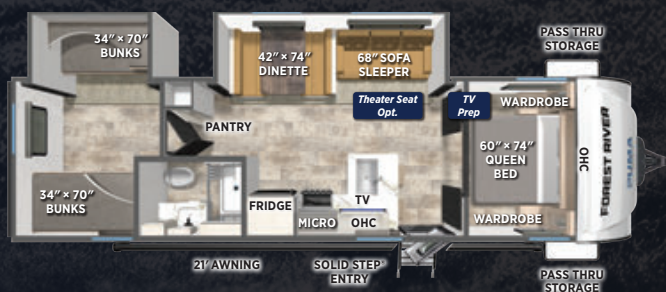

PUMA TRACKS

242ORBS

UVW: 5328 lb
CCC: 1575 lb
Hitch Weight: 635 lb
Exterior Length: 27' 11"

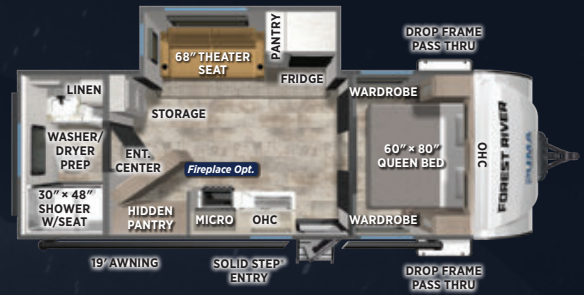

243OBHS BUNK

UVW: 5673 lb
CCC: 1596 lb
Hitch Weight: 645 lb
Exterior Length: 30' 7"



258ORBSS

UVW: 6013 lb
CCC: 1615 lb
Hitch Weight: 725 lb
Exterior Length: 32' 8"



275OBHS NEW BUNK

UVW: 6183 lb
CCC: 1467 lb
Hitch Weight: 650 lb
Exterior Length: 32' 6"



306ORKTS

UVW: 7803 lb
CCC: 1900 lb
Hitch Weight: 1050 lb
Exterior Length: 37'



3070RKLS

Exterior Length: 37'



Exterior Length: 36' 10"



Exterior Length: 36' 5"



Exterior Length: 36' 10"



Exterior Length: 37' 8"

PUMA TRACKS SPECIFICATIONS

Model	Length	Width	Interior Height	Exterior Height	Awning Size	Hitch Weight	Axle Weight	UVW	CCC	Fresh Water	Gray Water	Black Water
TRACKS LITE												
232UD	25' 9"	8'	6' 8"	10' 10"	16'	590 lb	4230 lb	4858 lb	1582 lb	42 Gal	60 Gal	30 Gal
235BH	25' 11"	8'	6' 8"	10' 10"	17'	560 lb	4060 lb	4658 lb	1585 lb	42 Gal	60 Gal	30 Gal
237RK	25' 9"	8'	6' 8"	10' 10"	17'	670 lb	4210 lb	4918 lb	1587 lb	42 Gal	76 Gal	30 Gal
302BHS	33' 6"	8'	6' 8"	10' 10"	21'	725 lb	5585 lb	6348 lb	1252 lb	42 Gal	60 Gal	30 Gal
TRACKS												
2420RBS	27' 11"	8'	6' 8"	11' 1"	19'	635 lb	4655 lb	5328 lb	1575 lb	42 Gal	68 Gal	38 Gal
2430BHS	30' 7"	8'	6' 8"	11' 1"	21'	645 lb	4490 lb	5673 lb	1596 lb	42 Gal	60 Gal	30 Gal
2580RBSS	32' 8"	8'	6' 8"	11' 1"	21'	725 lb	5250 lb	6013 lb	1615 lb	42 Gal	68 Gal	38 Gal
2750BHS	32' 6"	8'	6' 8"	10' 10"	19'	650 lb	5495 lb	6183 lb	1467 lb	42 Gal	38 Gal	38 Gal
3060RKTS	37'	8'	6' 8"	11' 1"	11', 11'	1050 lb	6715 lb	7803 lb	1900 lb	42 Gal	106 Gal	38 Gal
3070RKLS	37'	8'	6' 8"	11' 1"	11', 11'	1080 lb	6800 lb	7918 lb	1976 lb	42 Gal	106 Gal	38 Gal
3150TBSS	36' 10"	8'	6' 8"	11' 1"	19'	880 lb	5835 lb	6753 lb	1990 lb	42 Gal	76 Gal	38 Gal
3200TSBH	36' 5"	8'	6' 8"	11' 1"	21'	995 lb	6425 lb	7458 lb	1937 lb	42 Gal	68 Gal	30 Gal
3300FLBS	36' 10"	8'	6' 8"	11' 1"	21'	1015 lb	6640 lb	7693 lb	1950 lb	42 Gal	76 Gal	38 Gal
3380RLBT	37' 8"	8'	6' 8"	11' 1"	11', 11'	1060 lb	7200 lb	8298 lb	1962 lb	42 Gal	106 Gal	38 Gal

PREMIUM BUILD QUALITY



BUILT STRONGER TO ALLOW FOR PERIODIC ROOF MAINTENANCE.

VACUUM-BONDED LAMINATED CONSTRUCTION



Tracks provides five-sided aluminum framing. As well as vacuum bonded walls and roof to ensure a well-insulated, light weight and structurally sound trailer.

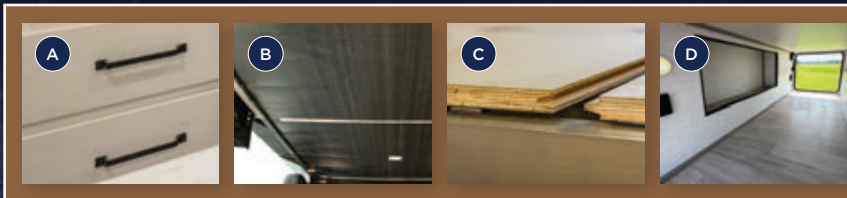

- A. Glued and screwed wood cabinetry
- B. Heated underbelly to protect trailer components as well as increase aerodynamics
- C. 5/8" Drymax water resistant decking glued and screwed to aluminum framing with Azdel construction and high gloss gel coat fiberglass
- D. Heated pass thru storage

WALL STRENGTH

Structurally engineered materials makes our vacuum-bonded walls some of the strongest in the industry.



SCAN TO LEARN RV TERMINOLOGY OR VISIT:
FORESTRIVERINC.COM/RV-DEFINITIONS

STAY PROTECTED WITH TRACKS

Puma Tracks stands behind every unit with a pledge of dependable protection, reinforcing customer confidence long after the keys change hands. Our warranty support reflects a philosophy of lasting value, ensuring owners feel secure on every road ahead. Each promise of coverage underscores a belief in durable craftsmanship and a commitment to standing with customers through every mile. For complete details on our warranty program, please visit your Puma Tracks dealer.

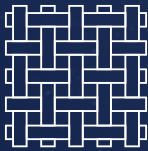

**2 YEAR
FIBERGLASS
WARRANTY**



**LIFETIME ALPHA
SUPER FLEX ROOF
WARRANTY**



**2-3 YEAR APPLIANCE
WARRANTY (SEE MAN-
UAL FOR DETAILS)**



**1 YEAR WARRANTY
AGAINST MANUFAC-
TURING DEFECTS**

TRACKS
PUMA

1047 East M-86 | Colon, MI 49040

P: 269.432.3271 | F: 269.432.2516

www.forestriverinc.com/tracks

Follow Tracks on:   



**SCAN WITH YOUR
MOBILE DEVICE**

Virtual Tours, Photos,
videos, follow Palomino on
Social Media, and more!

www.forestriverinc.com

EACH NEW FOREST RIVER PURCHASE PROVIDES:

- ✓ Pre-delivery Inspection. ✓ Digital Owner's Manual.
- ✓ Free Membership to Forest River Owners Group (FROG).
Learn more at www.forestriverfrog.com.
- ✓ A Contribution to Care Camps Foundation www.carecamps.org.
- ✓ 1 Year Free Roadside Assistance from Date of Purchase.



LEARN MORE:

Scan this QR code with your
mobile device to learn more
about Forest River.



SPECIFICATION DEFINITIONS:

Scan this barcode using a QR reader on your smartphone
to learn RV terminology and more!



YOUR **PUMA** DEALER