

ROCKWOOD

OTG – FREEDOM – HARDSIDE



FOREST RIVER

FORESTRIVERINC.COM



CORE CONVENIENCE PACKAGE:

(N/A 160TG, 190TG)

- Two Tone Fiberglass
- Maxxair Fan
- 12V Fridge w/125W Roof Solar Panel
- Awning w/LED Lighting (N/A Hardside)
- Water Filtration
- 20K BTU Furnace
- 6 Gal Gas Water Heater (N/A A101LE, A101RB)
- Hanging Pantry/Wardrobe
- (Where Available)
- CO Detector
- Under Bunk A/C (15K BTU Tents, 11K BTU Hardsides; N/A A101LE)
- Double LP Tanks (Single for A101LE)
- Power Lift (Tent Campers)
- Black Steel Wheels (Aluminum - Hardside)

TENT CAMPERS SPECIFICATIONS

Floorplan	Closed Length	Open Length	Box Size	Closed Height	Hitch Weight	Axle Weight	UVW	CCC	Awning	Fresh Water	Gray Water	Black Water
160TG	11' 10"	17' 2"	8'	4' 10"	162 lb	1157 lb	1319 lb	939 lb	N/A	N/A	N/A	N/A
190TG	13' 10"	13' 10"	10'	4' 10"	183 lb	1116 lb	1299 lb	980 lb	N/A	N/A	N/A	N/A
1640FT	11' 10"	17' 2"	8'	5'	250 lb	1475 lb	1763 lb	583 lb	7'	18 gal	N/A	N/A
1920FT	16' 7"	20' 7"	10'	5'	240 lb	1875 lb	2153 lb	1087 lb	9'	18 gal	N/A	N/A
1930FT	16' 7"	20' 5"	10'	5'	235 lb	1905 lb	2178 lb	1057 lb	9'	18 gal	N/A	N/A
2270FT	18' 7"	20' 5"	12'	5' 1"	300 lb	2140 lb	2478 lb	1322 lb	11'	18 gal	N/A	N/A
2380FT	16' 10"	23' 11"	12'	5'	290 lb	2190 lb	2518 lb	772 lb	11'	18 gal	N/A	N/A
277FT	19' 3"	25' 9"	14'	6' 4"	400 lb	2594 lb	3032 lb	868 lb	13'	18 gal	6 gal	12 gal
A101LE	14' 5"	14' 5"	10'	5' 1"	255 lb	1455 lb	1748 lb	1247 lb	10'	18 gal	N/A	N/A
A101RB	16' 4"	16' 4"	10'	5' 1"	228 lb	1658 lb	1924 lb	1304 lb	10'	18 gal	N/A	N/A
A121FD	16' 5"	16' 5"	12'	5' 3"	285 lb	1889 lb	2212 lb	1073 lb	12'	18 gal	N/A	N/A
A122S	18' 4"	18' 4"	12'	5' 1"	284 lb	1798 lb	2120 lb	1164 lb	12'	18 gal	N/A	N/A
A123RG	16' 5"	16' 5"	12'	5' 8"	310 lb	1845 lb	2193 lb	1117 lb	12'	18 gal	N/A	N/A
A213HS	20' 4"	20' 4"	14'	5' 8"	305 lb	2385 lb	2728 lb	577 lb	14'	18 gal	N/A	N/A
A216HS	18' 5"	18' 5"	14'	5' 8"	290 lb	2195 lb	2523 lb	767 lb	14'	18 gal	N/A	N/A



LEARN MORE ABOUT TENT CAMPERS:

FORESTRIVERINC.COM/RVS/ROCKWOOD-TENT



LEARN MORE ABOUT HARDSIDE POP-UP CAMPERS:

FORESTRIVERINC.COM/RVS/ROCKWOOD-HARDSIDE

OTG

— ROCKWOOD —

The Rockwood OTG Series tent campers offer a budget-friendly, no-fuss upgrade from traditional tent camping. With simple, weather-resistant design and essential comforts, they provide sleeping space, basic amenities, and easy towing—all at a great price. It's camping distilled to what matters most: freedom, flexibility, and fun.

160TG

UVW: 1319 lb

CCC: 939 lb

Hitch Weight: 162 lb

Closed Length: 11' 10"

Exterior Length: 17' 2"

Closed Height: 4' 10"

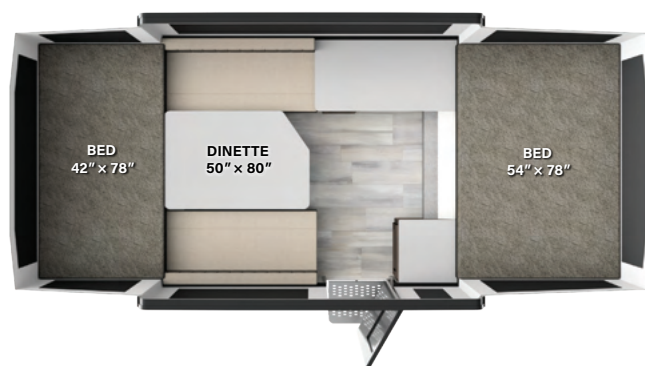

OTG | 160TG



190TG

UVW: 1299 lb

CCC: 980 lb

Hitch Weight: 183 lb

Closed Length: 11' 10"

Exterior Length: 13' 10"

Closed Height: 4' 10"

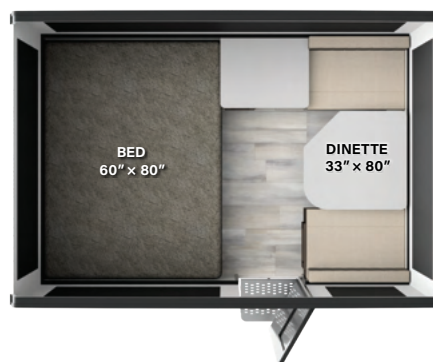

FREEDOM

— ROCKWOOD —

1640FT

UVW: 1763 lb

CCC: 583 lb

Hitch Weight: 250 lb

Closed Length: 11' 10"

Exterior Length: 17' 2"

Closed Height: 5'

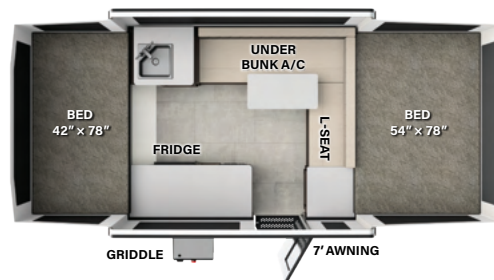

1920FT **NEW**

UVW: 2153 lb

CCC: 1087 lb

Hitch Weight: 240 lb

Closed Length: 16' 7"

Exterior Length: 20' 7"

Closed Height: 5'

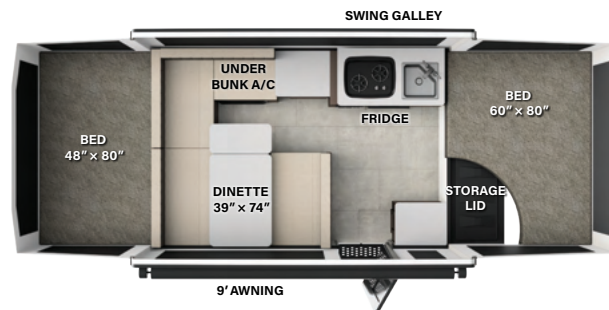

1930FT **NEW**

UVW: 2178 lb

CCC: 1057 lb

Hitch Weight: 235 lb

Closed Length: 16' 7"

Exterior Length: 20' 5"

Closed Height: 5'

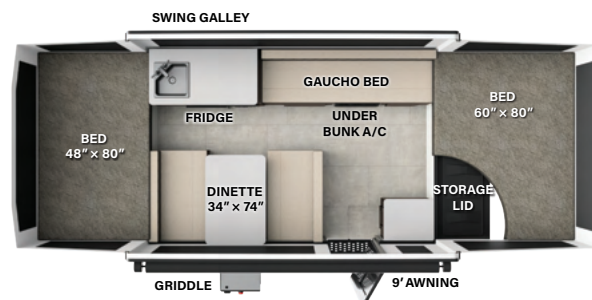

Rockwood Freedom tent campers offer the perfect blend of comfort and convenience for outdoor enthusiasts. Their lightweight, compact design makes towing and storage easy, even with smaller vehicles. Despite their size, they feature perks like LED-lit awnings, power roof lifts, A/C, and standard solar. With roomy sleeping space and quick setup, they deliver the charm of camping with modern comfort—so you can spend less time prepping and more time exploring.

2270FT NEW

UVW: 2478 lb

CCC: 1322 lb

Hitch Weight: 300 lb

Closed Length: 18' 7"

Exterior Length: 20' 5"

Closed Height: 5' 1"

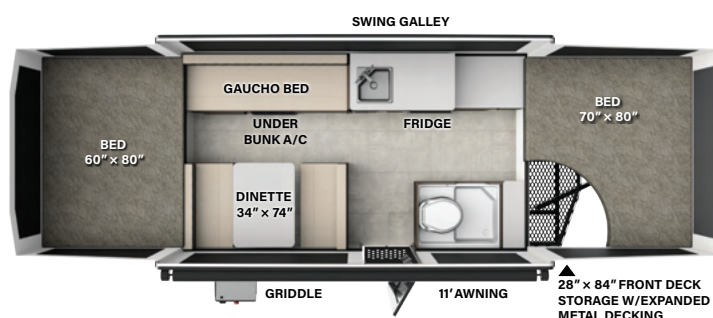

2380FT NEW

UVW: 2518 lb

CCC: 772 lb

Hitch Weight: 290 lb

Closed Length: 16' 10"

Exterior Length: 23' 11"

Closed Height: 5'

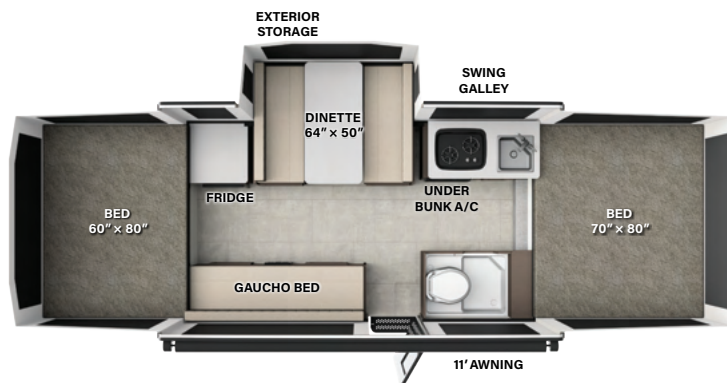

277FT

UVW: 3032 lb

CCC: 868 lb

Hitch Weight: 400 lb

Closed Length: 19' 3"

Exterior Length: 25' 9"

Closed Height: 6' 4"

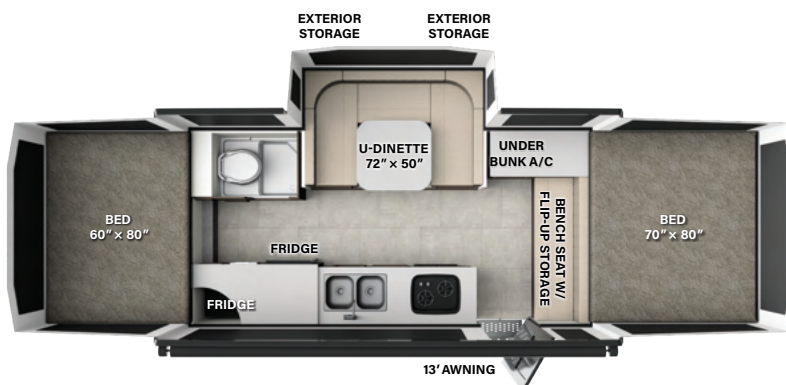

HARDSIDE

ROCKWOOD

The Rockwood Premier Hardside series delivers comfort and convenience in a compact, towable design that fits in most garages. Insulated walls and roof offer better temperature and sound control than tent campers. With 11K A/C, 20K Furnace, 125W Solar, and fast setup, you're ready to relax in minutes.

A101LE NEW

UVW: 1748 lb

CCC: 1247 lb

Hitch Weight: 255 lb

Closed Length: 14' 5"

Exterior Length: 14' 5"

Closed Height: 5' 1"

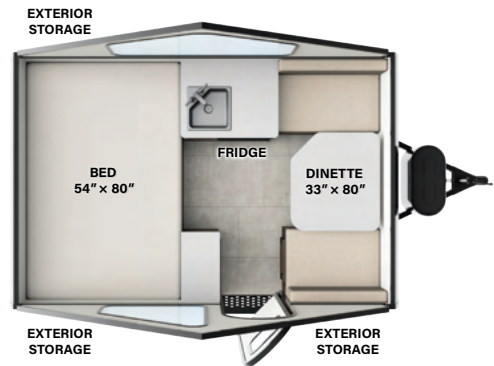

A101RB

UVW: 1924 lb

CCC: 1304 lb

Hitch Weight: 228 lb

Closed Length: 16' 4"

Exterior Length: 16' 4"

Closed Height: 5' 1"

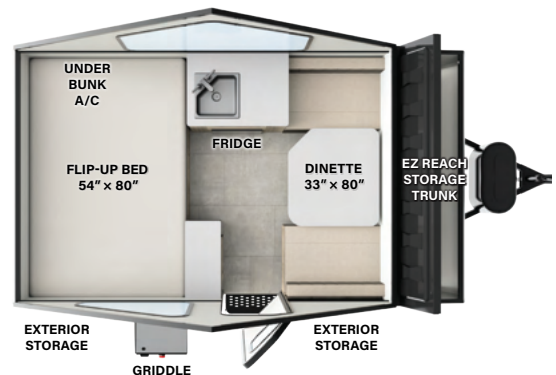

A121FD NEW

UVW: 2212 lb

CCC: 1073 lb

Hitch Weight: 285 lb

Closed Length: 16' 5"

Exterior Length: 16' 5"

Closed Height: 5' 3"

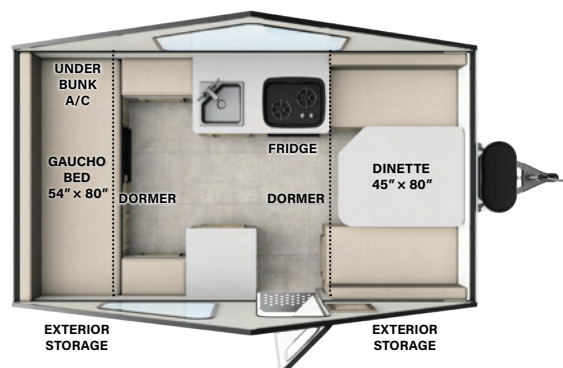

A122S

UVW: 2120 lb

CCC: 1164 lb

Hitch Weight: 284 lb

Closed Length: 18' 4"

Exterior Length: 18' 4"

Closed Height: 5' 1"

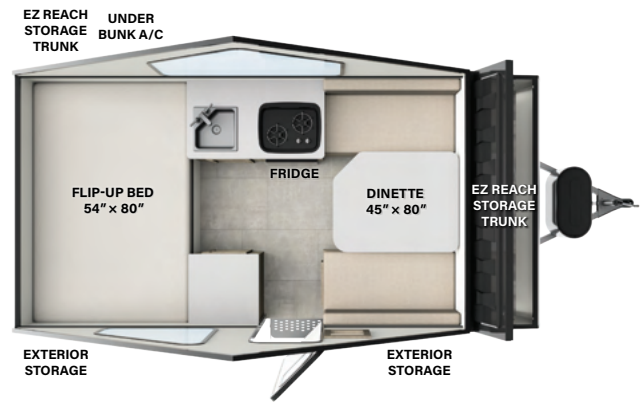

A123RG NEW

UVW: 2193 lb

CCC: 1117 lb

Hitch Weight: 310 lb

Closed Length: 16' 5"

Exterior Length: 16' 5"

Closed Height: 5' 8"

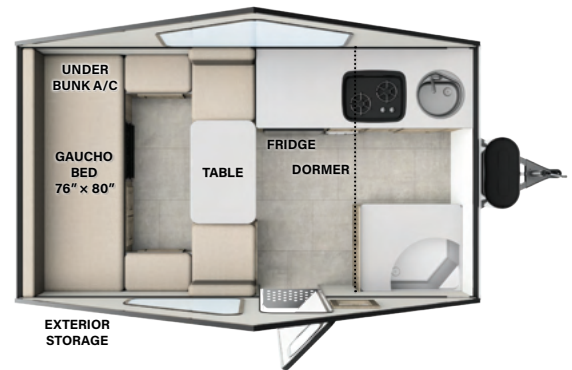

A213HS

UVW: 2728 lb

CCC: 577 lb

Hitch Weight: 305 lb

Closed Length: 20' 4"

Exterior Length: 20' 4"

Closed Height: 5' 8"

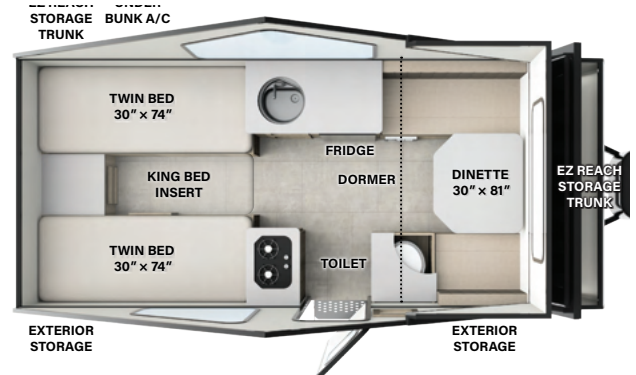

A216HS NEW

UVW: 2523 lb

CCC: 767 lb

Hitch Weight: 290 lb

Closed Length: 18' 5"

Exterior Length: 18' 5"

Closed Height: 5' 8"

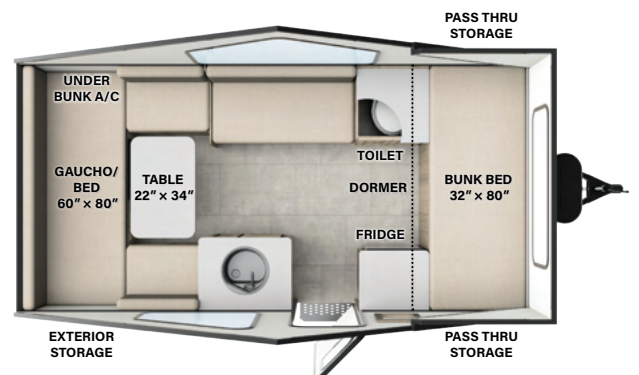

THE ROCKWOOD PROMISE

Rockwood stands behind its craftsmanship with unwavering commitment from start to finish. When you choose Rockwood, you're choosing an RV backed by our comprehensive limited warranties. For complete details, please consult the written warranty or your Rockwood dealer.

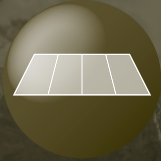

**FIVE YEAR
ROOFING
WARRANTY**

(Excludes Hardside)



**TWENTY FIVE
YEAR FLOORING
WARRANTY**



**TEN YEAR
TORFLEX® AXLE
WARRANTY**

(Hardside Only)



**FIVE YEAR
FRAME
WARRANTY**



**FIVE YEAR
TENTING
WARRANTY**



**LIMITED LIFETIME
LIFTER SYSTEM
WARRANTY**

(Excludes Hardside)

**MILLERSBURG
MADE**

The story of Rockwood is deeply intertwined with the town of Millersburg, Indiana. Here, generations of families have contributed to the creation of RVs known for their reliability and lasting value. "Millersburg Made" signifies a commitment to community and a dedication to building RVs you can trust. It's the assurance that your Rockwood has been built with care, by people who take pride in their work and stand behind every RV that leaves our doors.

EACH NEW FOREST RIVER PURCHASE PROVIDES:

- ✓ Pre-delivery Inspection.
- ✓ Digital Owner's Manual.
- ✓ Free Membership to Forest River Owners Group (FROG).
Learn more at www.forestriverfrog.com.
- ✓ A Contribution to Care Camps Foundation www.carecamps.org.
- ✓ 1 Year Free Roadside Assistance from Date of Purchase.



LEARN MORE:

Scan this QR code with your mobile device to learn more about Forest River.



SPECIFICATION DEFINITIONS:

Scan this barcode using a QR reader on your smartphone to learn RV terminology and more!



YOUR **ROCKWOOD** DEALER

All information contained in this brochure is believed to be accurate at the time of publication. However, during any model year, it may be necessary to make changes to the manufacturing process of the units and information in this brochure. Your unit may differ from the information in this brochure due to any changes in the manufacturing process and equipment. Forest River, Inc., reserves the right to make all such changes without notice, including prices, colors, combinations, materials, equipment and specifications of any model as well as the addition of new models and the discontinuance of models shown in this brochure. Therefore, please consult with your Forest River dealer and confirm the availability of any materials, combinations, designs, or specifications that are meaningful to your purchase decision. © 2025 Rockwood, a Division of Forest River, Inc., a Berkshire Hathaway Company. All Rights Reserved. Forest River, Inc. 09/25